

REQUEST FOR LEGISLATIVE ACTION

Completed by County Counselor's Office:

Res/Ord No.: 19643

Sponsor(s): Greg Grounds

Date: November 13, 2017

<p>SUBJECT</p>	<p>Action Requested <input checked="" type="checkbox"/> Resolution <input type="checkbox"/> Ordinance</p> <p>Project/Title: <u>Approving the conveyance of two parcels from the Jackson County Land Trust to Jackson County for less than two-thirds of the appraised value for the development of the Rock Island Rail Corridor.</u></p>										
<p>BUDGET INFORMATION <i>To be completed By Requesting Department and Finance</i></p>	<table border="1"> <tr> <td>Amount authorized by this legislation this fiscal year:</td> <td>\$0</td> </tr> <tr> <td>Amount previously authorized this fiscal year:</td> <td>\$0</td> </tr> <tr> <td>Total amount authorized after this legislative action:</td> <td>\$0</td> </tr> <tr> <td>Amount budgeted for this item * (including transfers):</td> <td>\$0</td> </tr> <tr> <td>Source of funding (name of fund) and account code number; FROM / TO</td> <td>FROM ACCT: N/A TO ACCT: N/A</td> </tr> </table> <p>* If account includes additional funds for other expenses, total budgeted in the account is: \$</p> <p>OTHER FINANCIAL INFORMATION:</p> <p><input checked="" type="checkbox"/> No budget impact (no fiscal note required) <input type="checkbox"/> Term and Supply Contract (funds approved in the annual budget); estimated value and use of contract: Department: Estimated Use: \$</p> <p>Prior Year Budget (if applicable): N/A Prior Year Actual Amount Spent (if applicable): N/A</p>	Amount authorized by this legislation this fiscal year:	\$0	Amount previously authorized this fiscal year:	\$0	Total amount authorized after this legislative action:	\$0	Amount budgeted for this item * (including transfers):	\$0	Source of funding (name of fund) and account code number; FROM / TO	FROM ACCT: N/A TO ACCT: N/A
Amount authorized by this legislation this fiscal year:	\$0										
Amount previously authorized this fiscal year:	\$0										
Total amount authorized after this legislative action:	\$0										
Amount budgeted for this item * (including transfers):	\$0										
Source of funding (name of fund) and account code number; FROM / TO	FROM ACCT: N/A TO ACCT: N/A										
<p>PRIOR LEGISLATION</p>	<p>Prior ordinances and (date): N/A</p> <p>Prior resolutions and (date): N/A</p>										
<p>CONTACT INFORMATION</p>	<p>RLA drafted by (name, title, & phone): Matt Davis, Project Coordinator RIRCA 816-503-4849</p>										
<p>REQUEST SUMMARY</p>	<p>This action would approve the conveyance of title for two parcels from the Jackson County Land Trust to Jackson County for less than two-thirds the appraised value. These parcels are directly adjacent to the Rock Island Rail Corridor and would be used for development of the Corridor. One parcel is necessary for path construction, the other parcel would be held for future use. Each parcel is vacant.</p>										
<p>CLEARANCE</p>	<p><input type="checkbox"/> Tax Clearance Completed (Purchasing & Department) <input type="checkbox"/> Business License Verified (Purchasing & Department) <input type="checkbox"/> Chapter 6 Compliance - Affirmative Action/Prevailing Wage (County Auditor's Office)</p>										

ATTACHMENTS	Property Reports for each parcel pulled from Jackson County Parcel Viewer.	
REVIEW	Department Director: <i>[Signature]</i>	Date: 10/27/17
	Finance (Budget Approval): <i>If applicable</i>	Date:
	Division Manager: <i>[Signature]</i>	Date: 11/10/17
	County Counselor's Office:	Date:

Fiscal Information (to be verified by Budget Office in Finance Department)

- This expenditure was included in the annual budget.
- Funds for this were encumbered from the _____ Fund in ____.
- There is a balance otherwise unencumbered to the credit of the appropriation to which the expenditure is chargeable and there is a cash balance otherwise unencumbered in the treasury to the credit of the fund from which payment is to be made each sufficient to provide for the obligation herein authorized.
- Funds sufficient for this expenditure will be/were appropriated by Ordinance #
- Funds sufficient for this appropriation are available from the source indicated below.

Account Number:	Account Title:	Amount Not to Exceed:

- This award is made on a need basis and does not obligate Jackson County to pay any specific amount. The availability of funds for specific purchases will, of necessity, be determined as each using agency places its order.
- This legislative action does not impact the County financially and does not require Finance/Budget approval.

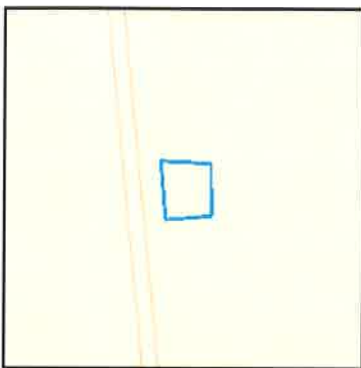

Property Information

**Parcel ID:** 45-210-09-02-00-0-00-000**Address on this Parcel:**5909 RAYTOWN TFWY
RAYTOWN, MO 64133**Owner Information:**LAND TRUST OF JACKSON COUNTY MISSOURI
4035 CENTRAL ST
KANSAS CITY, MO 64111-2207**Mortgage Holder Information:**

No Mortgage Holder Information.

Property Characteristics:Year Built: NA
Living Area (Approx. sq. ft.): NA
Tax Neighborhood Code: 9823
Parcel Area (Approx.): 0.09 (acres), 4,056.13 (SqFt)**Property Class (PCA Code):** Commercial Vacant Land (code: 2000)**Land Use Type:** Unimproved Commercial Land (code: 2101)**Tax Code Area:**Code: 22
City: Raytown
Fire: Raytown F2
Library: Mid Continent
School: Raytown C-2
Water: NA**Assessment Information:**Tax Year: 2017
Market Value: \$12,936
Assessed Value: \$4,140
Taxable Value: \$0
[Where are my tax dollars going?](#)**Exemptions and Abatements Status (2016):**

1) Description: E04 - E04 (land trust), Land Trust

Community Improvement District (CID):

Property is not in a CID for which Jackson County collects a tax or assessment.

TIF Information:

Property is not in a TIF Plan area or TIF Project area known to Jackson County.

Property Tax Account Summary

Parcel Number 45-210-09-02-00-0-00-000 Property Address 5909 RAYTOWN TFWY , RAYTOWN, MO 64133

General Information

Property Description RNG-32 TWP-48 SEC-05 BEG 512.3' S & 255' E OF NW COR NE 1/4 NE 1/4 OF SD SEC TH E 57.58' TH SELY ALG RR R/W 62.82' TH W 54.50' TH N 67.74' TO POB.
 Property Category Land and Improvements
 Status Active, Host Other Property, Locally Assessed
 Tax Code Area 022

Property Characteristics

Property Class 2000

Parties
 Role PercentName Address
 Taxpayer 100 LAND TRUST OF JACKSON COUNTY MISSOURI C/O ATTN: LAND COMMISSIONER, 4035 CENTRAL ST, KANSAS CITY, MO 64111-2207
 Owner 100 LAND TRUST OF JACKSON COUNTY MISSOURI C/O ATTN: LAND COMMISSIONER, 4035 CENTRAL ST, KANSAS CITY, MO 64111-2207

Property Values

Value Type	Tax Year 2017	Tax Year 2016	Tax Year 2015	Tax Year 2014	Tax Year 2013
Market Value Total	12,936	9,951	9,951	9,951	9,951
Taxable Value Total	0	0	0	0	0
Assessed Value Total	4,140	3,184	3,184	3,184	3,184

Active Exemptions

E04 (land trust)

No Charges are currently due.

No Charge Amounts are currently due for this property. If you believe this is incorrect, please contact the Taxpayer Services Unit at (816) 881-3232.

NOTICE: Telephones are staffed during regular business hours (8am to 5pm, Monday through Friday, excluding holidays observed by Jackson County).

Receipts

Date	Receipt No.	Amount Applied	Amount Due	Tendered	Change
No Events Found					

REMINDER: Occasionally, the parcel number for a real estate parcel changes, due to a parcel segregation or merge. In such a case, a search of the new parcel number may not reflect tax delinquency or a full tax history concerning that parcel. You may wish to contact us to obtain that information. Or, you may wish to search all relevant parcel numbers of parcels involved in such a segregation or merge. [Click here](#) to begin a search on this website to see if a parcel was involved in a segregation or merge occurring within the past five years and to see a list of parent parcel(s) and child parcel(s) involved. **NOTE:** Information concerning a segregation or merge occurring more than five years prior to the search is not available on this website.

ATTENTION: This website will close at 11:00 p.m. on December 31. Taxes paid online after the website reopens in the New Year will accrue interest, penalties and fees.

Content in Property Account Summary Developed by Manatron, Inc.
 @2005-2010 All rights reserved.
 Version 1.0.5228.20119

Disclaimer: The information contained in this website is provided to the recipient pursuant to Section 610.011, RSMo. Jackson County makes no warranties or representations of any kind, express or implied, regarding the information, data, or images provided herein. All information, data, and service are provided "as is," and "with all faults" and by accessing this website, the recipient accepts the risk of any errors or omissions. Jackson County is not liable in any way to the users of information, data or service provided herein. By accessing and using this information, data or service you agree to hold the County harmless in all matters and accounts arising from the use or reliance on the completeness or accuracy of this information, data or service.

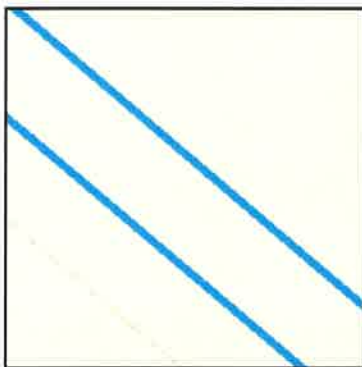

Property Information

**Parcel ID:** 61-800-03-06-00-0-00-000**Address on this Parcel:**NO ADDRESS ASSIGNED BY CITY
LEE'S SUMMIT, MO 64082**Owner Information:**LAND TRUST OF JACKSON COUNTY MISSOURI
4035 CENTRAL ST
KANSAS CITY, MO 64111-2207**Mortgage Holder Information:**

No Mortgage Holder Information.

Property Characteristics:Year Built: NA
Living Area (Approx. sq. ft.): NA
Tax Neighborhood Code: 4889
Parcel Area (Approx.): 0.45 (acres), 19,830.83 (SqFt)**Property Class (PCA Code):** Agriculture/Horticulture Vacant Land (code: 4000)**Land Use Type:** (code: 4100)**Tax Code Area:**Code: 49
City: Lee's Summit
Fire: NA
Library: Mid Continent
School: Lees Summit R-7
Water: NA**Assessment Information:**Tax Year: 2017
Market Value: \$291
Assessed Value: \$35
Taxable Value: \$0[Where are my tax dollars going?](#)**Exemptions and Abatements Status (2016):**

1) Description: E04 - E04 (land trust), Land Trust

Community Improvement District (CID):

Property is not in a CID for which Jackson County collects a tax or assessment.

TIF Information:

Property is not in a TIF Plan area or TIF Project area known to Jackson County.

Property Tax Account Summary

Parcel Number 61-800-03-06-00-0-00-000 Property Address NO ADDRESS ASSIGNED BY CITY , LEES SUMMIT, MO 64082

General Information

Property Description RNG-31 TWP-47 SEC-17 PT OF SE 1/4 OF SW 1/4 DAF: BEG AT NW COR OF SW 1/4 TH E ALG N LI SD 1/4 1258.7' TH S 1449.91' TO A PT ON A LI 50' NELY & PARA TO C/L OF RR TH S 49 DEG E ALG SD PARA LI 129.34' TO TRU POB TH N 63.1' TO RR CO'S NELY R/W LI TH S 49' DEG E ALG SD NELY R/W LI 528' M/L TO NE COR SD R/W TH SWLY 50' TO PT ON LI 50' NELY & PARA TO C/L RR TH N 49 DEG W 493' MOL TO TRU POB (EX PT IN ST)

Property Category Land and Improvements
 Status Active, Locally Assessed
 Tax Code Area 049

Property Characteristics

Property Class 4000

Parties	Role	PercentName	Address
Taxpayer	100	LAND TRUST OF JACKSON COUNTY MISSOURI	C/O ATTN: LAND COMMISSIONER, 4035 CENTRAL ST, KANSAS CITY, MO 64111-2207
Owner	100	LAND TRUST OF JACKSON COUNTY MISSOURI	C/O ATTN: LAND COMMISSIONER, 4035 CENTRAL ST, KANSAS CITY, MO 64111-2207

Property Values

Value Type	Tax Year 2017	Tax Year 2016	Tax Year 2015	Tax Year 2014	Tax Year 2013
Market Value Total	291	291	291	277	277
Taxable Value Total	0	0	0	0	0
Assessed Value Total	35	35	35	33	33

Active Exemptions

E04 (land trust)

No Charges are currently due.

No Charge Amounts are currently due for this property. If you believe this is incorrect, please contact the Taxpayer Services Unit at (816) 881-3232.

NOTICE: Telephones are staffed during regular business hours (8am to 5pm, Monday through Friday, excluding holidays observed by Jackson County).

Receipts

Date	Receipt No.	Amount Applied	Amount Due	Tendered	Change
No Events Found					

REMINDER: Occasionally, the parcel number for a real estate parcel changes, due to a parcel segregation or merge. In such a case, a search of the new parcel number may not reflect tax delinquency or a full tax history concerning that parcel. You may wish to contact us to obtain that information. Or, you may wish to search all relevant parcel numbers of parcels involved in such a segregation or merge. [Click here](#) to begin a search on this website to see if a parcel was involved in a segregation or merge occurring within the past five years and to see a list of parent parcel(s) and child parcel(s) involved. **NOTE:** Information concerning a segregation or merge occurring more than five years prior to the search is not available on this website.

ATTENTION: This website will close at 11:00 p.m. on December 31. Taxes paid online after the website reopens in the New Year will accrue interest, penalties and fees.

Content in Property Account Summary Developed by Manatron, Inc.
 ©2005-2010 All rights reserved.
 Version 1.0.5228.20119

Disclaimer: The information contained in this website is provided to the recipient pursuant to Section 610.011, RSMo. Jackson County makes no warranties or representations of any kind, express or implied, regarding the information, data, or images provided herein. All information, data, and service are provided "as is," and "with all faults" and by accessing this website, the recipient accepts the risk of any errors or omissions. Jackson County is not liable in any way to the users of information, data or service provided herein. By accessing and using this information, data or service you agree to hold the County harmless in all matters and accounts arising from the use or reliance on the completeness or accuracy of this information, data or service.