

IN THE COUNTY LEGISLATURE OF JACKSON COUNTY, MISSOURI

A RESOLUTION authorizing the County Executive to execute a License Agreement with the City of Raytown, Missouri, for Rock Island Corridor improvements within the City of Raytown's right-of-way.

RESOLUTION NO. 19931, July 30, 2018

INTRODUCED BY Dennis Waits, County Legislator

WHEREAS, the Rock Island Rail Corridor Authority is requesting a License Agreement with the City of Raytown, Missouri, for its right-of-way improvements; and,

WHEREAS, these right-of-ways are located at 53rd Street, 56th Street, the intersection of 59th and Raytown Trafficway, Raytown Trafficway from 59th Street to approximately 63rd Street, the Wooden Bridge crossing, Rock Island Corridor Row, and Woodson Road; and,

WHEREAS, the approval of the attached License Agreement is in the best interest of the health, safety and welfare of the citizens of Jackson County; now therefore,

BE IT RESOLVED by the County Legislature of Jackson County, Missouri, that the County Executive be and hereby is authorized to execute the attached License Agreement with the City of Raytown, Missouri, and any other documents necessary to give effect to this Resolution.

Effective Date: This Resolution shall be effective immediately upon its passage by a majority of the Legislature.

APPROVED AS TO FORM:

Chief Deputy County Counselor

County Counselor

Certificate of Passage

I hereby certify that the attached resolution, Resolution No. 19931 of July 30, 2018, was duly passed on August 6, 2018 by the Jackson County Legislature. The votes thereon were as follows:

Yeas 8

Nays 0

Abstaining 0

Absent 0

Excused 1

8-6-18
Date

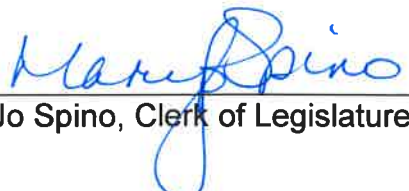
Mary Jo Spino, Clerk of Legislature

LICENSE AGREEMENT

THIS LICENSE AGREEMENT, made this _____ day of _____, 20__, by and between the City of Raytown, Missouri (hereinafter called "City"), and Jackson County, Missouri (hereinafter called "Licensee").

WITNESSETH:

WHEREAS, City owns Right of Way or Real Property, described in paragraph 1 below, and the City desires to license to Licensee and the Licensee desires to license from the City a portion of the Right of Way or Real Property ("Licensed Premises") for the construction and maintenance of the Rock Island Corridor Shared Use Path ("Improvements"); and

WHEREAS, Licensee owns an existing rail corridor right of way (the "Rock Island Corridor Right of Way") intersecting numerous City streets; and

WHEREAS, Licensee is a "common carrier" under 49 U.S.C. 11101 subject to the jurisdiction of the Surface Transportation Board; and

WHEREAS, Licensee plans to expend significant funds to construct a shared use path for transportation, recreation, health, and economic betterment of the City of Raytown;

NOW, THEREFORE, City, in consideration of the obligations hereby assumed by Licensee, hereby licenses and authorizes Licensee, its officers, members, contractors, agents, and guests, to enter and go upon the Licensed Premises, at all times during the continuance of this Agreement, and there to use and enjoy the Licensed Premises for the Improvements, subject to the following:

1. **LICENSED PREMISES AND IMPROVEMENTS FURTHER DESCRIBED.** The Licensed Premises shall include: the intersection of 59th Street and Raytown Road, including an existing traffic signal and cameras, proposed crosswalks and ADA ramps, and the proposed shared use path and connections to existing sidewalks; a portion of the Right of Way along Raytown Trafficway from 59th Street to approximately 63rd Street; the Raytown Road Wooden Bridge as it crosses the Rock Island Corridor Right of Way. City acknowledges that Licensee will also construct at-grade bicycle and pedestrian crossings on Licensee's property at 53rd Street, 56th Street, and Woodson Road and construct a pedestrian underpass at 63rd Street and a pedestrian overpass on an existing rail bridge at 67th Street. Licensee may also install advance warning signs on City Right of Way at 53rd Street, 56th Street, and Woodson Road. Said Improvements on the Licensed Premises may be viewed in greater detail in "Exhibit A".

2. **USE OF LICENSED PREMISES.** Licensee, its officers, members, contractors, agents and guests shall have the right to use the Licensed Premises solely for the construction and maintenance of the Improvements. The Improvements on the Licensed Premises shall comply with all ordinances of the City and are subject to approval of the City.

3. **RESTRICTION ON MODIFICATIONS AND IMPROVEMENTS.** Except as specifically allowed by paragraph 2, Licensee, its officers, members, contractors, agents, and guests are prohibited from making any addition, modification or improvement to any part of the Licensed Premises, and are prohibited from placing, affixing or constructing any structure, utility, signage or markings on the Licensed Premises.

4. **MAINTENANCE.** Licensee agrees to maintain, at its sole cost, the Improvements to the Licensed Premises, at all times during the continuation of this Agreement, except that the City shall continue to own and maintain, at its sole cost, (1) the traffic signal at 59th Street and Raytown Trafficway, (2) the northwestern and southwestern ADA ramps at 59th Street and Raytown Trafficway, and (3) the Raytown Road Wooden Bridge. The City may as a part of its typical pavement maintenance program also maintain or re-apply pavement markings within the Licensed Premises.

5. **RESTRICTION AS TO WASTE.** Licensee shall not, except so far as may be reasonably necessary for the maintenance of the Improvements on the Licensed Premises and the Licensed Premises as aforesaid, commit or permit any waste thereon, and in particular Licensee shall not without the permission in writing of City cut down or destroy or injure any bushes or trees. Licensee shall be liable for any damage done to the Licensed Premises, except as is permitted by this Agreement, by any persons entering upon the Licensed Premises on behalf of Licensee pursuant to the terms of this Agreement.

6. **REVOCACTION.** Notwithstanding any provision of this Agreement to the contrary, City may terminate this Agreement and revoke the license hereby granted as to all or any part of the Licensed Premises at any time upon sixty (60) days advance notice in writing, provided, however, no advance notice is required if Licensee shall break any of the conditions or obligations herein contained. Licensee may terminate this Agreement at any time upon sixty (60) days advance notice in writing. No such termination by Licensee shall negate any rights or obligations of the parties accrued through the date of such termination. In the event of the termination of this Agreement, the Licensee shall remove, at its sole expense, the Improvements from the Licensed Premises.

7. **CONSTRUCTION OF AGREEMENT.**

A. **SIMPLE LICENSE.** The license created by this Agreement shall be construed as a simple license (sometimes referred to as a "bare," "mere" or "naked" license) revocable at the will of the City, subject only to any advance written notice of revocation required by paragraph 6.

B. **HEADINGS.** The paragraph headings contained herein are for convenience in reference and are not intended to define or limit the scope of any provision of this Agreement.

C. **NON-WAIVER.** No waiver of any condition or covenant contained in this Agreement or any breach thereof shall be taken to constitute a waiver of any subsequent condition, covenant or breach.

D. **JOINTLY DRAFTED.** This Agreement shall be deemed to have been jointly drafted by the parties and shall not be construed more strongly against any party hereto.

E. **APPLICABLE LAW.** This instrument shall be construed in accordance with the laws of the State of Missouri.

8. **UNASSIGNABLE.** The license created by this Agreement is solely for Licensee, its officers, members, servants, agents and guests and no others. Neither the license nor this

Agreement, in whole or part, is assignable, except that at the request of Licensee, the City will consider assigning this Agreement to a homes association.

9. NOTICE. Whenever any notice is required by this Agreement to be made, given or transmitted to the City, it shall be enclosed in an envelope with sufficient postage attached to ensure delivery and deposited in the United States Mail, first class, addressed to:

City Administrator
City of Raytown
10000 E. 59th Street
Raytown, MO 64133

and notices to Licensee shall be addressed to:

County Counselor
Office of the County Counselor
Jackson County Courthouse
415 E. 12th Street, Suite 200
Kansas City, MO 64106

or such place as either party shall designate by written notice to the other. Said notices may also be personally hand delivered by each party to the other, at the respective addresses listed above. If hand delivered, the date of actual completion of delivery shall be considered the date of receipt. If mailed, the item shall be considered received the third day after the date of mailing.

10. ENTIRE AGREEMENT. This Agreement constitutes the entire Agreement between the parties hereunder and all other representations of statements heretofore made, verbal or written, are merged herein and this Agreement may be amended only in writing, and executed by duly authorized representatives of the parties hereto.

IN WITNESS WHEREOF, the parties hereto have caused this instrument to be executed as of the date first above mentioned at Raytown, Missouri.

CITY OF RAYTOWN, MISSOURI

Mayor Mike McDonough

ATTEST:

City Clerk Teresa Henry

APPROVED AS TO FORM:

JACKSON COUNTY, MISSOURI

County Executive Frank White, Jr.

ATTEST:

Mary Jo Spino, Clerk of the Legislature

APPROVED AS TO FORM:

County Counselor

Exhibit A: 59th Street and Raytown Road Crosswalks and ADA Improvements

R. 19931

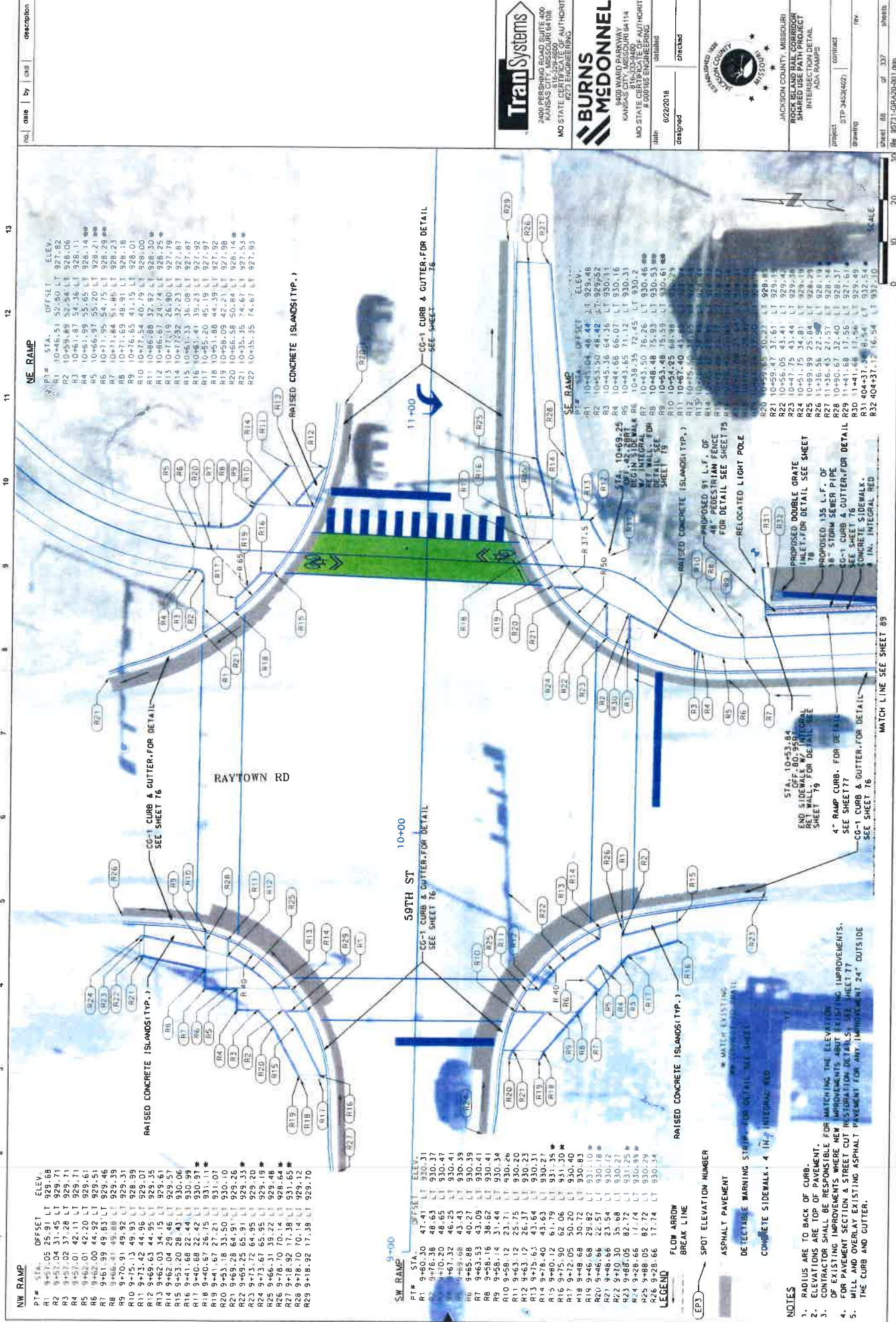

TranSystems
2400 PERSHING ROAD SUITE 400
KANSAAS CITY, MISSOURI 64108
MO STATE CERTIFICATE OF AUTHORITY
#273 ENGINEERING

BURNS MEDONNELL
8400 WARD PARKWAY
KANSAAS CITY, MISSOURI 64114
MO STATE CERTIFICATE OF AUTHORITY
#000185 ENGINEERING

Date: 0/22/2018
Designed: _____
Checked: _____

JACKSON COUNTY, MISSOURI
SHAWNEE PLAZA PROJECT
INTERSECTION DETAIL
ADA RAMP

Project: STP 943(402) - OFFICE
Drawing: _____ Rev: _____

Sheet: 88 of 337
File: 8573-GRAD-001.dwg

Exhibit A: 59th Street and Raytown Road Traffic Signal Improvements

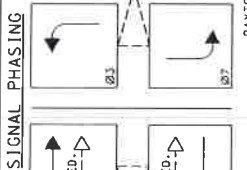
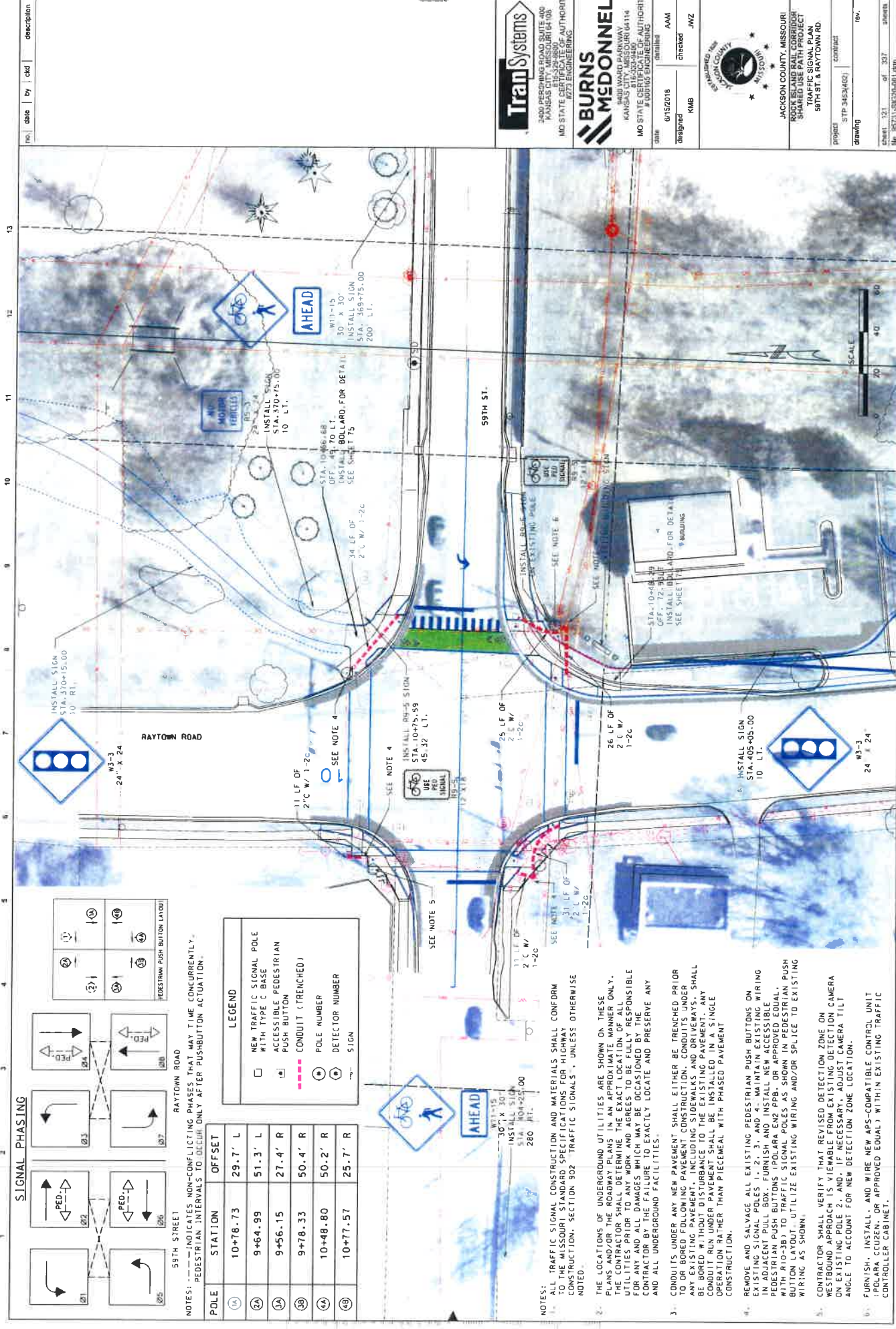

59TH STREET

POLE	STATION	OFFSET
①	10+78.73	29.7' L
②	9+64.99	51.3' L
③	9+56.15	27.4' R
④	9+78.33	50.4' R
④	10+48.80	50.2' R
④	10+77.57	25.7' R

RAYTOWN ROAD

POLE	STATION	OFFSET
⑤	24+24.24	0' L
⑥	45+42.15	0' L
⑦	72+05.00	0' L
⑧	104+05.00	0' L
⑨	108+68.68	70' L
⑩	137+75.00	0' L
⑪	166+75.00	0' L
⑫	195+00.00	0' L

LEGEND

- NEW TRAFFIC SIGNAL POLE WITH TYPE C BASE
- ⊙ ACCESSIBLE PEDESTRIAN PUSH BUTTON
- CONDUIT (TRENCHED)
- ⊙ POLE NUMBER
- ⊙ DETECTOR NUMBER
- ⊙ SIGN

NOTES: --- INDICATES NON-CONFLICTING PHASES THAT MAY TIME CONCURRENTLY. PEDESTRIAN INTERVALS TO BEGIN ONLY AFTER PUSHBUTTON ACTUATION.

- ALL TRAFFIC SIGNAL CONSTRUCTION AND MATERIALS SHALL CONFORM TO THE MISSOURI STANDARD SPECIFICATIONS FOR HIGHWAY CONSTRUCTION, SECTION 902 TRAFFIC SIGNALS, UNLESS OTHERWISE NOTED.
- THE LOCATIONS OF UNDERGROUND UTILITIES ARE SHOWN ON THESE PLANS. THE CONTRACTOR SHALL VERIFY THE APPROXIMATE DEPTHS AND UTILITIES PRIOR TO ANY WORK AND AGREE TO BE FULLY RESPONSIBLE FOR ANY AND ALL DAMAGES WHICH MAY BE OCCASIONED BY THE CONTRACTOR BY THE FAILURE TO EXACTLY LOCATE AND PRESERVE ANY AND ALL UNDERGROUND FACILITIES.
- CONDUITS UNDER ANY NEW PAVEMENT SHALL EITHER BE TRENCHED PRIOR TO OR BORED FOLLOWING THE PAVEMENT. ALL CONDUITS AND WIRING SHALL BE BORED WITHOUT DISTURBANCE TO THE EXISTING PAVEMENT. ANY CONDUIT RUN UNDER PAVEMENT SHALL BE INSTALLED IN A SINGLE OPERATION RATHER THAN PIECEMEAL WITH PHASED PAVEMENT CONSTRUCTION.
- REMOVE AND SALVAGE ALL EXISTING PEDESTRIAN PUSH BUTTONS ON EXISTING SIGNAL POLES 1, 2, 3, AND 4. MAINTAIN EXISTING WIRING IN ADJACENT PULL BOX. FURNISH AND INSTALL NEW ACCESSIBLE PEDESTRIAN PUSH BUTTONS (POLARA EN2 FPB, OR APPROVED EQUAL WITH R10-3B) TO TRAFFIC SIGNAL POLES AS SHOWN IN PEDESTRIAN PUSH BUTTON LAYOUT. UTILIZE EXISTING WIRING AND/OR SPLICE TO EXISTING WIRING AS SHOWN.
- CONTRACTOR SHALL VERIFY THAT REVISED DETECTION ZONE ON WESTBOUND APPROACH IS VIEWABLE FROM EXISTING DETECTION CAMERA ON EXISTING POLE 2. AND, IF NECESSARY, ADJUST CAMERA TILT ANGLE TO ACCOUNT FOR NEW DETECTION ZONE LOCATION.
- FURNISH, INSTALL, AND WIRE NEW APS-COMPATIBLE CONTROL UNIT (EQUIPPED WITH APPROVED EQUAL) WITHIN EXISTING TRAFFIC CONTROLLER CABINET.

3400 PERSHING ROAD SUITE 400
KANSAS CITY, MISSOURI 64108
MO STATE CERTIFICATE OF AUTHORITY
#773 ENGINEERING

455 WEST WASHINGTON BLVD
KANSAS CITY, MISSOURI 64114
MO STATE CERTIFICATE OF AUTHORITY
#16003 ENGINEERING

date	6/15/2018	checked	AAM
designed	KMB	checked	JWZ

project: STP-343(400) contract:
drawing:
sheet: 121 of 307 sheets
file: 9273-31020-001.dgn

no.	date	by	ctd	description

Exhibit A: Shared Use Path Improvements along Raytown Trafficway ROW

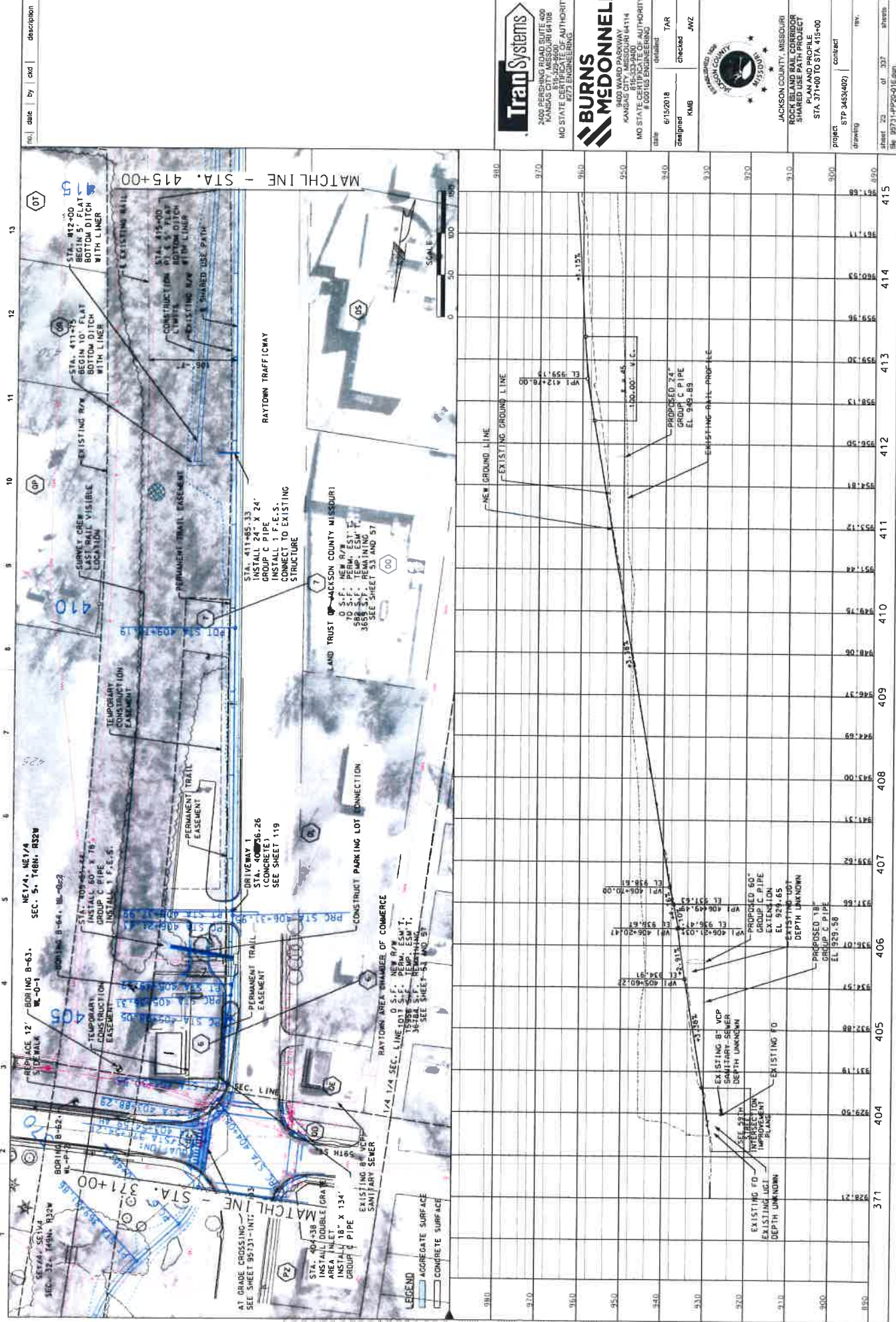

no.	date	by	chkd	description

date	6/15/2018	TAR	initial
designed	KMB	checked	JWZ

project	STP 3453(402)	contract	
sheet	23	of	307 sheets
file	B5731-PP25-01E.dwg		

company	TRAN SYSTEMS
address	2400 PERSHING ROAD SUITE 400 KANAS CITY, MISSOURI 64108
phone	816.433.9100
fax	816.433.9101
email	MO STATE CERTIFICATE OF AUTHORITY #277 ENGINEERING

company	BURNS & MCDONNELL
address	9803 WARD PASSWAY KANASAS CITY, MISSOURI 64114
phone	816.433.9100
fax	816.433.9101
email	MO STATE CERTIFICATE OF AUTHORITY #000152 ENGINEERING

project	JACKSON COUNTY MISSOURI SHARED USE PATH PROJECT PLAN AND PROFILE STA. 371+00 TO STA. 415+00
---------	--

Exhibit A: Shared Use Path Improvements along Raytown Trafficway ROW

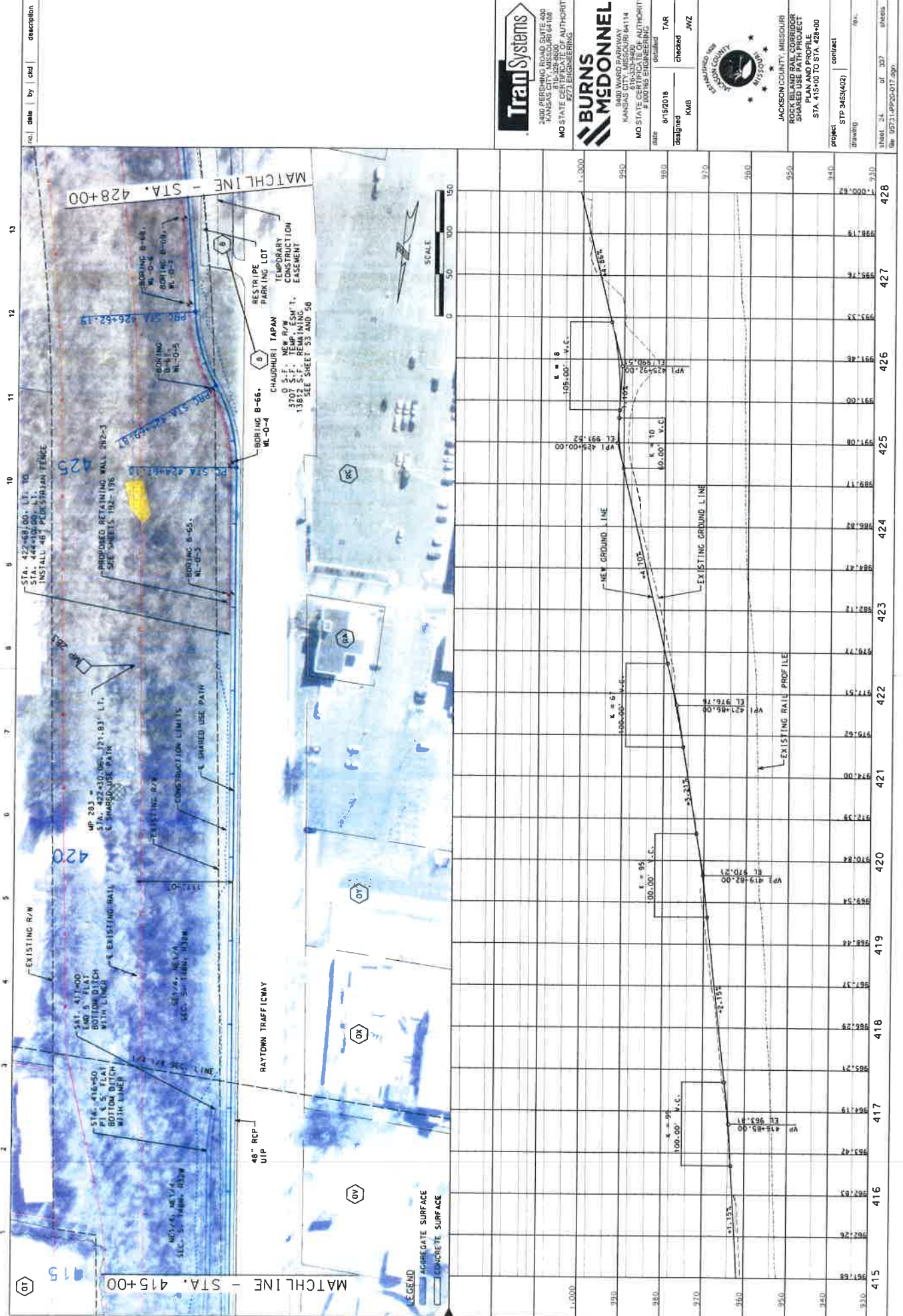

3400 BERKING ROAD, SUITE 400
 KANSAS CITY, MISSOURI 64118
 MO STATE CERTIFICATE OF AUTHORITY #192-2018-0001

3400 WARD PARKWAY
 KANSAS CITY, MISSOURI 64114
 MO STATE CERTIFICATE OF AUTHORITY #192-2018-0001

JACKSON COUNTY, MISSOURI
 ROCK ISLAND RAIL CORRIDOR
 SHARED USE PATH PROJECT
 PLAN AND PROFILE
 STA. 415+00 TO STA. 428+00

DATE: 6/19/2018
 DESIGNED: KMB
 CHECKED: JWB
 PROJECT: STP 3483(402)
 DRAWING: 001

SHEET: 24 OF 307 SHEETS
 DIM: 05714PP03-017.dwg

Exhibit A: Raytown Road Wooden Bridge Modifications and Shared Use Path Underpass

12 11 10 9 8 7 6 5 4 3 2 1

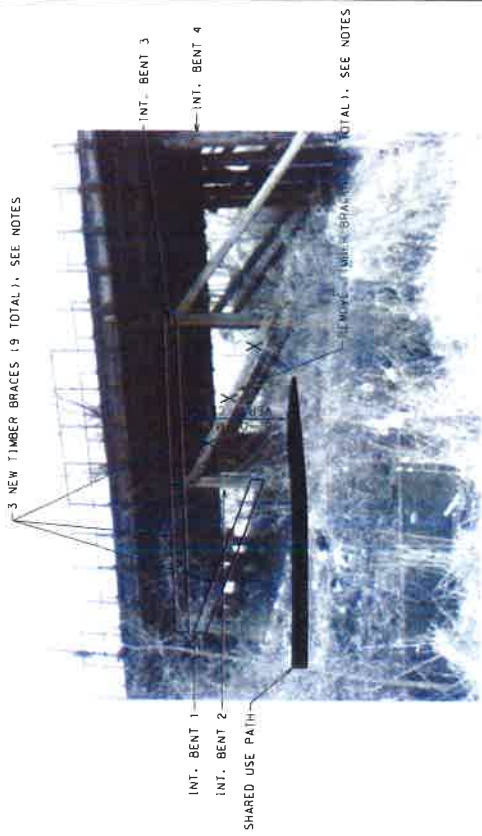

PART ELEVATION OF EXISTING TIMBER BEAM STRUCTURE
(LOOKING WEST)

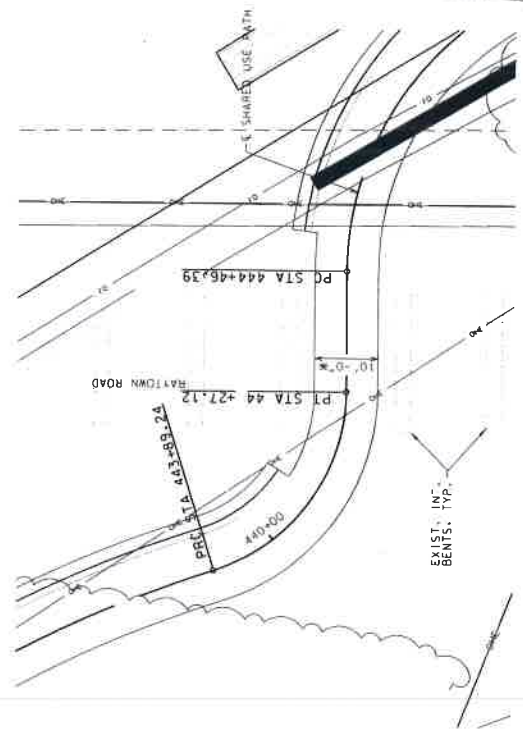

PLAN
* SHARED USE PATH

TranSystems
2400 PERSHING ROAD SUITE 400
KANSAS CITY, MISSOURI 64110
MO STATE CERTIFICATE OF AUTHORITY
000105 ENGINEERING
2/23 ENGINEERING

BURNS MEDONNELL
1400 WARD PARKWAY
KANSAS CITY, MISSOURI 64114
MO STATE CERTIFICATE OF AUTHORITY
000105 ENGINEERING

DATE: 6/18/2018
DESIGNED: REP
CHECKED: REP
PROJECT: STP 3453(402)

JACKSON COUNTY, MISSOURI
ROCK ISLAND RAIL CORRIDOR
SHARED USE PATH PROJECT
RAYTOWN ROAD BRIDGE
GENERAL PLAN AND ELEVATION

ESTIMATED QUANTITIES STA. 444+31.52

ITEM	QUANTITY
TIMBER BRACING	EACH
	9

NOTES:
TIMBER USED FOR THE NEW BRACING SHALL BE ROUGH-SAWN LUMBER TO THE REQUIREMENTS OF ASTM A307. THE BOLTS AND LAG SCREWS SHALL BE ASHTO FOR DRUGS FOR THE ARCHITECTURAL AND GRADING REQUIREMENTS OF ASHTO. ALL BOLTS, LAG SCREWS, NUTS, WASHERS, ETC. SHALL BE SIZED TO MEET OR EXCEED EXISTING. ALL BOLTS, LAG SCREWS, NUTS, WASHERS, ETC. SHALL BE SIZED TO MEET OR EXCEED EXISTING.
THE CONTRACTOR SHALL MEASURE THE DISTANCE BETWEEN BENTS 1, 2 & 3 COLUMNS BEFORE ORDERING OR FABRICATING ANY MATERIALS. TIMBER BRACING SHALL BE REPLACED. DO NOT REMOVE EXISTING TIMBERS.
INSTALL 3 NEW DIAGONAL TIMBER BRACES BETWEEN BENTS 1 & 2 PRIOR TO REMOVING TIMBER BRACING BETWEEN BENTS 2 & 3.

sheet 108 of 337 sheets
file: 95734-RDR-CR1

Exhibit A: 53rd Street At-Grade Crossing

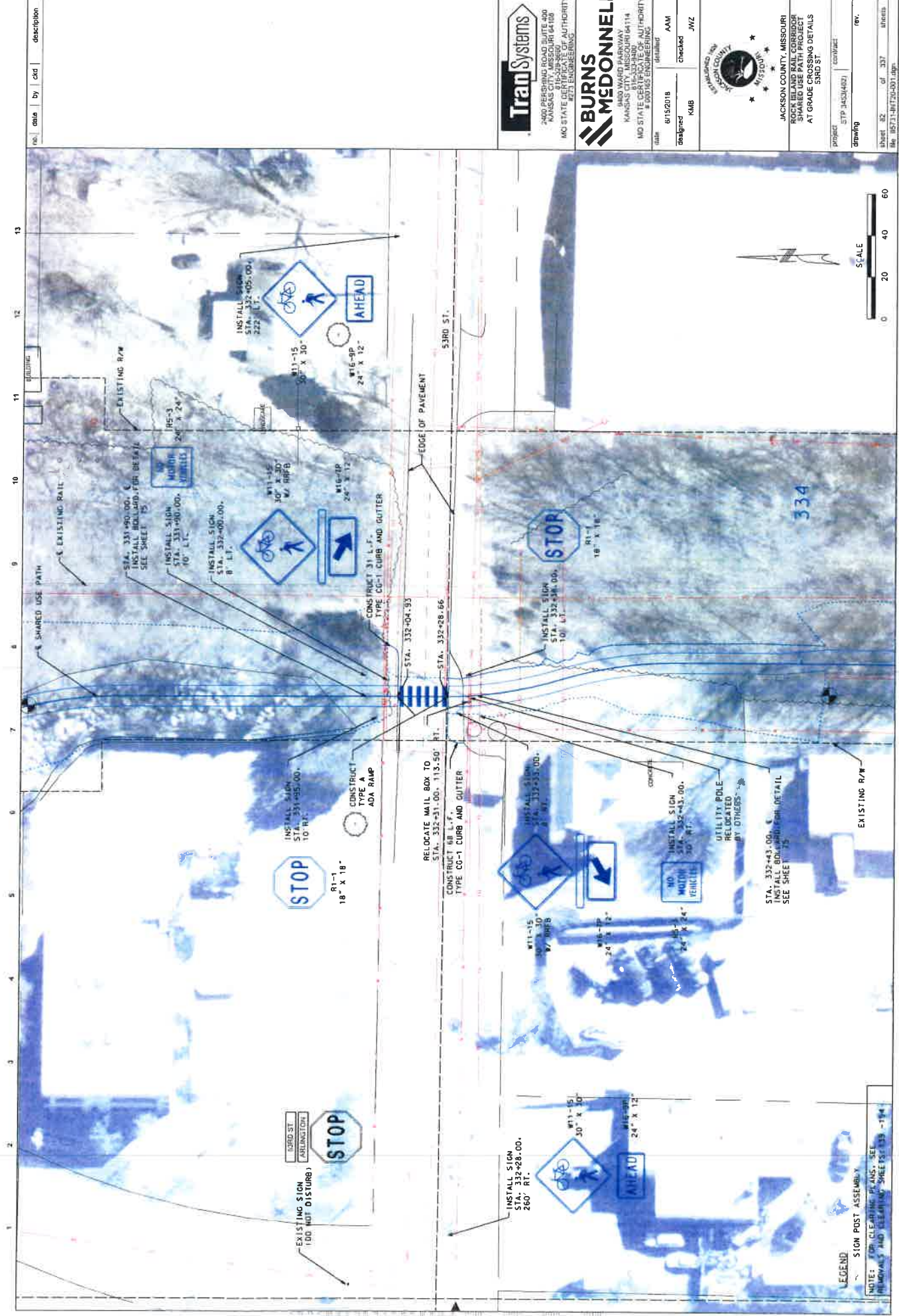

LEGEND
 ~~~~~ SIGN POST ASSEMBLY  
 --- FOR CLEARING PLANS, SEE  
 HIGHWAYS AND RELATED SHEETS 33-174

|                                                             |            |                                                                                                                          |                     |
|-------------------------------------------------------------|------------|--------------------------------------------------------------------------------------------------------------------------|---------------------|
| <b>TranSystems</b>                                          |            | 3400 PENDING ROAD SUITE 500<br>KANSAS CITY, MISSOURI 64110                                                               |                     |
| <b>BURNS MEDONNELL</b>                                      |            | 3400 WARD PARKWAY<br>KANSAS CITY, MISSOURI 64114                                                                         |                     |
| MO STATE CERTIFICATE OF AUTHORITY<br>ELECTRICAL ENGINEERING |            | MO STATE CERTIFICATE OF AUTHORITY<br>CIVIL ENGINEERING                                                                   |                     |
| DATE                                                        | 01/15/2018 | DESIGNED                                                                                                                 | AMM                 |
|                                                             |            | CHECKED                                                                                                                  | JWZ                 |
| PROJECT                                                     |            | JACKSON COUNTY, MISSOURI<br>ROCK ISLAND RAIL CORRIDOR<br>SHARED USE PATH PROJECT<br>AT GRADE CROSSING DETAILS<br>53RD ST |                     |
| DRAWING                                                     |            | EVP JAC/4/18/21                                                                                                          |                     |
| SHEET #2                                                    | OF 337     | DATE                                                                                                                     | 08/27/17-11/20/2017 |



# Exhibit A: 56th Street At-Grade Crossing

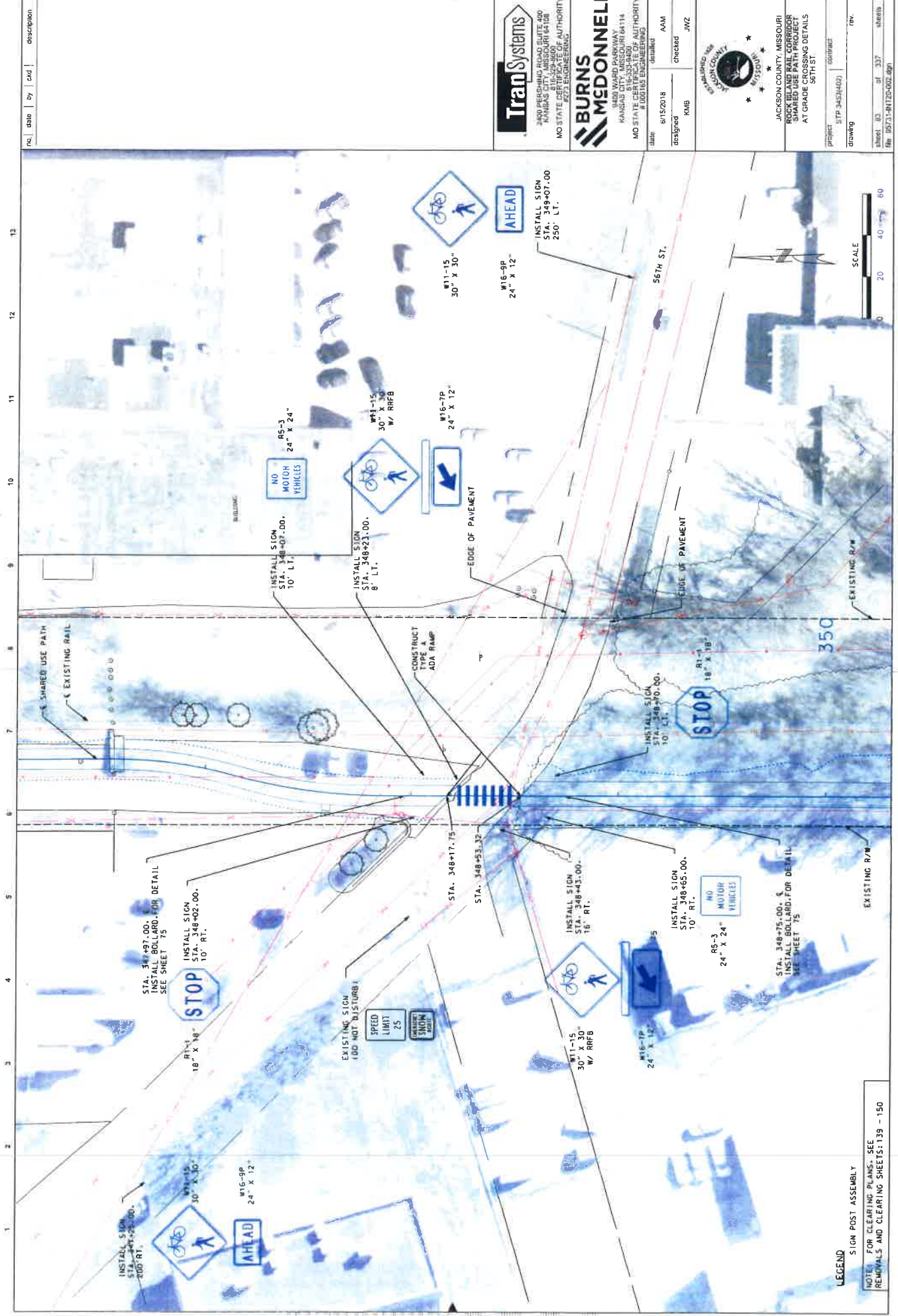

|     |      |    |     |             |
|-----|------|----|-----|-------------|
| no. | date | by | cto | description |
|     |      |    |     |             |

**TranSystems**  
 2400 PERRYMAN ROAD, SUITE 400  
 KANSAS CITY, MISSOURI 64118  
 MO STATE CERTIFICATE OF AUTHORITY  
 # 000185 ENGINEERING

**BURNS  
 MEDONNELL**  
 1400 WARD PARKWAY  
 KANSAS CITY, MISSOURI 64114  
 MO STATE CERTIFICATE OF AUTHORITY  
 # 000185 ENGINEERING

date: 6/15/2018  
 designed: KMB  
 checked: JMW  
 installed: \_\_\_\_\_

JACKSON COUNTY, MISSOURI  
 BOARD OF COMMISSIONERS  
 SHARED USE PATH PROJECT  
 AT GRADE CROSSING DETAILS  
 56TH ST

PROJECT: STP 345214(02) CONTRACT: \_\_\_\_\_  
 DRAWING: \_\_\_\_\_

sheet: 03 of 337 sheets  
 file: 05713-INT20-002.dgn

**LEGEND**  
 SIGN POST ASSEMBLY  
 NOTE: FOR CLEARING PLANS, SEE REMOVALS AND CLEARING SHEETS: 139 - 150





# Exhibit A: Woodson Road At-Grade Crossing

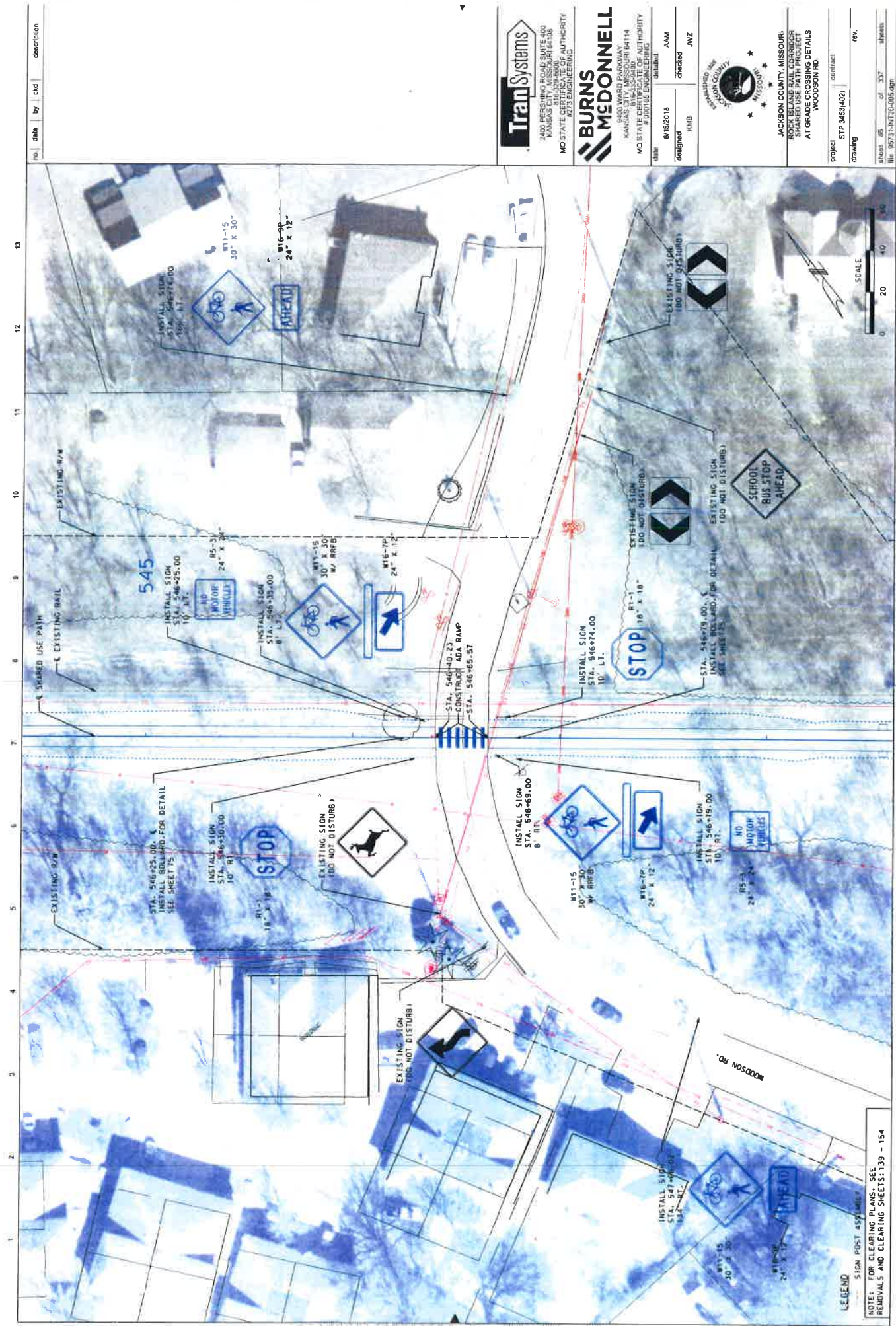

|     |      |    |     |             |
|-----|------|----|-----|-------------|
| no. | date | by | cto | description |
|     |      |    |     |             |

**TranSystems**  
2400 PERSHING ROAD SUITE 400  
PO BOX 31439  
KANSAS CITY, MISSOURI 64114  
MO STATE CERTIFICATE OF AUTHORITY  
#2019-00001

**BURNS MEDONNELL**  
9400 WARD PARKWAY  
KANSAS CITY, MISSOURI 64114  
MO STATE CERTIFICATE OF AUTHORITY  
#00195 ENGINEERING

date: 01/20/18  
designed: AM  
checked: JNZ

JACKSON COUNTY, MISSOURI  
ROCK ISLAND RAIL CORRIDOR  
SHARED USE PATH PROJECT  
AT GRADE CROSSING DETAILS  
WOODSON RD

|         |               |          |      |
|---------|---------------|----------|------|
| project | STP 3453(402) | contract | rev. |
| drawing |               |          |      |

sheet 05 of 337 sheets  
file 10771-INT20-006.dgn

**LEGEND**  
SIGN POST ASSEMBLY  
NOTE: FOR CLEARING PLANS, SEE REMOVALS AND CLEARING SHEETS: 139 - 154





# Exhibit A: 63rd Street Shared Use Path Underpass

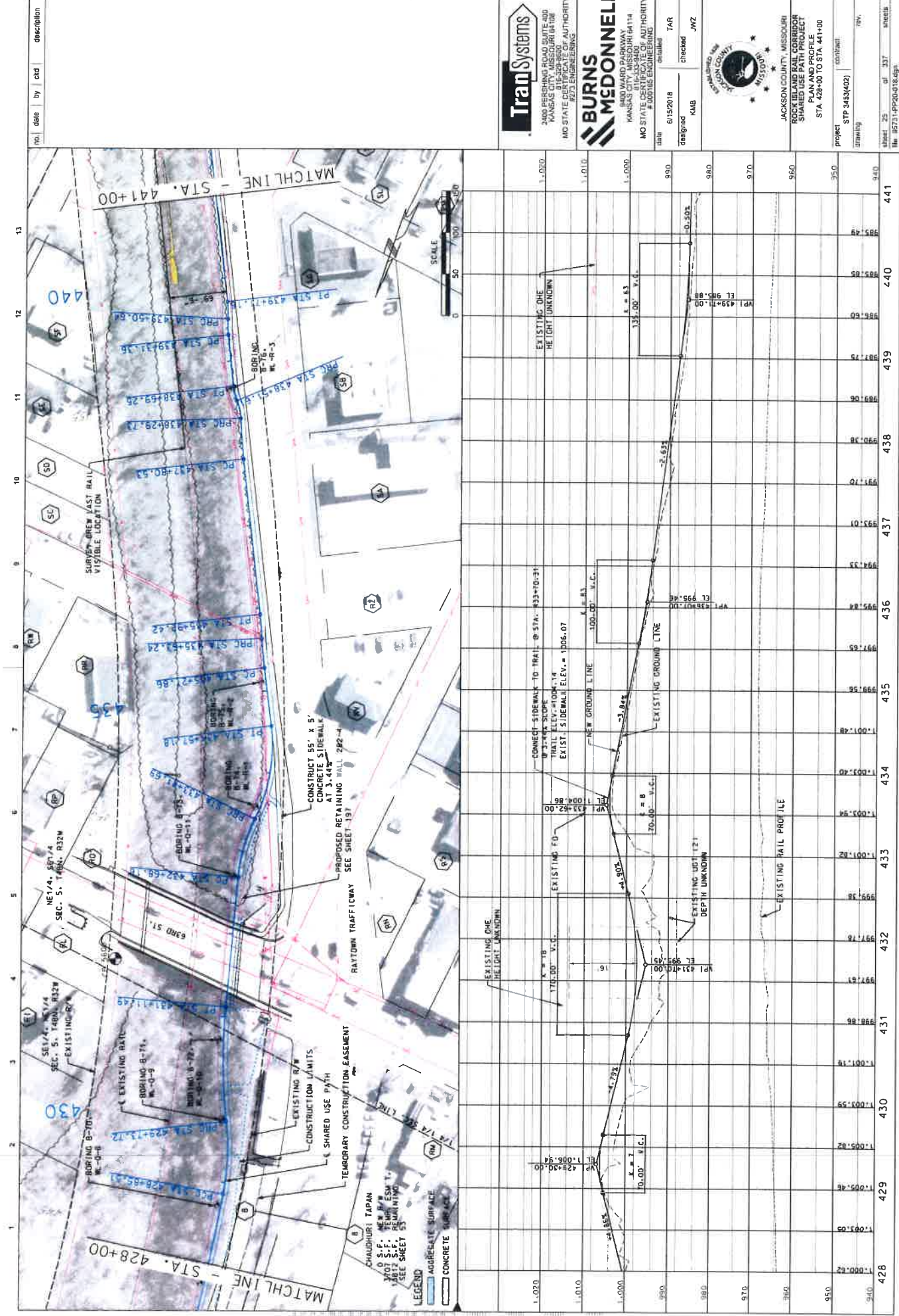

**TranSystems**  
 3400 PERDUE ROAD SUITE 400  
 KANSAS CITY, MISSOURI 64111  
 MO STATE CERTIFICATE OF AUTHORITY #000116 ENGINEERING

**BURNS & MCDONNELL**  
 1400 WARD PARKWAY  
 KANSAS CITY, MISSOURI 64114  
 MO STATE CERTIFICATE OF AUTHORITY #000116 ENGINEERING

date: 9/15/2018  
 designed: KMB  
 checked: JWZ  
 title: 63rd Street Shared Use Path Underpass

JACKSON COUNTY, MISSOURI  
 ROCKY HILL RAIL CORRIDOR  
 SHARED USE PATH PROJECT  
 PLAN AND PROFILE  
 STA. 428+00 TO STA. 441+00

PROJECT: STP 3424(402)  
 SHEET: 25 of 337  
 FILE: B5731-PP20-016.dgn

| no. | date | by | ctd | description |
|-----|------|----|-----|-------------|
|     |      |    |     |             |

# Exhibit A: 67th Street Shared Use Path Overpass

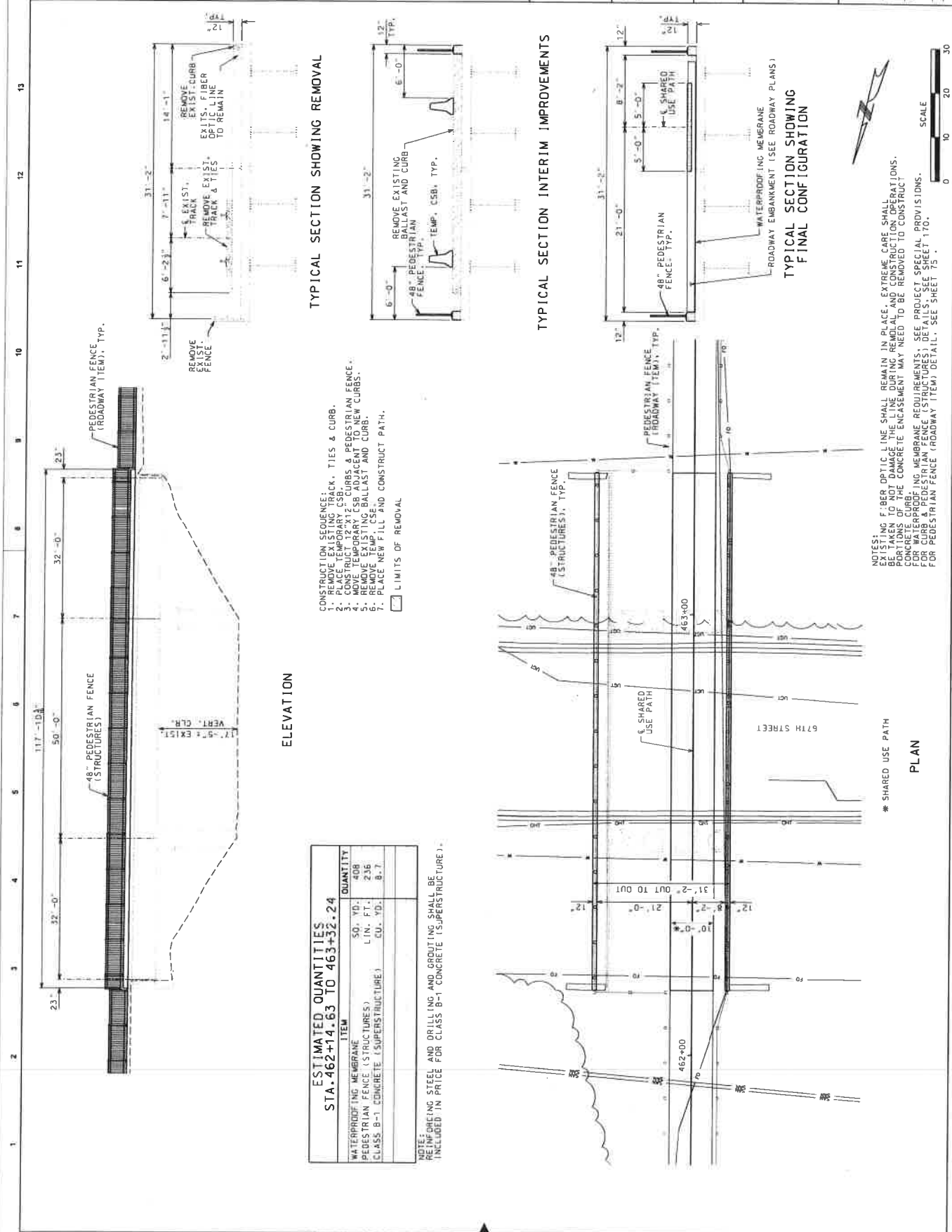

- CONSTRUCTION SEQUENCE:**
1. REMOVE EXISTING TRACK, TIES & CURB.
  2. PLACE TEMPORARY CSB.
  3. REMOVE EXISTING CSB, CURBS & PEDESTRIAN FENCE.
  4. MOVE TEMPORARY CSB ADJACENT TO NEW CURBS.
  5. REMOVE EXISTING BALLAST AND CURB.
  6. REMOVE TEMP. CSB.
  7. PLACE NEW FILL AND CONSTRUCT PATH.
- LIMITS OF REMOVAL

**ESTIMATED QUANTITIES**  
**STA. 462+14.63 TO 463+32.24**

| ITEM                                | SO. YD. | QUANTITY |
|-------------------------------------|---------|----------|
| WATERPROOFING MEMBRANE              | 408     |          |
| PEDESTRIAN FENCE (STRUCTURES)       | 236     |          |
| CLASS B-1 CONCRETE (SUPERSTRUCTURE) | 8.7     |          |

NOTE:  
REINFORCING STEEL AND DRILLING AND GROUTING SHALL BE INCLUDED IN PRICE FOR CLASS B-1 CONCRETE (SUPERSTRUCTURE).

NOTES:  
EXISTING FIBER OPTIC LINE SHALL REMAIN IN PLACE. EXTREME CARE SHALL BE TAKEN TO NOT DAMAGE THE LINE DURING REMOVAL AND CONSTRUCTION OPERATIONS. DIMENSIONS OF THE CONCRETE ENCASEMENT MAY NEED TO BE REMOVED TO CONSTRUCT FOR WATERPROOFING MEMBRANE REQUIREMENTS. SEE PROJECT SPECIAL PROVISIONS. FOR CURB & PEDESTRIAN FENCE (STRUCTURES) DETAILS. SEE SHEET 170. FOR PEDESTRIAN FENCE (ROADWAY ITEM) DETAIL. SEE SHEET 75.

\* SHARED USE PATH

PLAN

