

IN THE COUNTY LEGISLATURE OF JACKSON COUNTY, MISSOURI

AN ORDINANCE amending Load Limits Schedule B of Chapter 53 of the Jackson County Code, 1984.

ORDINANCE NO. 4541, July 1, 2013

INTRODUCED BY Bob Spence, County Legislator

WHEREAS, since the construction of Adams Dairy Parkway, Shroust Road south of Wyatt has seen an increase in truck traffic; and,

WHEREAS, due to the increase in truck traffic, and in response to requests for residents, the Acting Director of Public Works recommends that Shroust Road from Blue Springs city limits on the north to Lake Lotawana city limits on the south, be added to Schedule B, 12 Ton Load Limit, Designated Roadways; now therefore,

BE IT ORDAINED by the County Legislature of Jackson County, Missouri, as follows:

Section A. Enacting Clause. Schedule B of Chapter 53 of the Jackson County Code, 1984, is hereby amended by adding the following language:

JACKSON COUNTY LOAD LIMITS

SCHEDULE B

**12 TON LOAD LIMIT
DESIGNATED ROADWAYS**

Shroust Road - Blue Springs city limits to Lake Lotawana city limits

Effective Date: This Ordinance shall be effective immediately upon its signature by the County Executive.

APPROVED AS TO FORM:

Chief Deputy County Counselor

County Counselor

I hereby certify that the attached Ordinance, Ordinance No. 4541 introduced on July 1, 2013, was duly passed on July 1, 2013 by the Jackson County Legislature. The votes thereon were as follows:

Yeas 9

Nays 0

Abstaining 0

Absent 0

This Ordinance is hereby transmitted to the County Executive for his signature.

7-1-13
Date

Mary Jo Spino, Clerk of Legislature

I hereby approve the attached Ordinance No. 4541

7/1/2013
Date

Michael D. Sanders, County Executive

REQUEST FOR LEGISLATIVE ACTION

Completed by County Counselor's Office:

~~Res~~/Ord No.: 4541

Sponsor(s): Bob Spence

Date: July 1, 2013

<p>SUBJECT</p>	<p>Action Requested <input type="checkbox"/> Resolution <input checked="" type="checkbox"/> Ordinance</p> <p>Project/Title: <u>Approval to amend the Load Limit Code adding Shrou Road to the "B" list.</u></p>										
<p>BUDGET INFORMATION <i>To be completed By Requesting Department and Finance</i></p>	<table border="1" data-bbox="326 531 1198 842"> <tr> <td>Amount authorized by this legislation this fiscal year:</td> <td>\$</td> </tr> <tr> <td>Amount previously authorized this fiscal year:</td> <td>\$</td> </tr> <tr> <td>Total amount authorized after this legislative action:</td> <td>\$</td> </tr> <tr> <td>Amount budgeted for this item * (including transfers):</td> <td>\$</td> </tr> <tr> <td>Source of funding (name of fund) and account code number; FROM / TO</td> <td>FROM ACCT TO ACCT</td> </tr> </table> <p>* If account includes additional funds for other expenses, total budgeted in the account is: \$</p> <p>OTHER FINANCIAL INFORMATION:</p> <p><input checked="" type="checkbox"/> No budget impact (no fiscal note required) <input type="checkbox"/> Term and Supply Contract (funds approved in the annual budget); estimated value and use of contract: Department: Estimated Use: \$</p> <p>Prior Year Budget (if applicable): Prior Year Actual Amount Spent (if applicable):</p>	Amount authorized by this legislation this fiscal year:	\$	Amount previously authorized this fiscal year:	\$	Total amount authorized after this legislative action:	\$	Amount budgeted for this item * (including transfers):	\$	Source of funding (name of fund) and account code number; FROM / TO	FROM ACCT TO ACCT
Amount authorized by this legislation this fiscal year:	\$										
Amount previously authorized this fiscal year:	\$										
Total amount authorized after this legislative action:	\$										
Amount budgeted for this item * (including transfers):	\$										
Source of funding (name of fund) and account code number; FROM / TO	FROM ACCT TO ACCT										
<p>PRIOR LEGISLATION</p>	<p>Prior ordinances and (date): Ord 692 dated 4-21-79</p> <p>Prior resolutions and (date):</p>										
<p>CONTACT INFORMATION</p>	<p>RLA drafted by (name, title, & phone): Earl Newill, P.E. Deputy Director , 401-6401 cell</p>										
<p>REQUEST SUMMARY</p>	<p>Chapter 53 of the County Code addresses load limits on County Roads. Since Adams Dairy Road has been built, Shrou road south of Wyatt, has seen an increase in truck traffic. In response to requests from residents on the road and in view of the new construction to the north, the public works department recommends that Shrou Road, from Blue Springs city limits on the north, to Lake Lotawana City limits on the south, be added to the "B" list in the code. Upon approval a load limit sign would be installed, limiting, truck traffic that is just driving through, to 12 tons, all other trucks with business on the road are limited to the State load limit.</p>										
<p>CLEARANCE</p>	<p><input type="checkbox"/> Tax Clearance Completed (Purchasing & Department)</p>										

	<input type="checkbox"/> Business License Verified (Purchasing & Department) <input type="checkbox"/> Chapter 6 Compliance - Affirmative Action/Prevailing Wage (County Auditor's Office)	
ATTACHMENTS	Load Limit Exceptions, Location Map	
REVIEW	Deputy Director: Earl Newill <i>Earl Newill</i>	Date: 06/20/2013
	Finance (Budget Approval): <i>If applicable Deborah S Ball N/A</i>	Date: <i>6-24-13</i>
	Division Manager: <i>[Signature]</i>	Date: <i>6/24/13</i>
	County Counselor's Office:	Date:

Fiscal Information (to be verified by Budget Office in Finance Department)

- This expenditure was included in the annual budget.
- Funds for this were encumbered from the _____ Fund in _____.
- There is a balance otherwise unencumbered to the credit of the appropriation to which the expenditure is chargeable and there is a cash balance otherwise unencumbered in the treasury to the credit of the fund from which payment is to be made each sufficient to provide for the obligation herein authorized.
- Funds sufficient for this expenditure will be/were appropriated by Ordinance # _____
- Funds sufficient for this appropriation are available from the source indicated below.

Account Number:	Account Title:	Amount Not to Exceed:

- This award is made on a need basis and does not obligate Jackson County to pay any specific amount. The availability of funds for specific purchases will, of necessity, be determined as each using agency places its order.
- This legislative action does not impact the County financially and does not require Finance/Budget approval.

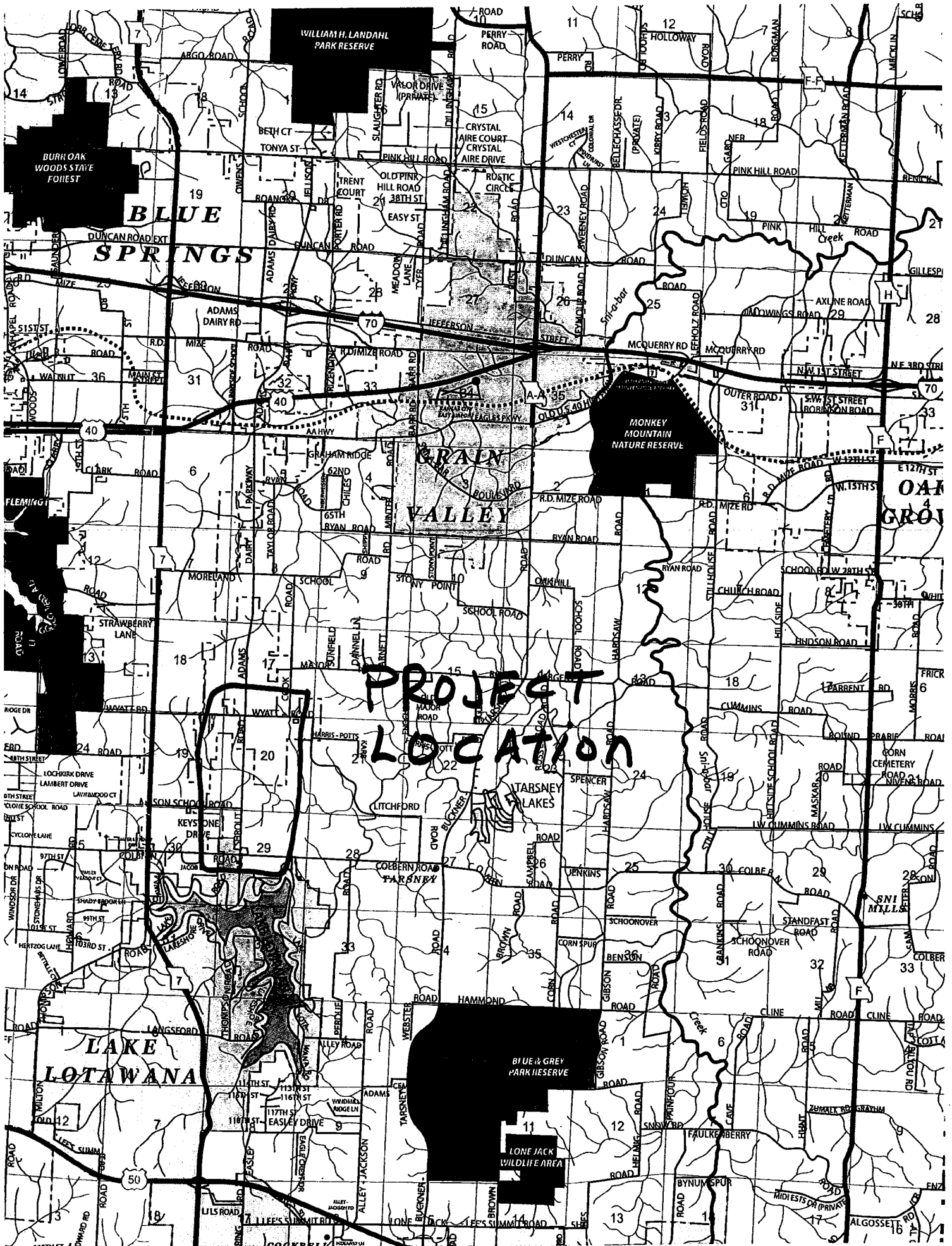

**PROJECT
LOCATION**

**BLUE
SPRINGS**

**RAIN
VALLEY**

**LAKE
LOTAWANA**

WILLIAM H. LANDAHL
PARK RESERVE

MONKEY
MOUNTAIN
NATURE RESERVE

BLUE & GREY
PARK RESERVE

LONE JACK
WILDLIFE AREA

BUR OAK
WOODS STATE
FOREST

OAK
GROVE

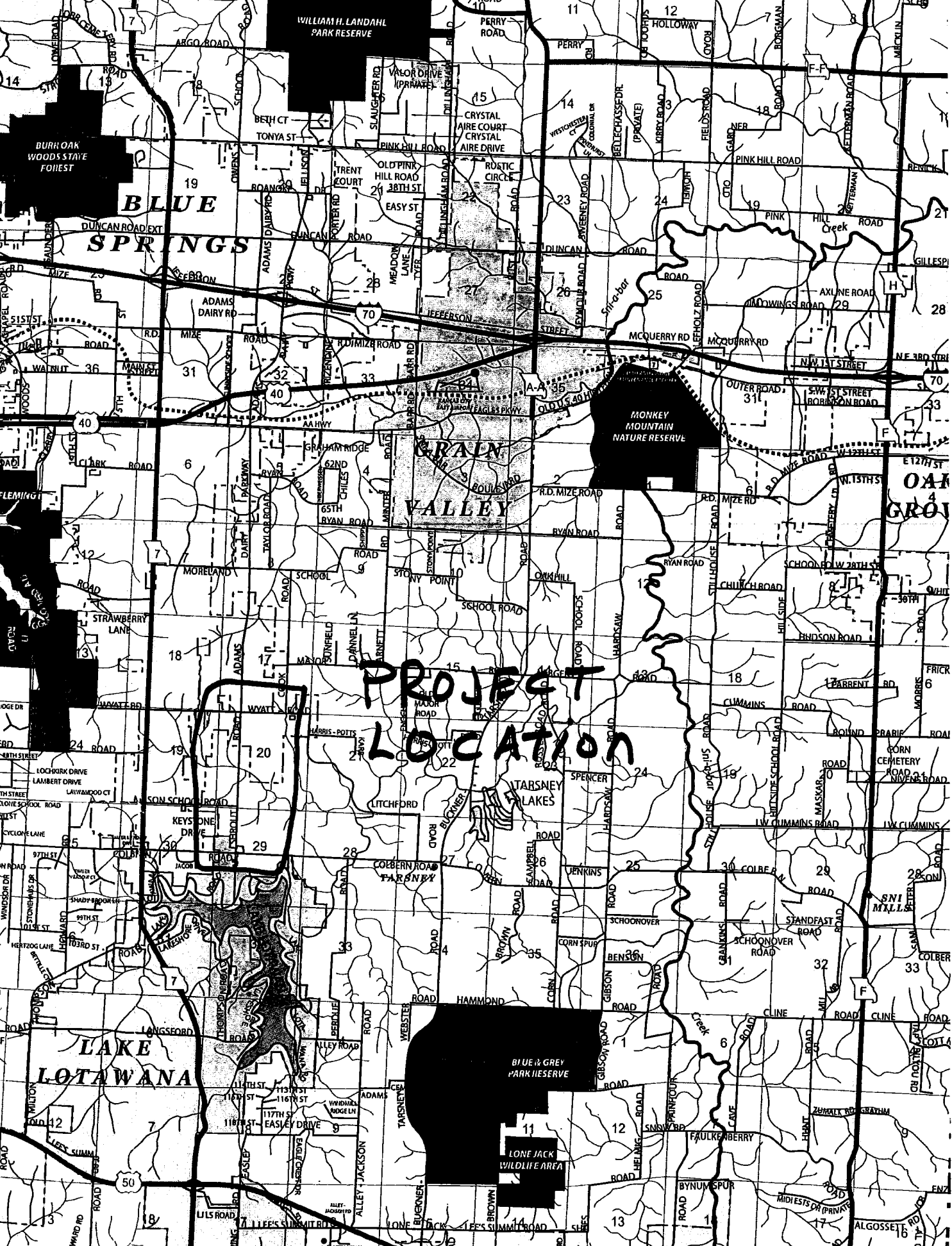

(Ord. 692, Sec. 1.7, Eff. 4-21-79)

5318. - 5319. RESERVED

OPERATION OF MOTOR VEHICLES

5320. Motor Vehicles Subject to Weight Limits.

Motor vehicles which are operated on roadways are subject to the weight limitations imposed by this or other applicable ordinance for the roadway specified. (Ord. 692, Sec. 2, Eff. 4-21-79)

C/R: 5330.00 - 5332.00, Weight limitations.

5321. Vehicle Operation in Excess of Weight Limits Prohibited.

No motor vehicle shall be operated on any roadway which is subject to weight limitations whose gross weight exceeds the weight for which the vehicle has been licensed by the state. (Ord. 692, Sec. 4, Eff. 4-21-79)

C/R: 5330.00 - 5332.00, weight limitations and gross weight, defined.

5322. Load Limit Exceptions.

The load limitation imposed by this chapter do not prohibit the following. (Ord. 692, Sec. 3, Eff. 4-21-79)

5322.1 Necessary to Conduct Business.

The load limitations imposed by this chapter do not prohibit the operation of motor vehicles, otherwise in violation of applicable load limits set by ordinance but not in excess of state load limits, to a destination located on a roadway which is necessary to the conduct of the business of the operator, provided that the roadway in question is used from the intersection nearest the destination point. (Ord. 692, Sec. 3.1, Eff. 4-21-79)

5322.2 Emergency Vehicles.

The load limitations imposed by this chapter do not prohibit the operation of law enforcement of fire fighting equipment or ambulances. (Ord. 692, Sec. 3.2, Eff. 4-21-79)

5322.3 School Bus.

The load limitations imposed by this chapter do not prohibit the operation of school buses. (Ord. 692, Sec. 3.3, Eff. 4-21-79)

C/R: 5316.00, school bus defined.

5322.4 Farm Equipment.

The load limitations imposed by this chapter do not prohibit the operation of farm equipment. (Ord. 692, Sec. 3.3, Eff. 4-21-79)

5322.5 County or Public Utility Vehicles.

The load limitations imposed by this chapter do not prohibit the operation of motor vehicles owned or operated by the county or public utilities or their contractors or material suppliers while engaged in the repair, maintenance or construction of roadways, bridges, right-of-way improvement or utility installations, equipment or fixtures. (Ord. 692, Sec. 3.4, Eff. 4-21-79)

5322.6 Special Permit, Vehicle Load Limitations.

The load limitations imposed by this chapter do not prohibit the operation of motor vehicles, otherwise in violation of applicable load limits, where the operator or owner of the vehicle first secures a permit for that operation from the Department of Public Works. (Ord. 692, Sec. 3.5, Eff. 4-21-79)

C/R: 5350.00 through 5324.00, relating to special permits.

5323. Penalty, Violation of Vehicle Load Limit Code.

The operation of motor vehicles in violation of the applicable load limits imposed by this chapter is a county ordinance violation which shall, on conviction, be punished by a fine calculated at one dollar (\$1) for each pound that the gross weight of the vehicle exceeds the applicable load limit. The fine shall not be less than one hundred (\$100) nor more than one thousand dollars (\$1,000). Ord. 692, Sec. 2, Eff. 4-21-79)

5324. - 5329. RESERVED

WEIGHT LIMITS

5330. Load Limits of Roadways.

All roadways shall carry state load limits if not posted otherwise. (Ord. 692, Sec. 8, Eff. 4-21-79)

5331. 16,000 Pound Limit Roadways.

No motor vehicle or combination of vehicles exceeding a gross weight of 16,000 pounds shall be moved or operated on the roadways listed in Schedule A of this chapter. (Ord. 692, Sec. 8, Eff. 4-21-79)

5332. Load Limits on Bridges.

The load limits imposed by this or any other ordinance for roadways do not apply to or affect the posted load limits established by the Department of Public Works for county bridges. (Ord. 692, Sec. 7.B, Eff. 4-21-79)

5333. Twenty-four Thousand (24,000) Pound Limit Roadways.

No motor vehicle or combination of vehicles exceeding a gross weight of 24,000 pounds shall be moved or operated on the roadways listed in Schedule B of this chapter. (Ord. 1242, Eff. 9-26-84)

5334. - 5339. RESERVED