

IN THE COUNTY LEGISLATURE OF JACKSON COUNTY, MISSOURI

A RESOLUTION awarding a contract on Bid No. PW 01-2013 for the R.D. Mize Road Culvert Replacement Project, No. 3123, to Ground Breaking Excavation & Utilities, LLC, of Pleasant Hill, MO, at an actual cost to the County not to exceed \$136,810.00, and authorizing the Director of Public Works to approve line item adjustments under this contract at no additional cost to the County.

RESOLUTION NO. 18114, March 11, 2013

INTRODUCED BY Bob Spence, County Legislator

WHEREAS, an existing narrow culvert located on R.D. Mize Road is in poor condition and in need of replacement; and,

WHEREAS, the Director of Public Works has solicited formal written bids on Bid No. PW 01-2013 for R.D. Mize Road Culvert Replacement Project, No. 3123; and,

WHEREAS, he has received twelve bids thereon, with the three lowest bids as follows:

<u>VENDOR</u>	<u>BID</u>
Ground Breaking Excavation & Utilities, Inc. Pleasant Hill, MO	\$136,810.00
Radmacher Brothers Excavation Co., Inc. Pleasant Hill, MO	\$141,779.00
WCI, Inc. Hillsdale, KS	\$143,018.00

and,

WHEREAS, the Director of Public Works recommends that award be made to Ground

Breaking Excavation & Utilities, LLC, for the reason that it has submitted the lowest and best bid; and,

WHEREAS, in the event that line item adjustments to the contract become necessary, it is appropriate that the Director of Public Works be authorized to approve said line item adjustments to the extent there is no additional cost to the County; now therefore,

BE IT RESOLVED by the County Legislature of Jackson County, Missouri, that award be made as recommended by the Director of Public Works and that the Director be and hereby is authorized to execute any documents necessary to the accomplishment of the award; and,

BE IT FURTHER RESOLVED that the Director of Public Works be and hereby is authorized to make adjustments in the contract line item quantities to the extent that there will be no further funding obligation to the County; and,

BE IT FURTHER RESOLVED that the Director of Finance and Purchasing is authorized to make all payments, including final payment on the contract.

Effective Date: This Resolution shall be effective immediately upon its passage by a majority of the Legislature.

APPROVED AS TO FORM:



Chief Deputy County Counselor

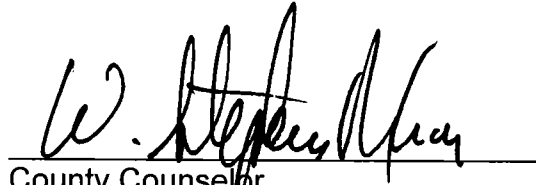

County Counselor

Certificate of Passage

I hereby certify that the attached resolution, Resolution No. 18114 of March 11, 2013, was duly passed on March 18, 2013 by the Jackson County Legislature. The votes thereon were as follows:

Yeas 8

Nays 0

Abstaining 0

Absent 1

3-18-13
Date



Mary Jo Spino, Clerk of Legislature

There is a balance otherwise unencumbered to the credit of the appropriation to which the expenditure is chargeable and there is a cash balance otherwise unencumbered in the treasury to the credit of the fund from which payment is to be made each sufficient to provide for the obligation herein authorized.

ACCOUNT NUMBER: 004 1507 58040
ACCOUNT TITLE: Special Road and Bridge Fund
Special Project in Public Works
Roads and Highways
NOT TO EXCEED: \$136,810.00

March 5, 2013
Date

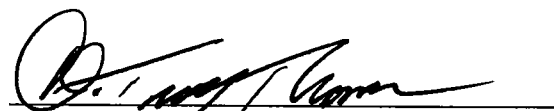

Director of Finance and Purchasing

REQUEST FOR LEGISLATIVE ACTION



Completed by County Counselor's Office:

Res/Ord No.: 18114

Sponsor(s): Bob Spence

Date: March 11, 2013

<p>SUBJECT</p>	<p>Action Requested <input checked="" type="checkbox"/> Resolution <input type="checkbox"/> Ordinance</p> <p>Project/Title: <u>Recommending award of a construction contract to Ground Breaking Excavation & Utilities, LLC in the amount of \$136,810.00 for R.D. Mize Road Culvert Replacement.</u></p> <p>Project Number: <u>County No. 3123, PW 01-2013</u></p>												
<p>BUDGET INFORMATION <i>To be completed By Requesting Department and Finance</i></p>	<table border="1"> <tr> <td>Amount authorized by this legislation this fiscal year:</td> <td>\$136,810.00</td> </tr> <tr> <td>Amount previously authorized this fiscal year:</td> <td>\$0</td> </tr> <tr> <td>Total amount authorized after this legislative action:</td> <td>\$136,810.00</td> </tr> <tr> <td>Amount budgeted for this item * (including transfers):</td> <td>\$136,810.00</td> </tr> <tr> <td>Source of funding (name of fund) and account code number; FROM / TO</td> <td>FROM ACCT Public Works Special Projects Fund 004-1507-58040 TO ACCT</td> </tr> </table> <p>* If account includes additional funds for other expenses, total budgeted in the account is: \$830,000.00</p> <p>OTHER FINANCIAL INFORMATION:</p> <p><input type="checkbox"/> No budget impact (no fiscal note required) <input type="checkbox"/> Term and Supply Contract (funds approved in the annual budget); estimated value and use of contract: Department: Estimated Use: \$</p> <p>Prior Year Budget (if applicable): Prior Year Actual Amount Spent (if applicable):</p>	Amount authorized by this legislation this fiscal year:	\$136,810.00	Amount previously authorized this fiscal year:	\$0	Total amount authorized after this legislative action:	\$136,810.00	Amount budgeted for this item * (including transfers):	\$136,810.00	Source of funding (name of fund) and account code number; FROM / TO	FROM ACCT Public Works Special Projects Fund 004-1507-58040 TO ACCT		
Amount authorized by this legislation this fiscal year:	\$136,810.00												
Amount previously authorized this fiscal year:	\$0												
Total amount authorized after this legislative action:	\$136,810.00												
Amount budgeted for this item * (including transfers):	\$136,810.00												
Source of funding (name of fund) and account code number; FROM / TO	FROM ACCT Public Works Special Projects Fund 004-1507-58040 TO ACCT												
<p>PRIOR LEGISLATION</p>	<p>Prior ordinances and (date): N/A</p> <p>Prior resolutions and (date): N/A</p>												
<p>CONTACT INFORMATION</p>	<p>RLA drafted by (name, title, & phone): Chris Jenkins, Project Manager, 881-4429</p>												
<p>REQUEST SUMMARY</p>	<p>This project is the replacement of an existing narrow culvert in poor condition. The project is located about 1/8 mile west of R.D. Mize Road and Stillhouse Road intersection. The work includes a new 72 inch diameter pipe, guardrail, and erosion control. The project is scheduled to be completed during the Summer 2013 while school is out to avoid conflicts with school bus traffic. This project is on the Capital Improvement Plan (CIP).</p> <p>The Department of Public Works solicited bids for this project. Sealed proposals were opened on February 12, 2013 at the offices of Public Works. Twelve (12) firms submitted bids. A summary of the three lowest bids are as follows: As Read</p> <table border="1"> <thead> <tr> <th>Contractors Name</th> <th>Bid Amount</th> <th>City & State</th> </tr> </thead> <tbody> <tr> <td>Ground Breaking Excavation & Utilities, Inc.</td> <td>\$136,810.00</td> <td>Pleasant Hill, MO.</td> </tr> <tr> <td>Radmacher Brothers Excavation Co., Inc.</td> <td>\$141,779.00</td> <td>Pleasant Hill, MO.</td> </tr> <tr> <td>WCI Inc.</td> <td>\$143,018.00</td> <td>Hillsdale, KS.</td> </tr> </tbody> </table> <p>The Engineers Estimate for the project is \$185,898.50.</p>	Contractors Name	Bid Amount	City & State	Ground Breaking Excavation & Utilities, Inc.	\$136,810.00	Pleasant Hill, MO.	Radmacher Brothers Excavation Co., Inc.	\$141,779.00	Pleasant Hill, MO.	WCI Inc.	\$143,018.00	Hillsdale, KS.
Contractors Name	Bid Amount	City & State											
Ground Breaking Excavation & Utilities, Inc.	\$136,810.00	Pleasant Hill, MO.											
Radmacher Brothers Excavation Co., Inc.	\$141,779.00	Pleasant Hill, MO.											
WCI Inc.	\$143,018.00	Hillsdale, KS.											

	<p>The Public Works Department has reviewed the bids and recommends the project be awarded to Ground Breaking Excavation & Utilities, LLC as the lowest and best bidder.</p> <p>We request that</p> <ol style="list-style-type: none"> 1. A resolution be prepared authorizing the County Executive to execute a contract with Ground Breaking Excavation & Utilities, LLC. The Director be authorized to approve adjustments in the Contract line items, limited to the amount authorized by this resolution; and, 3. The Manager of Finance be authorized to encumber \$136,810.00 to cover the cost of construction. 	
CLEARANCE	<input type="checkbox"/> Tax Clearance Completed (Purchasing & Department) <input type="checkbox"/> Business License Verified (Purchasing & Department) <input type="checkbox"/> Chapter 6 Compliance - Affirmative Action/Prevailing Wage (County Auditor's Office)	
ATTACHMENTS	Bid Tabulation, Tax Clearance, List of Intended Subcontractors, Missouri Business in Good Standing, Certificate of Compliance, and Location Map.	
REVIEW	Department Director: Larry J. Schall, P.E. 	Date: 02-27-2013
	Finance (Budget Approval): <i>If applicable</i>	Date: 2/28/13
	Division Manager: 	Date: 2/28/13
	County Counselor's Office:	Date:

Fiscal Information (to be verified by Budget Office in Finance Department)

- This expenditure was included in the annual budget.
- Funds for this were encumbered from the _____ Fund in _____.
- There is a balance otherwise unencumbered to the credit of the appropriation to which the expenditure is chargeable and there is a cash balance otherwise unencumbered in the treasury to the credit of the fund from which payment is to be made each sufficient to provide for the obligation herein authorized.
- Funds sufficient for this expenditure will be/were appropriated by Ordinance # _____
- Funds sufficient for this appropriation are available from the source indicated below.

Account Number:	Account Title:	Amount Not to Exceed:
004-1507-58040	Public Works Special Projects Fund	\$136,810.00

- This award is made on a need basis and does not obligate Jackson County to pay any specific amount. The availability of funds for specific purchases will, of necessity, be determined as each using agency places its order.
- This legislative action does not impact the County financially and does not require Finance/Budget approval.



Jackson County, Missouri
 Department of Public Works - Engineering Division
 303 W. Walnut
 Independence, MO. 64050

Bid Tabulation Prepared By:
 Chris Jenkins,
 Project Manager

LIST OF BIDDERS

UNOFFICIAL

JCPW Contact for project information: Chris Jenkins at 816-881-4429

Project: R.D.MIZE ROAD CULVERT REPLACEMENT

COUNTY PROJECT NO. 3123 - BID NO. PW 01-2013

BID OPENING DATE AND TIME: February 12, 2013 2:05 p.m.

NOTE: This is an unofficial bid tabulation and only reflects the initial reading of the bids received, not the evaluation of such bids.

NO.	Firm	City and State	Amount Bid	% above Low
1	Ground Breaking Excavation & Utilities, L.L.C.	Pleasant Hill, MO.	\$136,810.00	0.00%
2	Radmacher Brothers Excavating Co., Inc.	Pleasant Hill, MO.	\$141,779.00	3.63%
3	WCI Inc.	Hillsdale, KS.	\$143,018.00	4.54%
4	Wil-Pav, Inc.	Sugar Creek, MO.	\$148,066.00	8.23%
5	Redford Construction, Inc.	Raymore, MO.	\$149,737.00	9.45%
6	Trinity Excavating & Construction	Kansas City, KS.	\$163,408.00	19.44%
7	Linaweaver Construction, Inc.	Lansing, KS.	\$165,283.50	20.81%
8	KAT Excavation, Inc.	Bates City, MO.	\$175,350.53	28.17%
9	Gunter Construction Co.	Kansas City, KS.	\$188,428.00	37.73%
10	Blue Nile Contractors, Inc.	Claycomo, MO.	\$195,312.63	42.76%
11	Sarai Construction, Inc.	Blue Springs, MO.	\$197,447.00	44.32%
12	Fleshman Construction, Inc.	North Kansas City, MO.	\$205,682.00	50.34%
	Engineers Estimate - JCPW	Independence, MO.	\$185,898.50	35.88%

Bid Opening Date and Time: February 12, 2013 at 2:05 p.m.

Bid Tabulation for: R.D. Mize Road Culvert Replacement

Jackson County PN 3123 - Bid No. PW-01-2013

NOTE: This is an Unofficial bid tabulation and only reflects the initial reading of the bids received, not the evaluation of such bids.

Department of Public Works - Engineering Division

UNOFFICIAL

Numbers highlighted in Yellow denote mathematical error.

Item No.	Description	Unit	No. Units	1			2			3			4			5		
				Unit Price	Total Amt. Bid	Unit Price	Total Amt. Bid	Unit Price	Total Amt. Bid	Unit Price	Total Amt. Bid	Unit Price	Total Amt. Bid	Unit Price	Total Amt. Bid			
This project is funded and Administered by Jackson County																		
				Ground Breaking Excavation & Utilities, L.L.C.			Radmacher Brothers Excavating Co., Inc.			WCI Inc.			Wit-Pav, Inc.			Redford Construction, Inc.		
				Pleasant Hill, MO.			Pleasant Hill, MO.			Hillsdale, KS.			Sugar Creek, MO.			Raymore, MO.		
				Unit Price	Total Amt. Bid	Unit Price	Total Amt. Bid	Unit Price	Total Amt. Bid	Unit Price	Total Amt. Bid	Unit Price	Total Amt. Bid	Unit Price	Total Amt. Bid	Unit Price	Total Amt. Bid	
ROADWAY BID ITEMS																		
1	Mobilization	Lump Sum	1.0	9,245.50	9,245.50	10,000.00	10,000.00	6,300.00	6,300.00	14,000.00	14,000.00	7,000.00	7,000.00				7,000.00	
2	Remove and Reset Mailbox	Each	1.0	100.00	100.00	250.00	250.00	250.00	250.00	150.00	150.00	250.00	250.00				250.00	
3	Cleaning and Grubbing	Acres	0.5	2,500.00	1,250.00	13,200.00	6,600.00	3,500.00	1,750.00	4,000.00	2,000.00	10,000.00	5,000.00				5,000.00	
4	Unclassified Excavation & Embankment	Lump Sum	1.0	7,356.00	7,356.00	8,750.00	8,750.00	4,000.00	4,000.00	5,000.00	5,000.00	7,000.00	7,000.00				7,000.00	
5	APWA Type 3-01 Asphaltic Concrete Surface (2" Thick)	S.Y.	180.0	28.00	5,040.00	18.50	3,330.00	33.00	5,940.00	22.00	3,960.00	20.00	3,600.00				3,600.00	
6	Asphaltic or Concrete Base Course (8" Thick)	S.Y.	180.0	52.00	9,360.00	64.50	11,610.00	54.00	9,720.00	57.50	10,350.00	44.00	7,920.00				7,920.00	
7	Rock Blanket (Type 2, 24" Thick) WITH Geotextile Fabric	C.Y.	80.0	87.50	7,000.00	60.00	4,800.00	90.00	7,200.00	21.00	1,680.00	75.00	6,000.00				6,000.00	
8	Staking of the Right-of-Way	Lump Sum	1.0	485.00	485.00	1,050.00	1,050.00	3,000.00	3,000.00	2,200.00	2,200.00	1,300.00	1,300.00				1,300.00	
9	Permanent Mulching (Hydro-Mulched)	Acres	0.5	2,350.00	1,175.00	2,140.00	1,070.00	1,600.00	800.00	2,200.00	1,100.00	2,000.00	1,000.00				1,000.00	
10	Permanent Seeding (Hydro-Seeded)	Acres	0.5	2,350.00	1,175.00	2,140.00	1,070.00	1,600.00	800.00	2,200.00	1,100.00	2,000.00	1,000.00				1,000.00	
11	Permanent Erosion Control Blanket (C-350)	S.Y.	320.0	6.90	2,208.00	4.00	1,280.00	7.00	2,240.00	4.00	1,280.00	4.50	1,440.00				1,440.00	
12	Temporary Fertilizer, Mulch and Seed	Acres	0.5	1,300.00	650.00	2,000.00	1,000.00	3,000.00	1,500.00	2,000.00	1,000.00	1,000.00	500.00				500.00	
13	Rock Ditch Checks (Type 1)	Each	3.0	450.00	1,350.00	275.00	825.00	500.00	1,500.00	500.00	1,500.00	300.00	900.00				900.00	
14	Silt Fence	L.F.	605.0	1.30	786.50	2.00	1,210.00	2.00	1,210.00	2.00	1,210.00	1.50	907.50				907.50	
15	Type 3 Barricades with Flashers (T3B)	Each	6.0	340.00	2,040.00	360.00	2,160.00	250.00	1,500.00	400.00	2,400.00	225.00	1,350.00				1,350.00	
16	Traffic Control Signs	S.F.	468.0	12.00	5,616.00	15.00	7,020.00	16.00	7,488.00	12.00	5,616.00	19.00	8,892.00				8,892.00	
17	Guardrail Type A	L.F.	175.0	17.20	3,010.00	18.00	3,150.00	20.00	3,500.00	22.00	3,850.00	17.50	3,062.50				3,062.50	
18	50' Type A Crashworthy End Terminal (ET PLUS)	Each	4.0	1,975.00	7,900.00	1,925.00	7,700.00	2,000.00	8,000.00	2,000.00	8,000.00	1,850.00	7,400.00				7,400.00	

Bid Opening Date and Time: February 12, 2013 at 2:05 p.m.

Bid Tabulation for: R.D. Mize Road Culvert Replacement
Jackson County PN 3123 - Bid No. PW-01-2013

NOTE: This is an Unofficial bid tabulation and only reflects the initial reading of the bids received, not the evaluation of such bids.

Department of Public Works - Engineering Division

UNOFFICIAL

Numbers highlighted in Yellow denote mathematical error.

Item No	Description	Unit	No. Units	1		2		3		4		5	
				Ground Breaking Excavation & Utilities, L.L.C.	Pleasant Hill, MO.	Radmacher Brothers Excavating Co., Inc.	Pleasant Hill, MO.	WCI Inc.	Hillsdale, KS.	Wil-Pav, Inc.	Sugar Creek, MO.	Redford Construction, Inc.	Raymore, MO.
This project is funded and Administered by Jackson County				Unit Price	Total Amt. Bid	Unit Price	Total Amt. Bid	Unit Price	Total Amt. Bid	Unit Price	Total Amt. Bid	Unit Price	Total Amt. Bid
CULVERT BID ITEMS													
19	Removal of Existing Culvert and Improvements for Roadway	Lump Sum	1.0	2,828.00	2,828.00	6,000.00	6,000.00	6,200.00	6,200.00	5,300.00	5,300.00	5,000.00	5,000.00
20	72" Dia. Reinforced Concrete Pipe (RCP), (Class III, Wall B)	L.F.	64.0	290.00	18,560.00	246.00	15,744.00	305.00	19,520.00	330.00	21,120.00	260.00	16,640.00
21	Filling of Open Cut under Roadway with CLSM	CY	175.0	84.00	14,700.00	95.00	16,625.00	84.00	14,700.00	100.00	17,500.00	100.00	17,500.00
22	Cast-in-Place Concrete Retaining Walls	CY	37.0	675.00	24,875.00	555.00	20,535.00	700.00	25,900.00	750.00	27,750.00	975.00	36,075.00
23	Force Account	Lump Sum	1.0	10,000.00	10,000.00	10,000.00	10,000.00	10,000.00	10,000.00	10,000.00	10,000.00	10,000.00	10,000.00
Total Amount Bid for Project (Items 1 to 23) =					\$136,810.00		\$141,779.00		\$143,018.00		\$148,066.00		\$149,737.00
Received Bid Totals 2-12-2013					\$136,810.00		\$141,779.00		\$143,018.00		\$148,066.00		\$149,737.00
Math or Extension Error Total Amount					\$0.00		\$0.00		\$0.00		\$0.00		\$0.00
Extension error line (s) (Item No. Above) ??													

Notes:

1. The County reserves the right to adjust the quantities up or down to any and all bid items to accommodate available funds.

Bid Opening Date and Time: February 12, 2013 at 2:05 p.m.

NOTE: This is an Unofficial bid tabulation and only reflects the initial reading of the bids received, not the evaluation of such bids.

UNOFFICIAL

Numbers highlighted in Yellow denote mathematical error.

Item No	Description	Unit	No. Units	6		7		8		9	
				Trinity Excavating & Construction Kansas City, KS.	Linaweaver Construction, Inc. Lansing, KS.	KAT Excavation, Inc. Bates City, MO.	Gunter Construction Co. Kansas City, KS.	Unit Price	Total Amt. Bid	Unit Price	Total Amt. Bid
ROADWAY BID ITEMS											
1	Mobilization	Lump Sum	1.0	4,193.26	4,193.26	12,000.00	12,000.00	15,650.00	15,650.00	30,252.00	30,252.00
2	Remove and Reset Mailbox	Each	1.0	479.03	479.03	150.00	150.00	400.00	400.00	500.00	500.00
3	Clearing and Grubbing	Acres	0.5	16,280.83	8,140.42	7,000.00	7,000.00	3,000.00	1,500.00	15,000.00	7,500.00
4	Unclassified Excavation & Embankment	Lump Sum	1.0	13,815.77	13,815.77	14,000.00	14,000.00	29,484.00	29,484.00	25,000.00	25,000.00
5	APWA Type 3-01 Asphaltic Concrete Surface (2" Thick)	S.Y.	180.0	42.65	7,677.00	20.00	3,600.00	27.54	4,957.20	40.00	7,200.00
6	Asphaltic or Concrete Base Course (8" Thick)	S.Y.	180.0	34.19	6,154.20	66.00	11,880.00	54.06	9,730.80	50.00	9,000.00
7	Rock Blanket (Type 2, 24" Thick) WITH Geotextile Fabric	C.Y.	80.0	87.67	7,013.60	90.00	7,200.00	52.25	4,180.00	60.00	4,800.00
8	Staking of the Right-of-Way	Lump Sum	1.0	2,754.44	2,754.44	300.00	300.00	500.00	500.00	2,000.00	2,000.00
9	Permanent Mulching (Hydro-Mulched)	Acres	0.5	2,395.16	1,197.58	2,200.00	1,100.00	2,100.00	1,050.00	2,100.00	1,050.00
10	Permanent Seeding (Hydro-Seeded)	Acres	0.5	1,437.10	718.55	2,200.00	1,100.00	2,100.00	1,050.00	2,100.00	1,050.00
11	Permanent Erosion Control Blanket (C-350)	S.Y.	320.0	5.99	1,916.80	4.00	1,280.00	4.25	1,360.00	4.00	1,280.00
12	Temporary Fertilizer, Mulch and Seed	Acres	0.5	2,634.68	1,317.34	2,000.00	1,000.00	2,600.00	1,300.00	2,000.00	1,000.00
13	Rock Ditch Checks (Type 1)	Each	3.0	211.58	634.74	1,500.00	4,500.00	275.00	825.00	1,000.00	3,000.00
14	Silt Fence	L.F.	605.0	1.50	907.50	1.50	907.50	3.00	1,815.00	1.00	605.00
15	Type 3 Barricades with Flashers (T3B)	Each	6.0	377.24	2,263.44	180.00	1,080.00	165.00	990.00	150.00	900.00
16	Traffic Control Signs	S.F.	468.0	13.17	6,163.56	17.00	7,956.00	16.50	7,722.00	12.00	5,616.00
17	Guardrail Type A	L.F.	175.0	20.36	3,563.00	20.00	3,500.00	16.75	2,931.25	18.00	3,150.00
18	50' Type A Crashworthy End Terminal (ET PLUS)	Each	4.0	2,155.65	8,622.60	2,000.00	8,000.00	1,920.00	7,680.00	2,000.00	8,000.00

Bid Opening Date and Time: February 12, 2013 at 2:05 p.m.

NOTE: This is an Unofficial bid tabulation and only reflects the initial reading of the bids received, not the evaluation of such bids.

UNOFFICIAL

Numbers highlighted in Yellow denote mathematical error.

		6		7		8		9	
		Trinity Excavating & Construction Kansas City, KS.		Linaweaver Construction, Inc. Lansing, KS.		KAT Excavation, Inc. Bates City, MO.		Gunter Construction Co. Kansas City, KS.	
Item No	Description	Unit	No. Units	Unit Price	Total Amt. Bid	Unit Price	Total Amt. Bid	Unit Price	Total Amt. Bid
CULVERT BID ITEMS									
19	Removal of Existing Culvert and Improvements for Roadway	Lump Sum	1.0	5,512.60	5,512.60	6,000.00	12,200.00	5,600.00	5,600.00
20	72" Dia. Reinforced Concrete Pipe (RCP), (Class III, Wall B)	L.F.	64.0	286.74	18,351.36	270.00	17,280.00	350.00	22,400.00
21	Filling of Open Cut under Roadway with CLSM	CY	175.0	95.91	16,784.25	80.00	14,000.00	88.00	15,400.00
22	Cast-In-Place Concrete Retaining Walls	CY	37.0	952.08	35,226.96	850.00	31,450.00	625.00	23,125.00
23	Force Account	Lump Sum	1.0	10,000.00	10,000.00	10,000.00	10,000.00	10,000.00	10,000.00
Total Amount Bid for Project (Items 1 to 23) =					\$163,408.00		\$184,108.25		\$188,428.00
Received Bid Totals 2-12-2013					\$163,408.00		\$175,350.53		\$188,428.00
Math or Extension Error Total Amount					\$0.00		-\$8,757.72		\$0.00
Extension error line (s) (Item No. Above) ??									

Notes:

1. The County reserves the right to adjust the quar

Bid Opening Date and Time: February 12, 2013 at 2:05 p.m.

NOTE: This is an Unofficial bid tabulation and only reflects the initial reading of the bids received, not the evaluation of such bids.

UNOFFICIAL

Numbers highlighted in Yellow denote mathematical error.

		10			11			12				
		Blue Nile Contractors, Inc. Claycomo, MO.			Seraf Construction, Inc. Blue Springs, MO.			Fleshman Construction, Inc. North Kansas City, MO.			Engineers Estimate	
This project is funded and Administered by Jackson County		Unit	No. Units	Total Amt. Bid	Unit Price	Total Amt. Bid	Unit Price	Total Amt. Bid	Unit Price	Total Amt. Estimated	Avg. unit \$ of 3 lowest Bids Received	
Item No	Description											
ROADWAY BID ITEMS												
1	Mobilization	Lump Sum	1.0	15,577.01	15,577.01	7,000.00	7,000.00	19,000.00	19,000.00	\$11,000.00	11,000.00	8,515.17
2	Remove and Reset Mailbox	Each	1.0	344.75	344.75	410.00	410.00	500.00	500.00	\$400.00	400.00	200.00
3	Clearing and Grubbing	Acres	0.5	7,828.82	3,914.41	10,690.00	5,345.00	10,000.00	5,000.00	\$13,500.00	6,750.00	6,400.00
4	Unclassified Excavation & Embankment	Lump Sum	1.0	6,623.21	6,623.21	21,000.00	21,000.00	25,000.00	25,000.00	\$13,000.00	13,000.00	6,702.00
5	APWA Type 3-01 Asphaltic Concrete Surface (2" Thick)	S.Y.	180.0	20.72	3,729.60	38.00	6,840.00	21.00	3,780.00	\$25.00	4,500.00	26.50
6	Asphaltic or Concrete Base Course (3" Thick)	S.Y.	180.0	72.00	12,960.00	61.00	10,980.00	50.00	9,000.00	\$50.00	9,000.00	56.83
7	Rock Blanket (Type 2, 24" Thick) WITH Geotextile Fabric	C.Y.	80.0	72.89	5,831.20	112.00	8,960.00	65.00	5,200.00	\$60.00	4,800.00	79.17
8	Staking of the Right-of-Way	Lump Sum	1.0	2,184.00	2,184.00	3,380.00	3,380.00	1,500.00	1,500.00	\$1,500.00	1,500.00	1,511.67
9	Permanent Mulching (Hydro-Mulched)	Acres	0.5	2,610.00	1,305.00	2,270.00	1,135.00	3,000.00	1,500.00	\$4,500.00	2,250.00	2,030.00
10	Permanent Seeding (Hydro-Seeded)	Acres	0.5	2,610.00	1,305.00	2,270.00	1,135.00	4,000.00	2,000.00	\$4,300.00	2,150.00	2,030.00
11	Permanent Erosion Control Blanket (C-350)	S.Y.	320.0	7.20	2,304.00	4.15	1,328.00	5.50	1,760.00	\$8.00	2,560.00	5.97
12	Temporary Fertilizer, Mulch and Seed	Acres	0.5	1,440.00	720.00	2,100.00	1,050.00	2,400.00	1,200.00	\$4,200.00	2,100.00	2,100.00
13	Rock Ditch Checks (Type 1)	Each	3.0	1,021.98	3,065.94	615.00	1,845.00	1,200.00	3,600.00	\$1,000.00	3,000.00	408.33
14	Silt Fence	L.F.	605.0	2.38	1,439.90	2.75	1,663.75	3.00	1,815.00	\$5.50	3,327.50	1.77
15	Type 3 Barricades with Flashers (T3B)	Each	6.0	596.65	3,579.90	256.00	1,536.00	300.00	1,800.00	\$350.00	2,100.00	316.67
16	Traffic Control Signs	S.F.	488.0	23.01	10,766.68	22.75	10,647.00	24.00	11,232.00	\$12.00	5,616.00	14.33
17	Guardrail Type A	L.F.	175.0	53.70	9,397.50	21.15	3,701.25	22.00	3,850.00	\$25.00	4,375.00	18.40
18	Type A Crashworthy End Terminal (ET PLUS)	Each	4.0	9,696.00	38,784.00	2,089.00	8,356.00	2,200.00	8,800.00	\$3,000.00	12,000.00	1,966.67

Bid Opening Date and Time: February 12, 2013 at 2:05 p.m.

NOTE: This is an Unofficial bid tabulation and only reflects the initial reading of the bids received, not the evaluation of such bids.

UNOFFICIAL

Numbers highlighted in Yellow denote mathematical error.

Item No.	Description	Unit	No. Units	10		11		12		Avg. unit \$ of 3 lowest Bids Received	
				Blue Nile Contractors, Inc. Claycomo, MO.	Sarat Construction, Inc. Blue Springs, MO.	Fleshman Construction, Inc. North Kansas City, MO.	Engineers Estimate				
				Unit Price	Total Amt. Bid	Unit Price	Total Amt. Bid	Unit Price	Total Amt. Estimated		
CULVERT BID ITEMS											
19	Removal of Existing Culvert and Improvements for Roadway	Lump Sum	1.0	4,283.21	4,283.21	16,640.00	16,640.00	26,000.00	\$10,000.00	10,000.00	5,009.33
20	72" Dia. Reinforced Concrete Pipe (RCP), (Class III, Wall B)	L.F.	64.0	299.55	19,171.20	22,976.00	22,976.00	380.00	\$480.00	30,720.00	280.33
21	Filling of Open Cut under Roadway with CLSM	CY	175.0	139.20	24,360.00	22,400.00	22,400.00	95.00	\$150.00	26,250.00	87.67
22	Cast-In-Place Concrete Retaining Walls	CY	37.0	321.68	11,902.16	787.00	29,119.00	600.00	\$500.00	18,500.00	643.33
23	Force Account	Lump Sum	1.0	10,000.00	10,000.00	10,000.00	10,000.00	10,000.00	\$10,000.00	10,000.00	10,000.00
Total Amount Bid for Project (Items 1 to 23) =					\$193,550.67		\$197,447.00			\$205,682.00	

Received Bid Totals 2-12-2013

Math or Extension Error Total Amount

Extension error line (s) (Item No., Above) ??

\$195,312.63
\$1,761.96
17

\$197,447.00
\$0.00

\$205,682.00
\$0.00

Notes:

- The County reserves the right to adjust the quar

Confirmation Memorandum
Jackson County Missouri - Department of Public Works

TO: Dana Tadlock
 Taxpayer Services Supervisor
 Collection Department

FROM: Chris Jenkins
 Project Manager
 Engineering Division

DATE: February 13, 2013

SUBJECT: Request for Tax Clearance
 R.D. Mize Road Culvert Replacement
 Project No. 3123 - Bid Number PW 01-2013

In accordance with County Ordinance 1208, Sections 1003.01 and 1070, the Director of Public Works requests that the below listed Company and/or individuals be verified as being listed and assessed on the County tax rolls, and is in no way delinquent on any taxes payable to the County.

Ground Breaking Excavation & Utilities, LLC
 2400 E. 205th Street
 Pleasant Hill, MO. 64080

Information needed: Type of tax due, amount of tax, and if account is paid or unpaid. (If account is unpaid please include a printout of statement). Place amount paid/amount due under type that applies.

<u>Type of Tax</u>	<u>Amount Paid</u>	<u>Amount Due</u>
BUSINESS	_____	\$ _____
MERCHANTS	_____	\$ _____
INDIVIDUAL	_____	\$ _____
REAL ESTATE	_____	\$ _____

Denise Reynolds

 Signature (Person Verifying)

Date: 2/13/13

CC: Construction Contract File

JACKSON COUNTY PUBLIC WORKS
R.D. MIZE ROAD CULVERT REPLACEMENT

COUNTY PROJECT NO. 3123
COUNTY BID NO. PW 01-2013

LIST OF INTENDED SUBCONTRACTORS

Bidder Name: Ground Breaking Excavation & Utilities, LLC

Will subcontractors be used to complete the work? Yes No

If yes, complete this form and submit it with your bid.

Subcontractor No. 1

Name: Mar-Jim Contracting, LLC

Address: 14021 Botts Road

City & Zip Code: Grandview, MO 64030

Telephone No: 816-214-5393 **Fax No:** 816-214-6131

Description of work to be performed (include Bid Item Number, and Bid Item):

17-Guardrail Type A, 18-50' Type A Crashworthy End Terminal

Dollar Amount: \$ 10,400.86

DBE: Yes No

Subcontractor No. 2

Name: Welch Silt Fence & Erosion Control, LLC

Address: PO Box 526

City & Zip Code: Peculiar, MO 64078

Telephone No: 816-651-7358 **Fax No:** 816-779-4800

Description of work to be performed (include Bid Item Number, and Bid Item):

9-Permanent Mulching, 10-Permanent Seeding, 11-Permanent Erosion Control Blanket,

12-Temporary Fertilizer, Mulch, & Seed, 13-Rock Ditch Checks, 14- Silt Fence

Dollar Amount: \$ 6,413.50

DBE: Yes No

(List of Subcontractors Continued)

Subcontractor No. 3

Name: Streetwise, Inc.

Address: 4600 E 142nd St

City & Zip Code: Grandview, MO 64030

Telephone No: 816-331-2355

Fax No: 816-331-1355

Description of work to be performed (include Bid Item Number, and Bid Item):

15-Type 3 Barricades with Flashers, 16-Traffic Control Signs, 24-4" White Edge
Line,

Dollar Amount: \$ 8,598.00

DBE: Yes x No

Subcontractor No. 4

Name: Metro Asphalt

Address: 3811 N Cobbler

City & Zip Code: Independence, MO 64058

Telephone No: 816-836-7400

Fax No: 816-257-2853

Description of work to be performed (include Bid Item Number, and Bid Item):

Asphalt Paving

Dollar Amount: \$ 11,810.00

DBE: Yes x No

Missouri Secretary of State, Jason Kander

SOS Home :: Business Services :: Business Entity Search

- Search
- By Business Name
 - By Charter Number
 - By Registered Agent
 - For New Corporations
- Verify
- Verify Certification Registration Report
 - File Online File Fictitious Name Registration
 - File Online Renew Online File LLC Registration
 - File Online Online Orders
 - Register for Online Orders
 - Order Good Standing
 - Order Certified Documents

Filed Documents

Date: 2/13/2013 (Click above to view filed documents that are available.)

Business Name History

Name	Name Type
Ground Breaking Excavation & Utilities, LLC	Legal

Limited Liability Company - Domestic - Information

Charter Number: LC1132708
Status: Active
Entity Creation Date: 4/7/2011 11:28:14 AM
Expiration Date: Perpetual

Registered Agent

Agent Name: Weinhaus, Andrew J
Office Address: 8000 Maryland Avenue Suite 1150 Clayton MO 63105

Mailing Address:

Organizers

Name: Andrew J Weinhaus
Address: 8000 Maryland Avenue, Suite 1150 Clayton MO 63105

Commissions Phone: (573) 751-2783 Toll Free: (866) 223-6535	Corporations Phone: (573) 751-4153 Toll Free: (866) 223-6535	UCC Office Phone: (573) 751-4628 Toll Free: (866) 223-6535
--	---	---

600 West Main Street
 Jefferson City, MO 65101
 Main Office: (573) 751-4936 



State of Missouri
Robin Carnahan, Secretary of State

File Number: 201109780568

LC1132708

Date Filed: 04/07/2011

Robin Carnahan

Secretary of State

Articles of Organization

1. The name of the limited liability company is:

Ground Breaking Excavation & Utilities, LLC

2. The purpose(s) for which the limited liability company is organized:

The transaction of any lawful business for which a limited liability company may be organized under the Missouri Limited Liability Company Act, Chapter 347 RSMo.

3. The name and address of the limited liability company's registered agent in Missouri is:

Andrew J Weinhaus

Name

8000 Maryland Avenue, Suite 1150, Clayton MO 63105

Address

4. The management of the limited liability company is:

Manager

Member

5. The duration (period of existence) for this limited liability company is:

Perpetual

6. The name(s) and street address(es) of each organizer:

Andrew J Weinhaus, 8000 Maryland Avenue, Suite 1150, Clayton MO 63105

In Affirmation thereof, the facts stated above are true and correct:

(The undersigned understands that false statements made in this filing are subject to the penalties provided under Section 575.040, RSMo)

Andrew J Weinhaus

(Organizer Name)

State of Missouri



Robin Carnahan
Secretary of State

CERTIFICATE OF ORGANIZATION

WHEREAS,

Ground Breaking Excavation & Utilities, LLC
LC1132708

filed its Articles of Organization with this office on the April 7, 2011, and that filing was found to conform to the Missouri Limited Liability Company Act.

NOW, THEREFORE, I, ROBIN CARNAHAN, Secretary of State of the State of Missouri, do by virtue of the authority vested in me by law, do certify and declare that on the April 7, 2011, the above entity is a Limited Liability Company, organized in this state and entitled to any rights granted to Limited Liability Companies.

IN TESTIMONY WHEREOF, I hereunto set my hand and cause to be affixed the GREAT SEAL of the State of Missouri. Done at the City of Jefferson, this April 7, 2011.

Robin Carnahan

Secretary of State

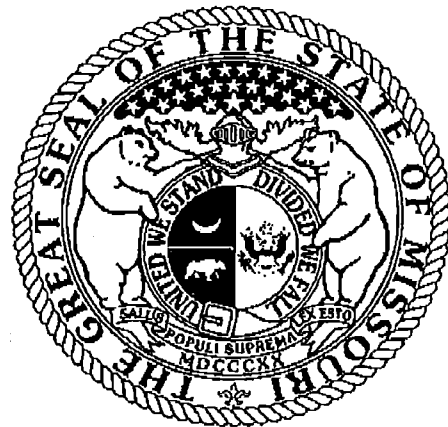

Certificate of Compliance

Ground Breaking Excavation and Utilities, LLC

Whose Affirmative Action Program has been found to be in compliance with Chapter 6, Jackson County Code, which prohibits employment practices and promotes equal employment opportunity by contract members of the community.

This certificate is effective for a term of one year beginning its date of execution.

Executed this

1st

January

2013



Tom Wyszch

COMPLIANCE REVIEW OFFICER
JACKSON COUNTY, MISSOURI

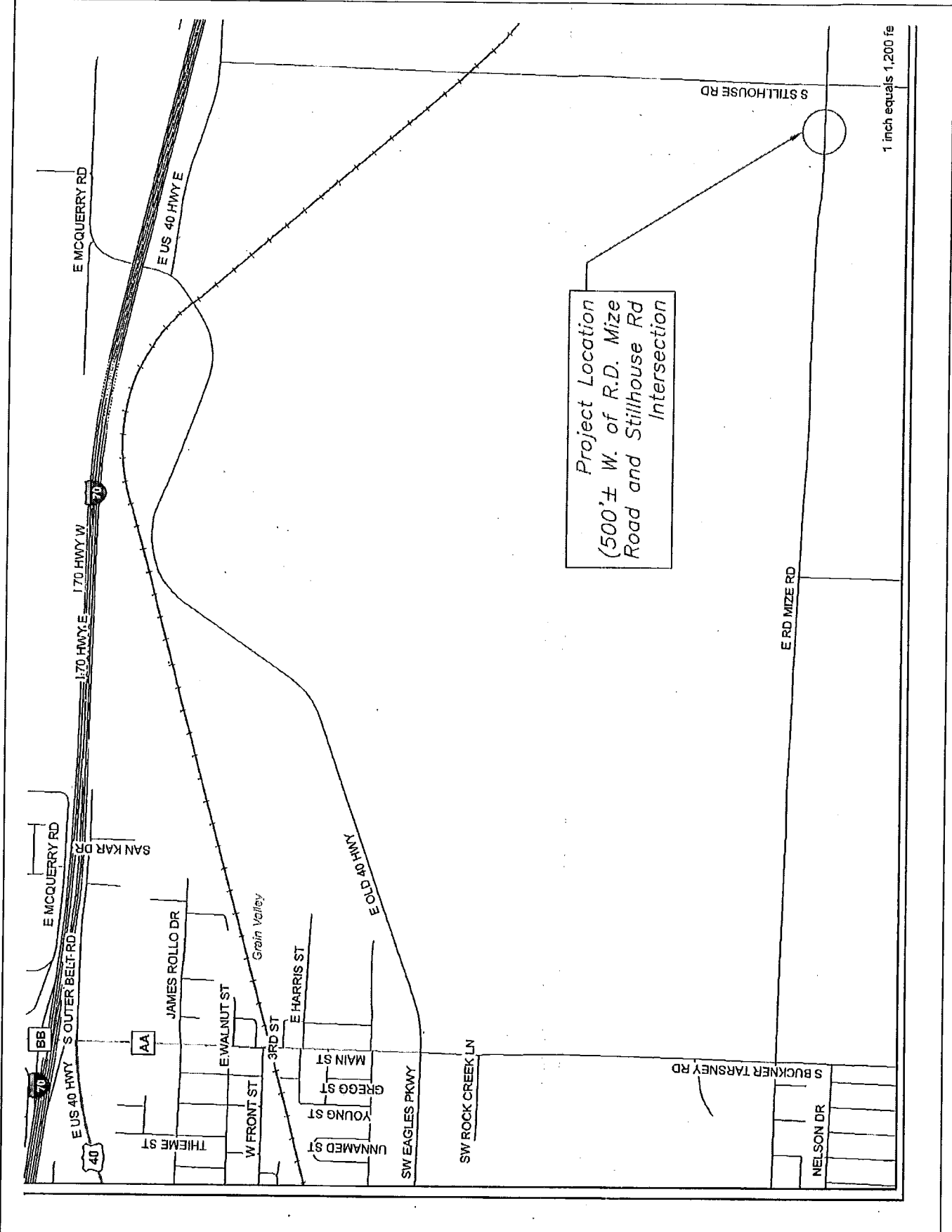

Project Location
 (500'± W. of R.D. Mize
 Road and Stillhouse Rd
 Intersection)

1 inch equals 1,200 feet