

CUSTOMER APPROVAL

PRINT NAME _____

SIGNATURE _____ DATE _____

FARBER
SPECIALTY VEHICLES
7052 AMERICANA PARKWAY
COLUMBUS, OH 43068
USA

REVISION HISTORY		DATE	DESCRIPTION

BCCY	DESIGN ENGINEER	BCN- BH	1-16-16
EXT. APPROVAL	EXT. ENGINEER	G. CAIN	
	EXT. VSR. APPROVAL		

CUSTOMER		FSV BODY 16'	
TITLE		US COMMUNITIES	
SCALE	1:24	15588	S.1

MODEL: FSV BODY 18 MOBILE DENTAL VEHICLE

Body 18', 27' overall length, 6.7L diesel powered, 19,500 GVWR, 40 gallon fuel tank, 102" exterior width, aluminum/galvanized steel body construction. Class "A" fire rated fiberglass interior wall and ceiling finish, commercial vinyl flooring. Roof air conditioner, electric heat, magnetic/hydraulic 12V circuit breakers, electronic master disconnect switches for main and auxiliary battery system, 36' shoreline. Custom cabinets cut using CNC router.

Space is designed for efficiency and ergonomic function for an optimized workflow. Floorplan includes one operatory, intake/reception area, waiting area and sterilization area. Custom options for restroom, ADA accessibility, testing equipment, additional entrances and awnings. Alternative length options available. 4-wheel drive option available. See price sheet for details.



**MODEL: FSV BODY 18
COMMAND - CSI - EVIDENCE COLLECTION**

Body 18'27" overall length, 6.84L Triton E.F.I. V-10 powered, 19,500 GVWR, 40 gallon fuel tank, 102" exterior width, aluminum/galvanized steel body construction. Class "A" fire rated fiberglass interior wall and ceiling finish, commercial floor finish. Roof air conditioner, electric heat, magnetic/hydraulic 12V and 120V circuit breakers, electronic master disconnect switches for main and auxiliary battery system, 36' shoreline. Custom cabinets cut using CNC router. 4-wheel drive and diesel options available.



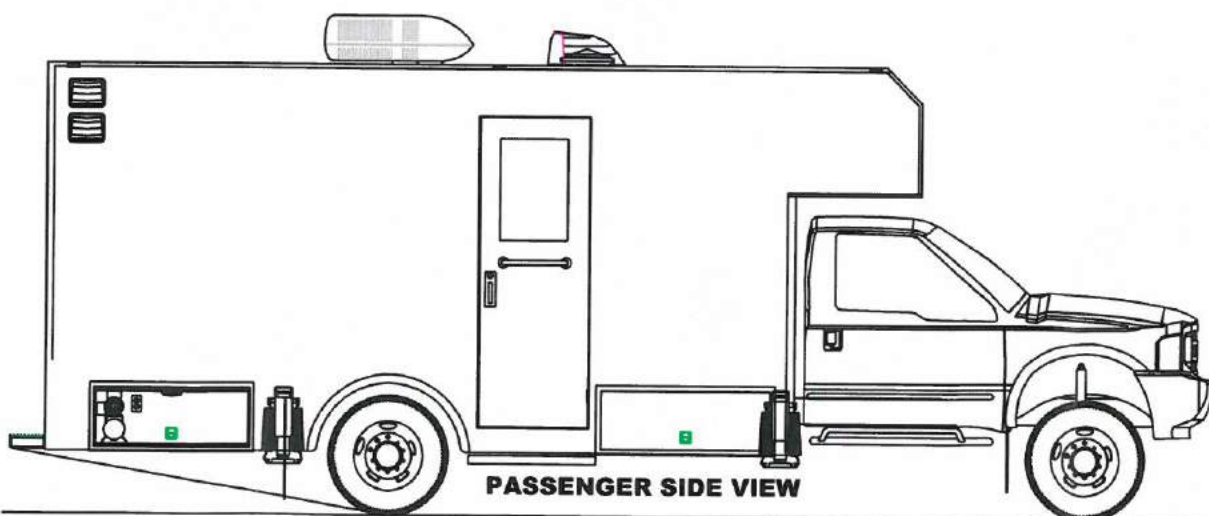
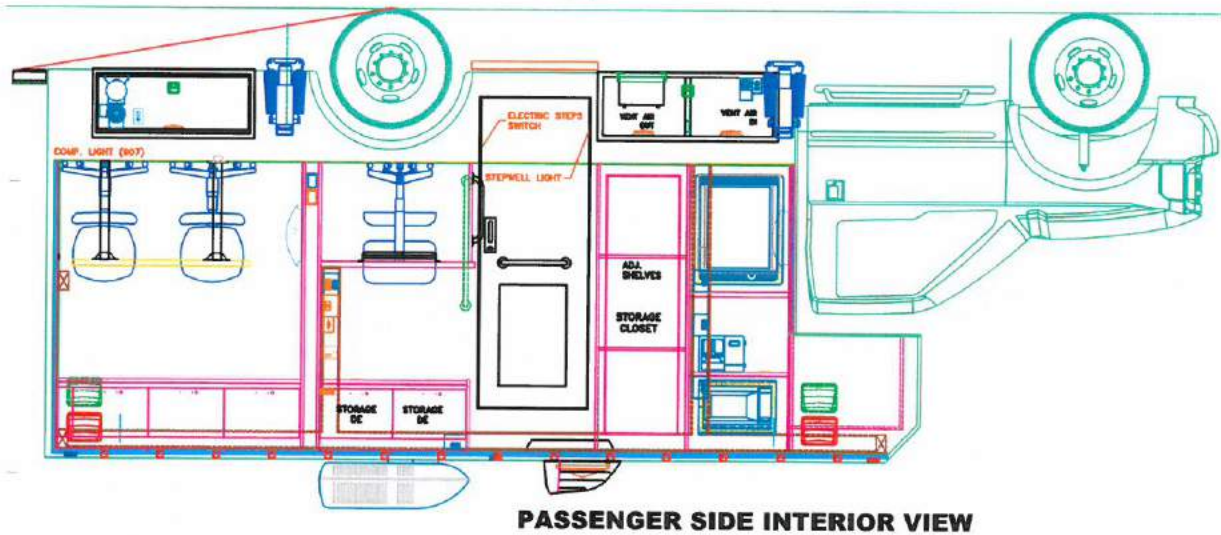
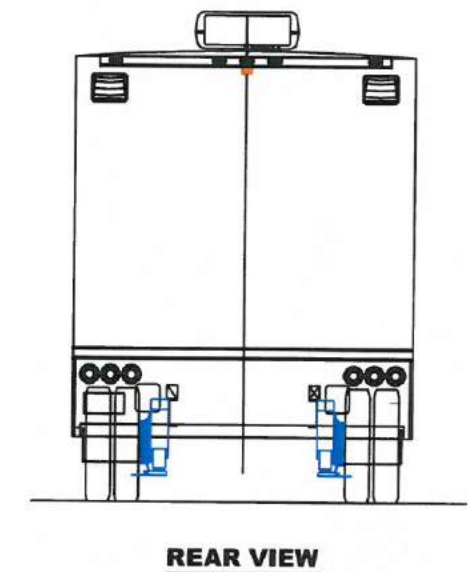
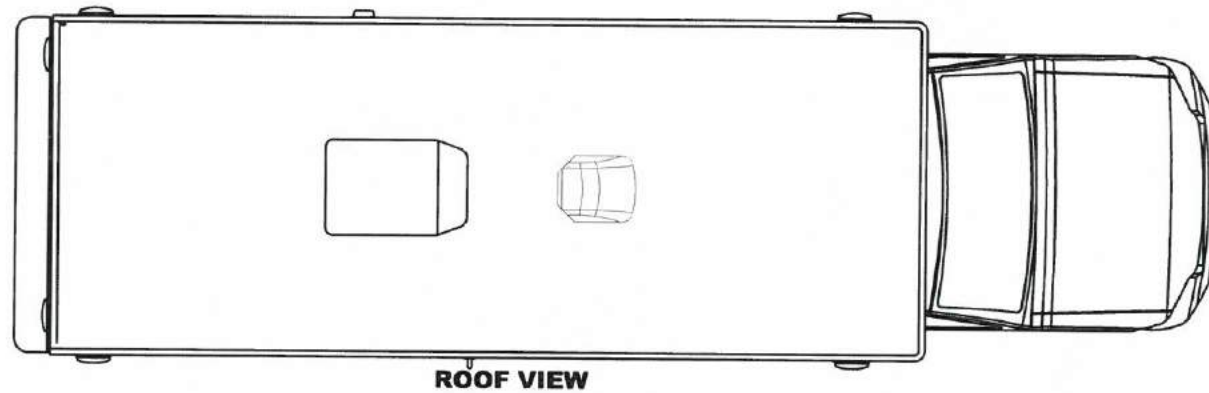
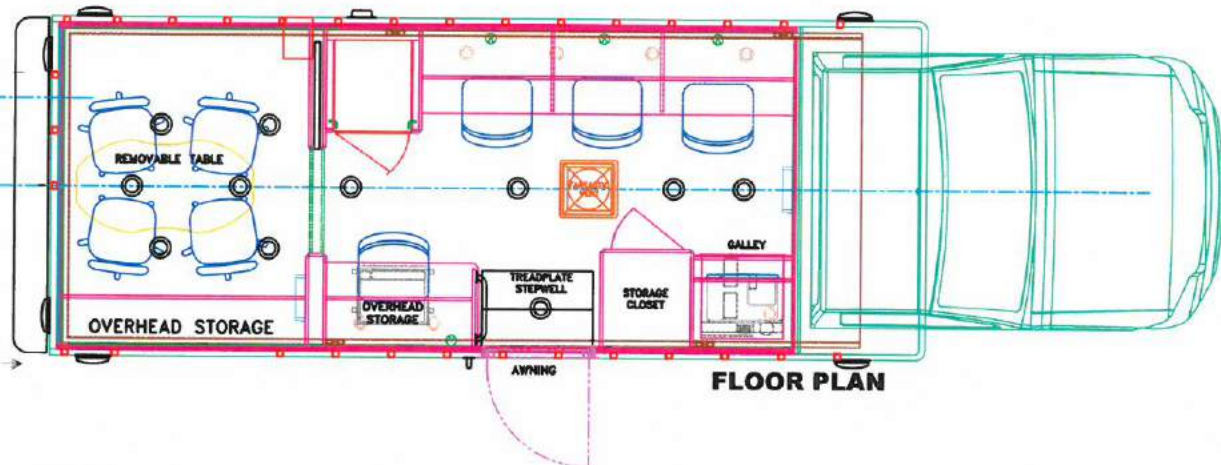
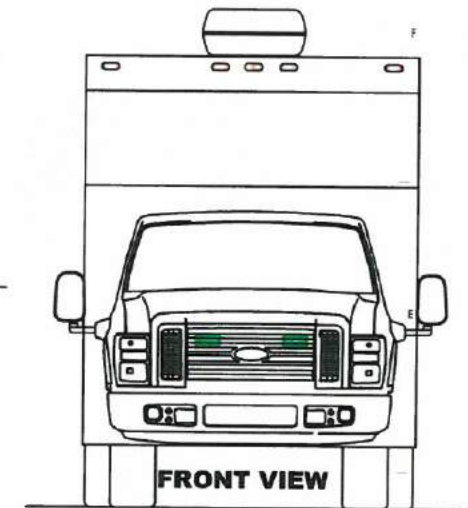
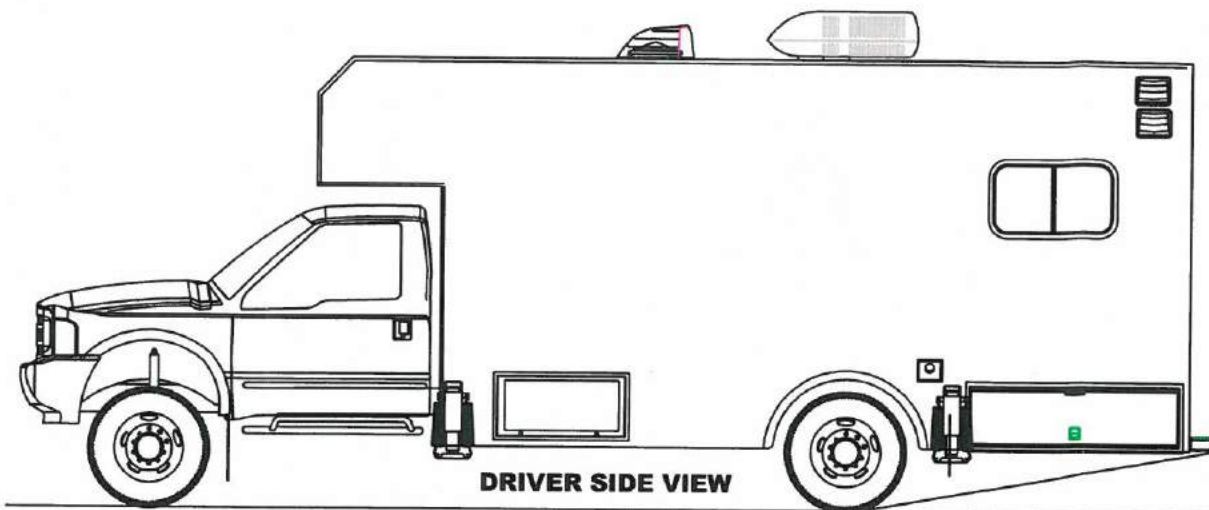
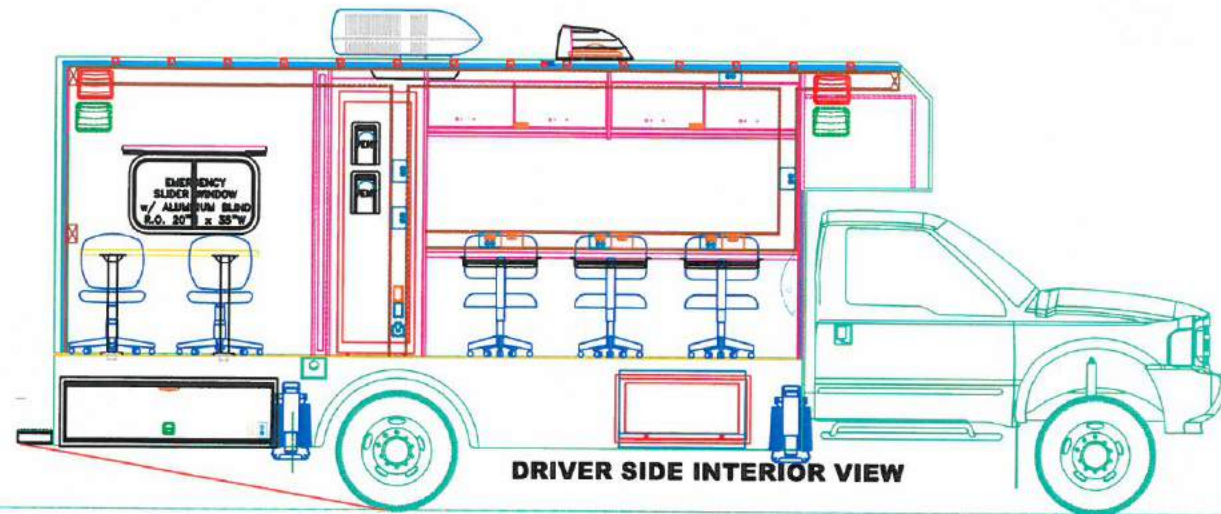

CUSTOMER APPROVAL
PRINT NAME
SIGNATURE

FARBER
SPECIALTY VEHICLES
7052 AMERICANA PARKWAY
COLUMBUS, OH 43068
USA

REVISION HISTORY

REV.	DESCRIPTION	ENGINEER	DATE

BODY	DESIGN ENGINEER	B. HARLAN	1-14-16
CHASSIS	ELEC. ENGINEER		
	ENG. MGR. APPROVAL		
	SALES		
	PROPRIETARY AND CONFIDENTIAL		
	THE INFORMATION CONTAINED IN THIS		
	DRAWING IS THE SOLE PROPERTY OF		
	FARBER SPECIALTY VEHICLE. ANY		
	REPRODUCTION IN PART OR AS A WHOLE		
	WITHOUT THE WRITTEN PERMISSION OF		
	FARBER SPECIALTY VEHICLE IS PROHIBITED.		

CUSTOMER		FSV BODY 18'	
TITLE		US COMMUNITIES	
SHEET SIZE	SCALE	UNIT NO.	REV
D	1:24	16006	

MODEL: FSV BODY 20
MOBILE MEDICAL HEALTH VEHICLE

20'Box, 29' overall length, 260 hp diesel engine, 26,000 GVWR, Allison 2500 RDS automatic 5 speed, 60 gallon fuel tank, two air conditioners. Magnetic/hydraulic 12V circuit breakers, electronic master disconnect switches for main and auxiliary battery system, 36' shoreline. Commercial /medical grade vinyl flooring. Electric heat, automatic computerized hydraulic leveling/stabilizing system, magnetic/hydraulic 12V circuit breakers, electronic master disconnect switches for main and auxiliary battery system, 90 amp. converter, 36' shoreline. Custom cabinets cut using CNC router.

Space is designed for efficiency and ergonomic function for an optimized workflow. Floorplan includes one or two exam rooms, intake/reception area, waiting area and lab area. Custom options for restroom, ADA accessibility, testing equipment, additional entrances and awnings. See price sheet for details. Alternative length options available.



**MODEL: FSV BODY 24
COMMAND – COMMUNICATIONS – EOD**

24' Box, 33' overall length, 260 hp diesel engine, 26,000 GVWR, Allison 3000 EVS automatic 6 speed, 60 gallon fuel tank, two air conditioners, interior and exterior LED light package, scene lights. Magnetic/hydraulic 12V and 120V circuit breakers, electronic master disconnect switches for main and auxiliary battery system, 36' shoreline. Four workstations, conference room, galley with under counter refrigerator, coffee maker and microwave. Custom cabinets cut using CNC router. Whiteboard finish on overhead cabinet doors.

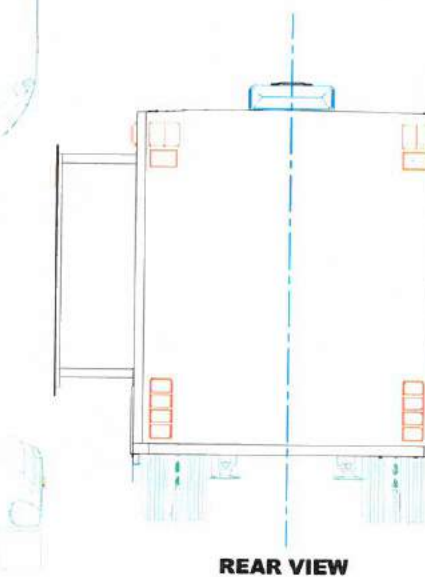
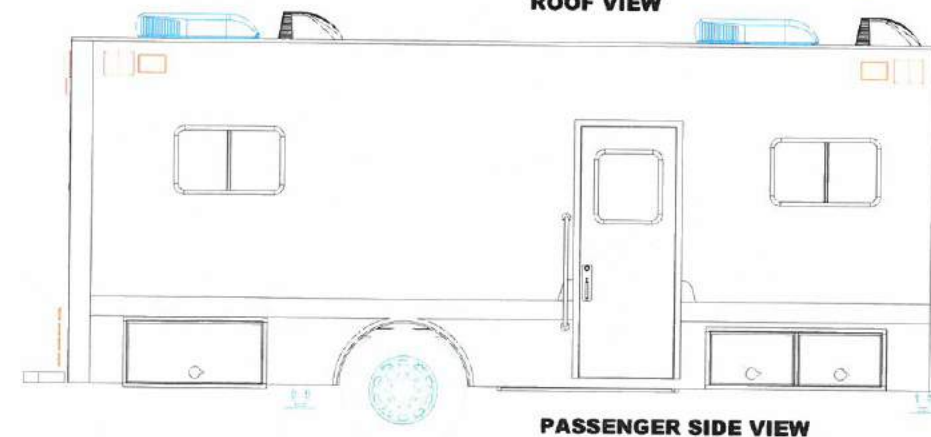
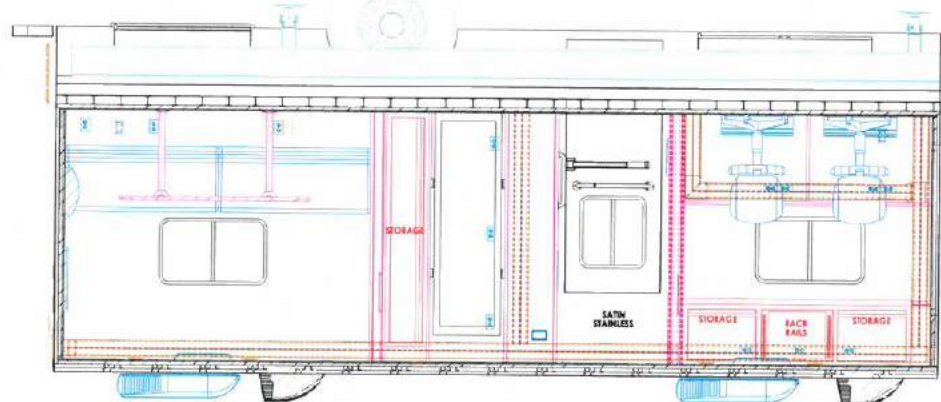
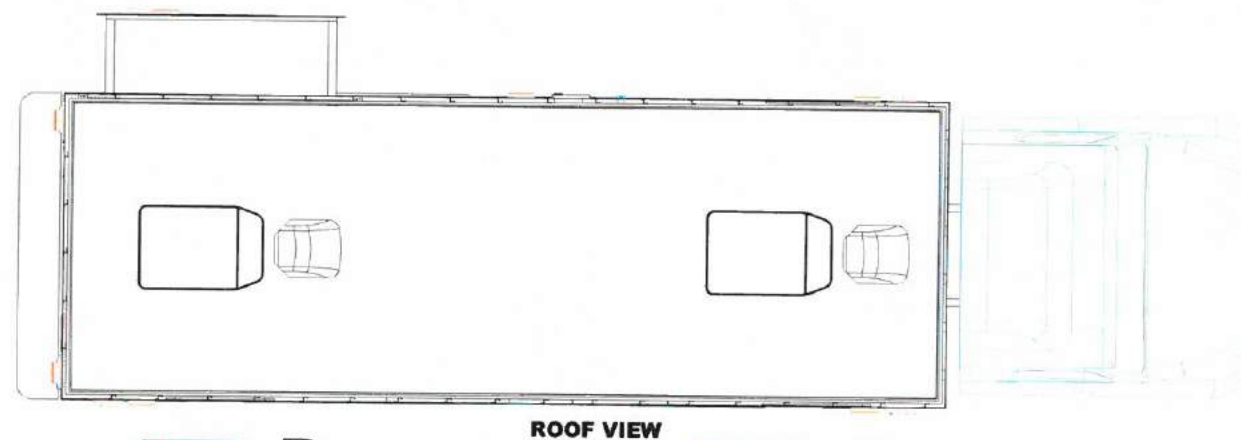
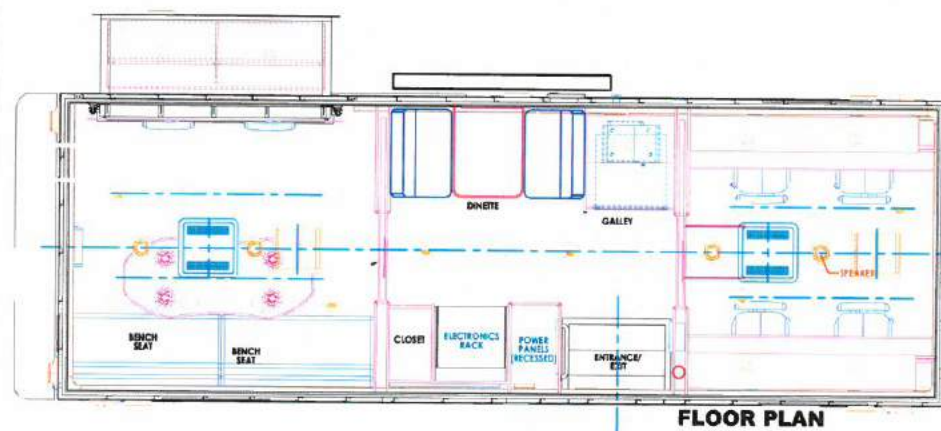
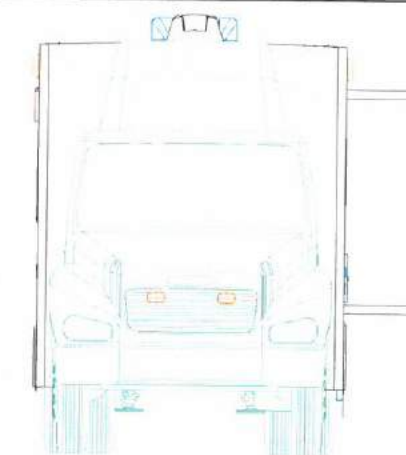
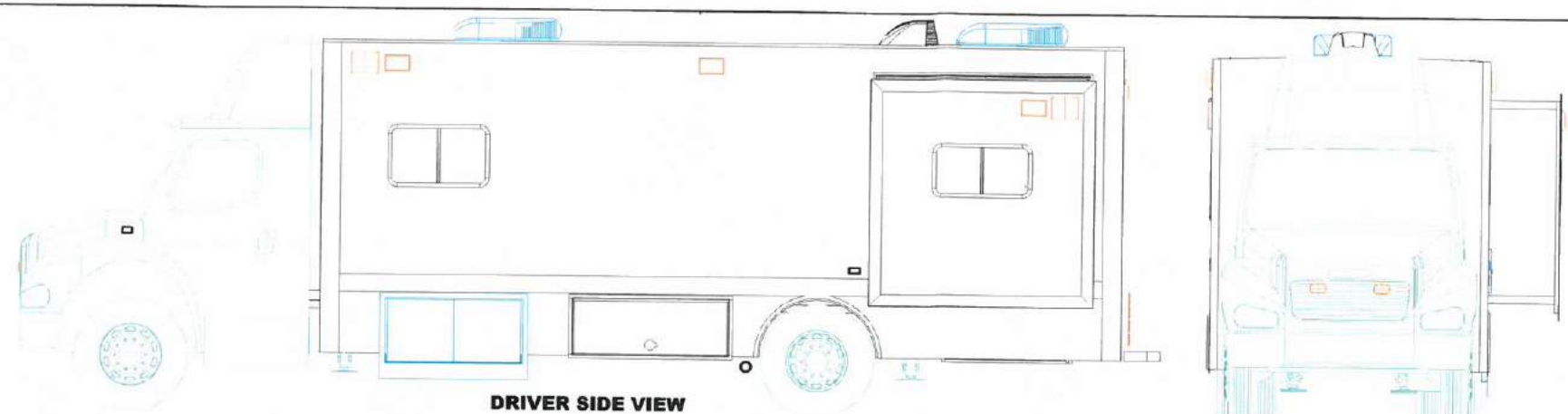
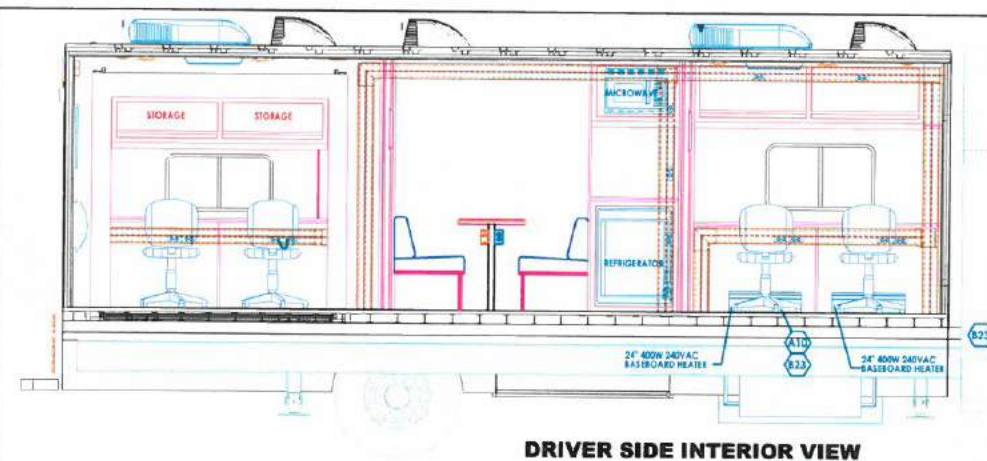

[illegible]

**MODEL: FSV BODY 30
COMMAND – COMMUNICATIONS – EOD –**

39' overall length, 325 hp diesel engine, 33,000 GVWR, Allison 3000 EVS automatic 6 speed air brake package, 60 gallon fuel tank, three air conditioners, group 31 deep-cycle batteries, interior LED light package, magnetic/hydraulic 12V and 120V circuit breakers, electronic master disconnect switches for main and auxiliary battery system, 36' shoreline. Six workstations, conference room, Custom cabinets cut using CNC router. Whiteboard finish on overhead cabinet doors. Optional tandem axle available.



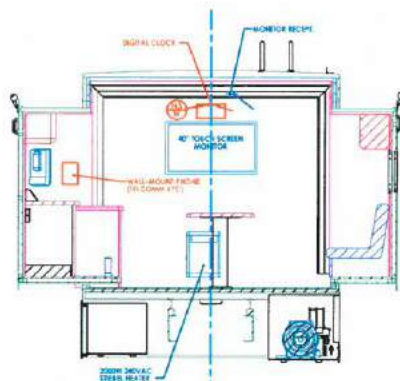
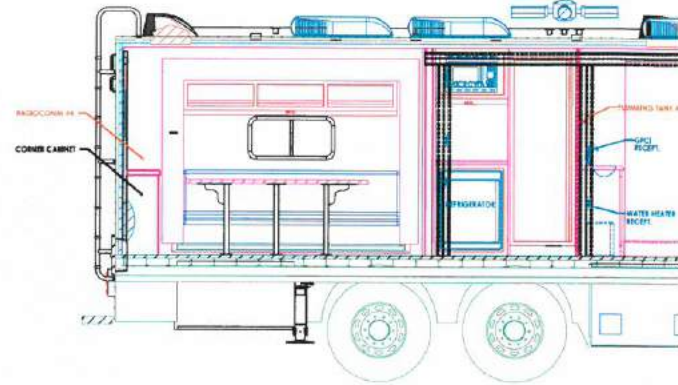
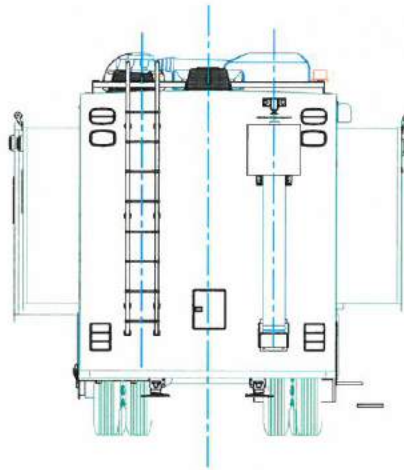

SECTION C-C
SCALE 1 : 24

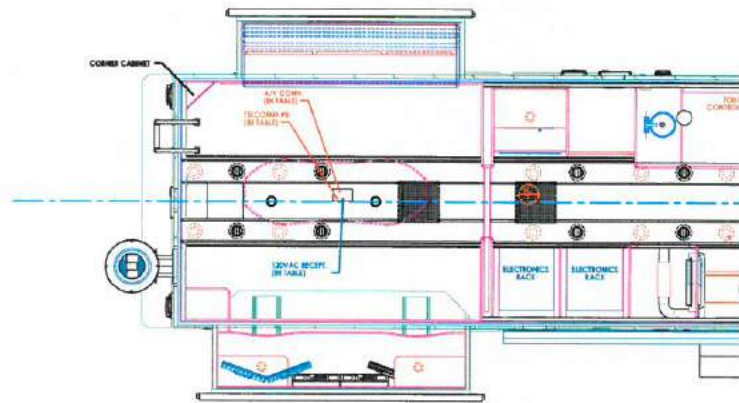

C ←

→ D

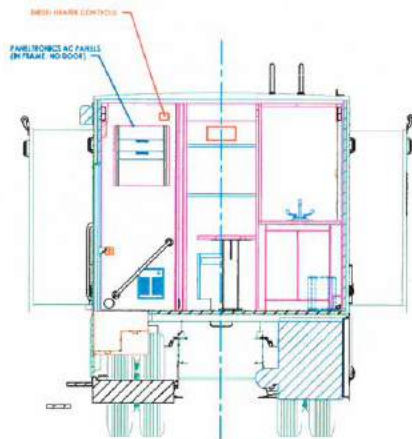

SECTION D-D
SCALE 1 : 24

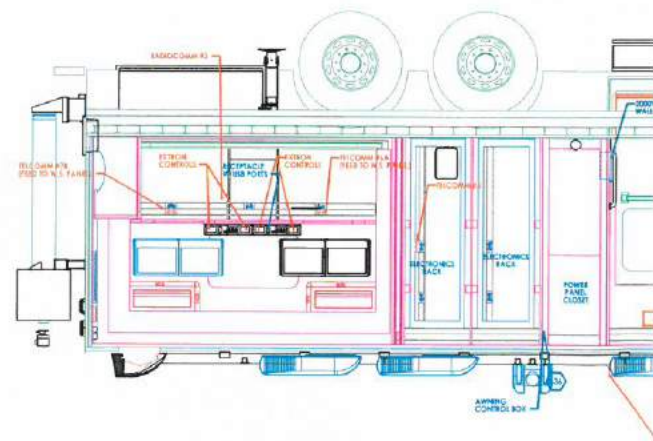

MODEL: FSV STEPVAN 20
Mobile Command

29' 6" overall length, Freightliner MT-55 chassis, Cummins 6.7L, 260HP diesel front engine, 26,000 GVWR. Allison 2500 series automatic transmission. Aluminum body construction with chrome front bumper, air brake package with ABS, 60 gallon fuel tank, power steering, remote control, heated exterior cab mirrors, two dashboard controlled electric windshield fans, Magnum high-back swivel driver and passenger seats, overhead storage cabinets. Commercial grade vinyl flooring two roof air conditioners, electric heat, 12V magnetic/hydraulic circuit breakers, electronic master disconnect switches for main and auxiliary battery system, 90 amp. converter, 36' shoreline. Custom cabinets cut using CNC router.

Space is designed for efficiency and ergonomic function for an optimized workflow. Custom options for restroom, additional entrances and awnings. See price sheet for details.



**MODEL: FSV BODY 32
BOMB RESPONSE - COMMAND**

40' overall length, 330 hp Cummins ISC diesel engine, 54,600 GVWR, 40,000 lb. tandem rear axle w/ airliner suspension, 14,600 lb. front suspension, Allison 3000 EVS automatic 6 speed, driver controlled traction differential, 270 amp alternator, air brake package w/ air dryer heater, dual 50 gallon fuel tanks w/ heaters, chromed steel front bumper, aluminum outside wheels, air horns, power heated mirrors, electric door locks, air suspension driver and passenger seats w/ armrests, adjustable tilt steering column, AM/FM/CD/MP3 radio. Aluminum exterior skin, three air conditioners, interior and interior LED light package, magnetic/hydraulic 12V and 120V circuit breakers, electronic master disconnect switches for main and auxiliary battery system, 36' shoreline. Up to six workstations available.



MODEL: FSV STEPVAN 26
Mobile Command

35' 6" overall length, Freightliner MT-55 chassis, Cummins 6.7L, 300HP diesel front engine, 26,000 GVWR. Allison 2200 series automatic transmission. Aluminum body construction with chrome front bumper, air brake package with ABS, 60 gallon fuel tank, power steering, remote control, heated exterior cab mirrors, two dashboard controlled electric windshield fans, Magnum high-back swivel driver and passenger seats, overhead storage cabinets. Commercial/medical grade vinyl flooring three roof air conditioners, electric heat, 12V magnetic/hydraulic circuit breakers, electronic master disconnect switches for main and auxiliary battery system, 90 amp. converter, 36' shoreline. Custom cabinets cut using CNC router.

Space is designed for efficiency and ergonomic function for an optimized workflow. Floor plan includes four blood draw tables, screening room, waiting area and lab area. Custom options for restroom, additional entrances and awnings. See price sheet for details.



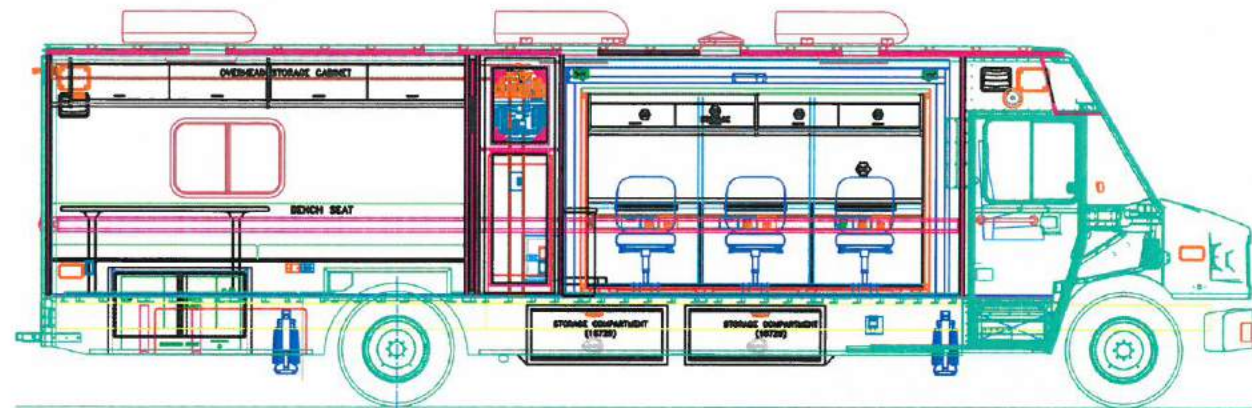

DRIVER SIDE INTERIOR VIEW

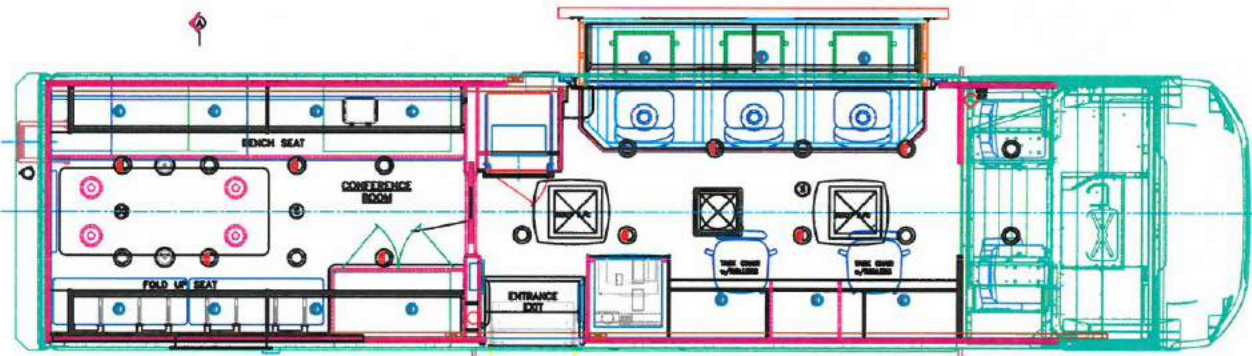

FLOOR PLAN

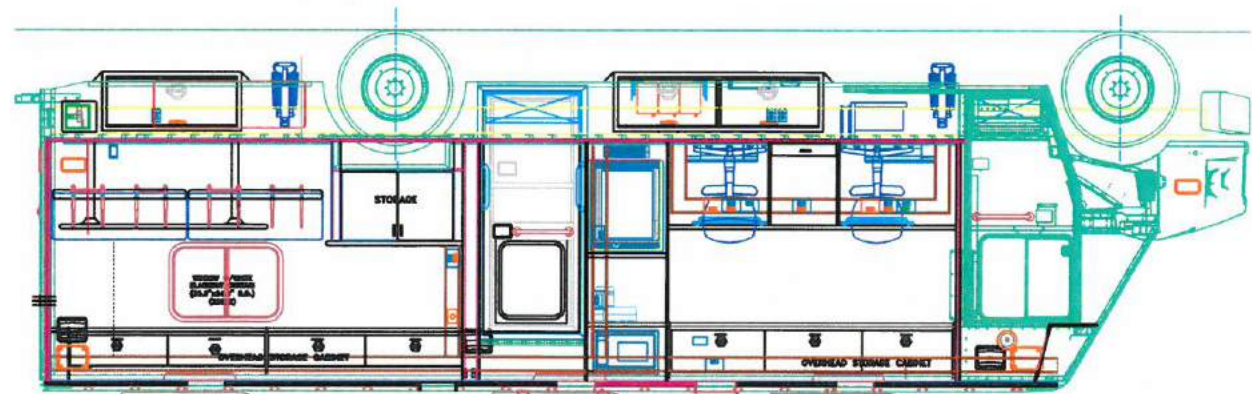

PASSENGER SIDE INTERIOR VIEW

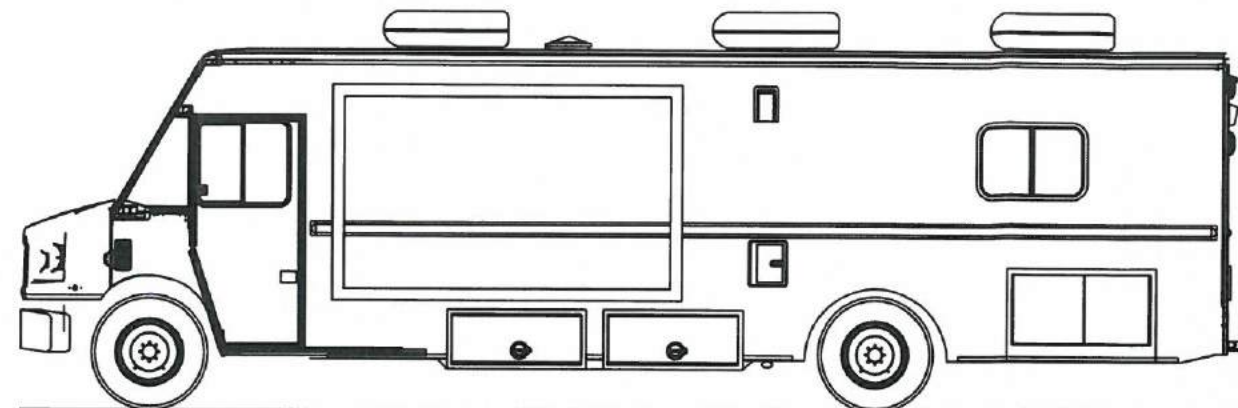

DRIVER SIDE VIEW

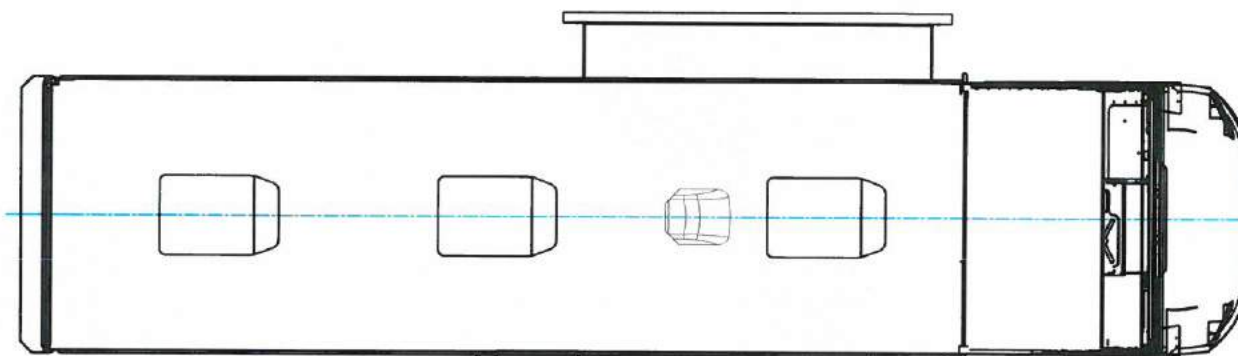

ROOF VIEW



PASSENGER SIDE VIEW

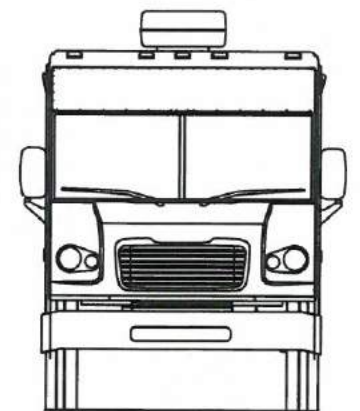

FRONT VIEW

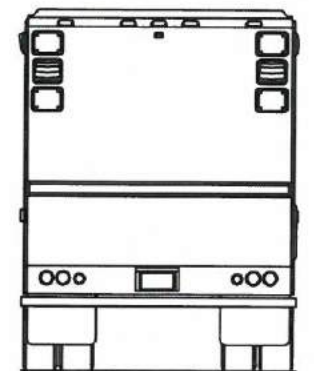

REAR VIEW

CUSTOMER APPROVAL

PRINT NAME

DATE

FARBER
SPECIALTY VEHICLES
7052 AMERICANA PARKWAY
COLUMBUS, OH 43068
USA

BODY

CHASSIS

UNLESS OTHERWISE SPECIFIED:
ALL DIMENSIONS IN INCHES
DIMENSIONS IN PARENTHESIS ARE
TOLERANCES
DIMENSIONS IN SQUARE INCHES
DIMENSIONS IN CIRCLES ARE
DIMENSIONS IN SQUARE FEET

DESIGN ENGINEER: CHERHART-BH

ELEC ENGINEER: T. DENNIS

SALES: T. GOODYEAR

PROPRIETARY AND CONFIDENTIAL
ALL RIGHTS RESERVED
NO PART OF THIS DOCUMENT
SHALL BE REPRODUCED OR
TRANSMITTED IN ANY FORM
OR BY ANY MEANS, ELECTRONIC
OR MECHANICAL, INCLUDING
PHOTOCOPYING, RECORDING, OR
BY ANY INFORMATION STORAGE
AND RETRIEVAL SYSTEM, WITHOUT
THE WRITTEN PERMISSION OF
FARBER SPECIALTY VEHICLES

CUSTOMER

FSV STEPVAN 26

TITLE: US COMMUNITIES

SHEET NO.

E

SCALE

15612

UNIT NO.

15612

REV
A.5

SHEET 1 OF 1

MODEL: FSV STEPVAN 30
Mobile Command

39' 6" overall length, Freightliner MT-55 chassis, Cummins 6.7L, 300HP diesel front engine, 30,000 GVWR. Allison 2200 series automatic transmission. Aluminum body construction with chrome front bumper, air brake package with ABS, 60 gallon fuel tank, power steering, remote control, heated exterior cab mirrors, two dashboard controlled electric windshield fans, Magnum high-back swivel driver and passenger seats, overhead storage cabinets. Commercial grade vinyl flooring two roof air conditioners, electric heat, 12V magnetic/hydraulic circuit breakers, electronic master disconnect switches for main and auxiliary battery system, 90 amp. converter, 36' shoreline. Custom cabinets cut using CNC router.

Space is designed for efficiency and ergonomic function for an optimized workflow. Custom options for restroom, additional entrances and awnings. See price sheet for details.



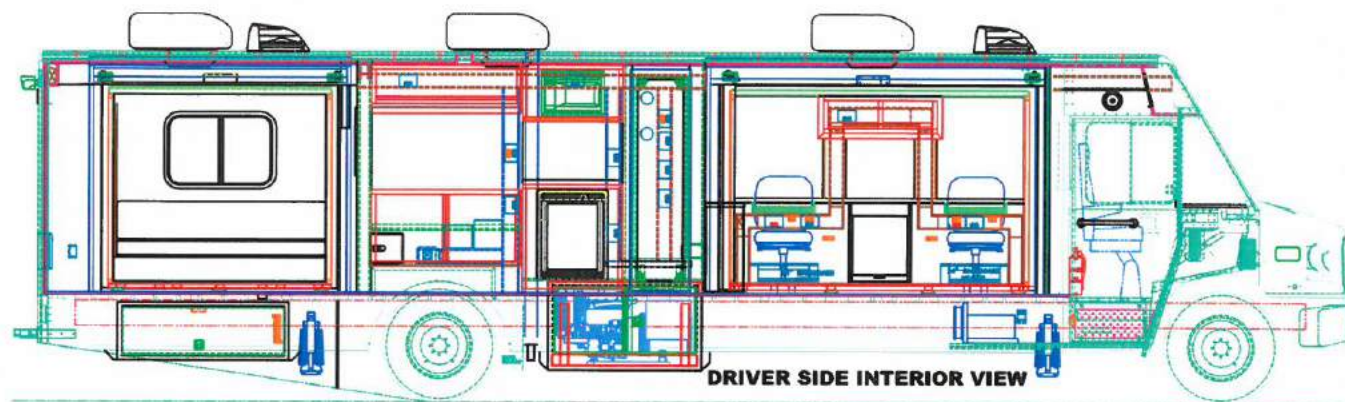

DRIVER SIDE INTERIOR VIEW

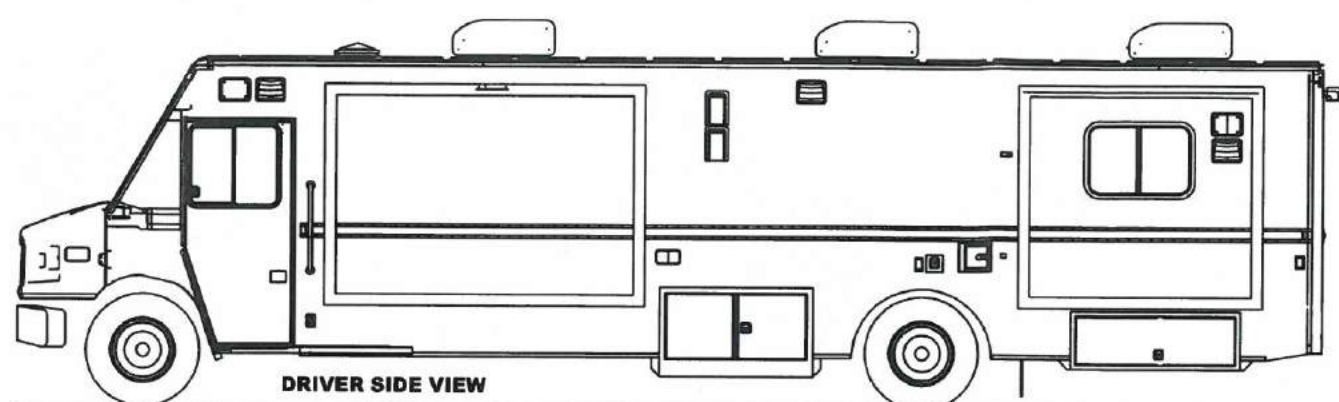

DRIVER SIDE VIEW

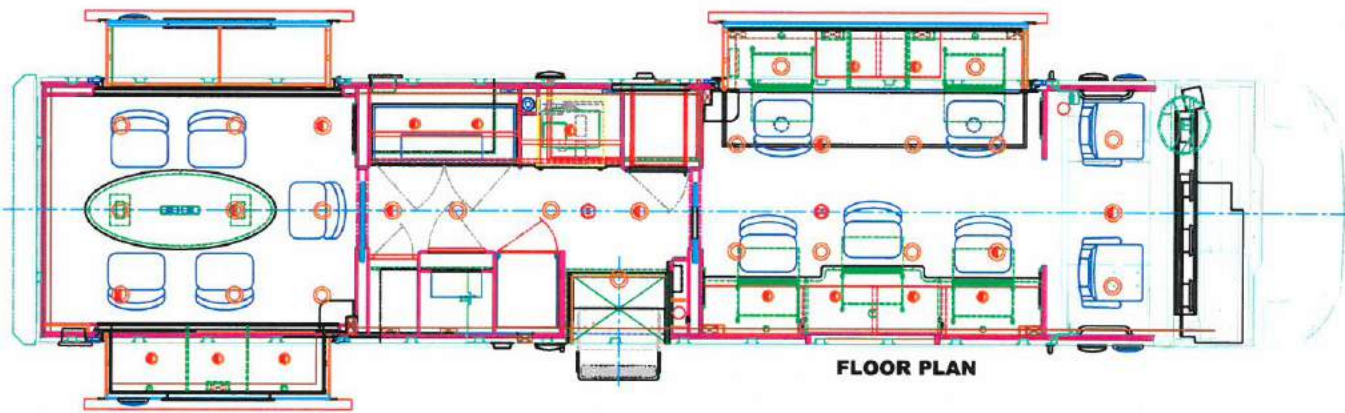

FLOOR PLAN

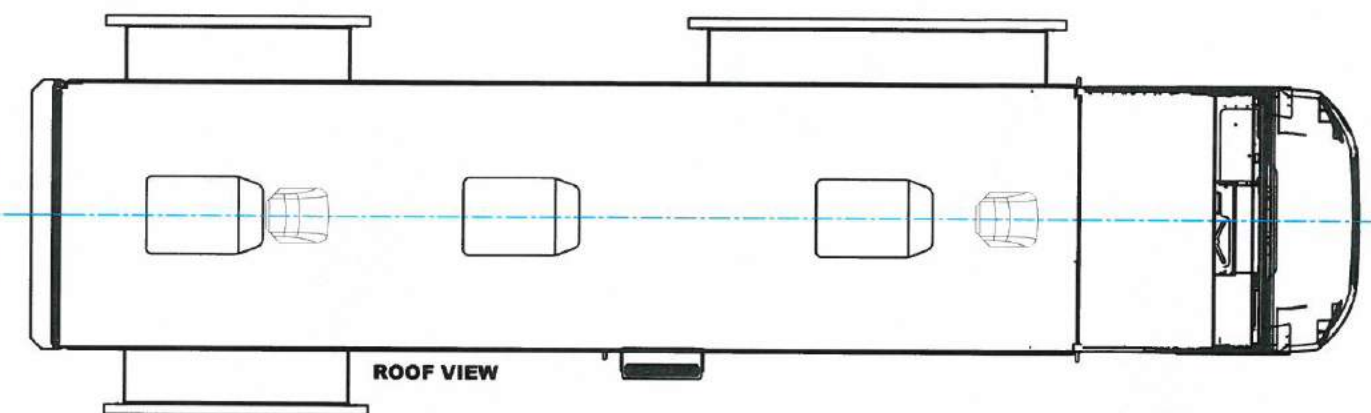

ROOF VIEW



FRONT VIEW

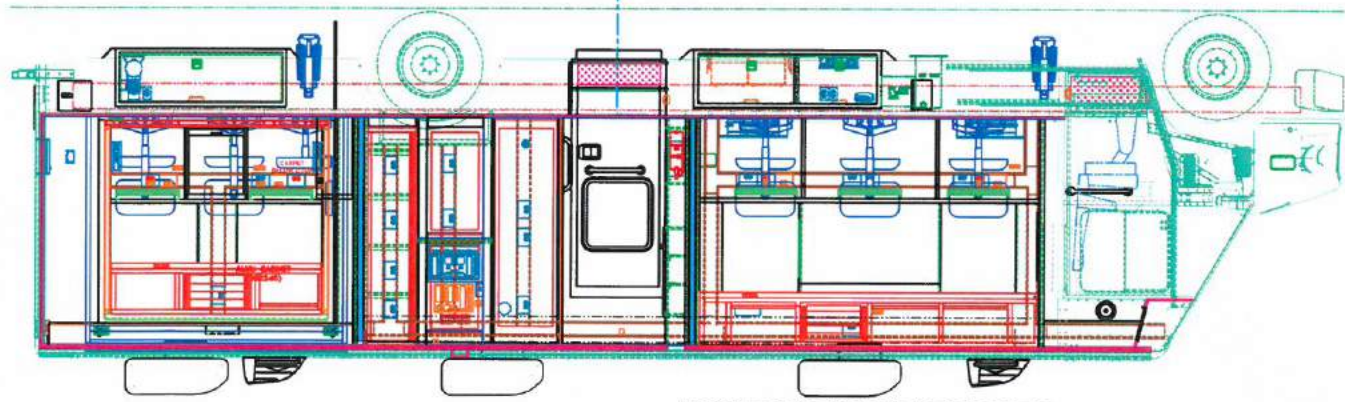

PASSENGER SIDE INTERIOR VIEW

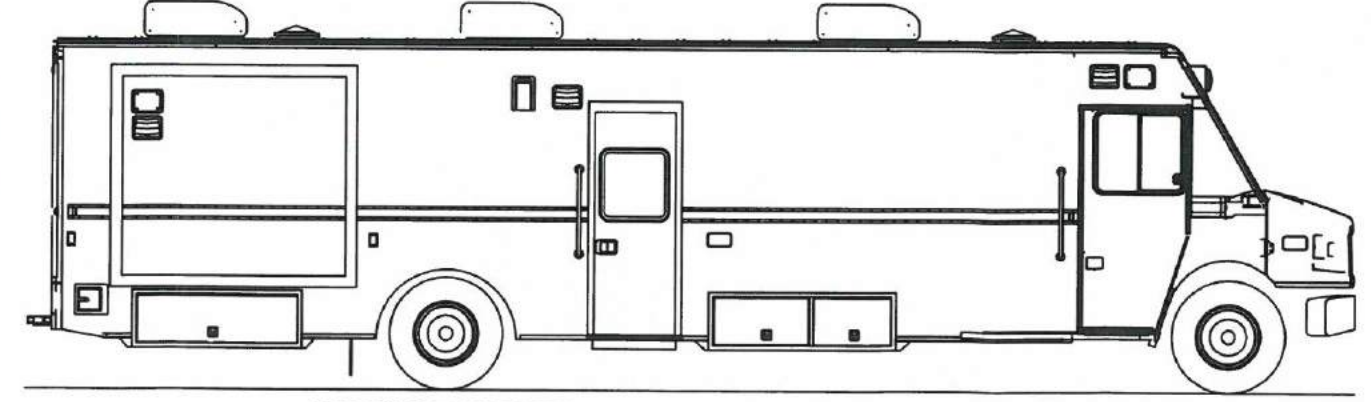

PASSENGER SIDE VIEW

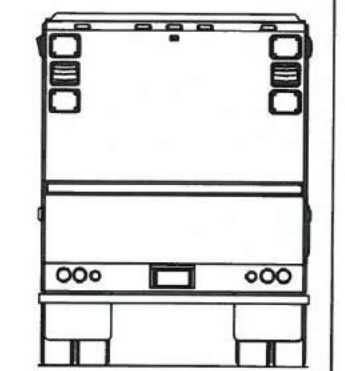

REAR VIEW

CUSTOMER APPROVAL
 PREPARED BY
 SIGNATURE

FARBER
 SPECIALTY VEHICLES
 7052 AMERICANA PARKWAY
 COLUMBUS, OH 43068
 USA

UNLESS OTHERWISE SPECIFIED:
 ALL DIMENSIONS ARE IN INCHES
 DIMENSIONS ARE TO CENTER UNLESS NOTED OTHERWISE
 DIMENSIONS ARE TO FACE UNLESS NOTED OTHERWISE

DESIGN ENGINEER: GIERHART - BH
 ELEC. ENGINEER: T. DENNIS
 ENG. MGR. APPROVAL:
 SALES: T. GOODYEAR
 PROPRIETARY AND CONFIDENTIAL
 THIS DOCUMENT IS THE PROPERTY OF FARBER SPECIALTY VEHICLES
 IT IS TO BE USED ONLY FOR THE PROJECT AND NOT BE REPRODUCED OR
 COPIED IN ANY MANNER WITHOUT THE WRITTEN PERMISSION OF
 FARBER SPECIALTY VEHICLES

CUSTOMER: FSV STEPVAN 30
 TITLE: US COMMUNITIES
 SHEET SIZE: E
 SCALE: 1/4" = 1'-0"
 UNIT NO.: 15796
 REV: A.5
 SHEET 1 OF 1

MODEL: FSV STEPVAN 30 MOBILE MEDICAL HEALTH VEHICLE

39' 6" overall length, Freightliner MT-55 chassis, Cummins 6.7L, 300HP diesel front engine, 29,000 GVWR. Allison 2500 series automatic transmission. Aluminum body construction with chrome front bumper, air brake package with ABS, 90 gallon fuel tank, power steering, remote control, heated exterior cab mirrors, two dashboard controlled electric windshield fans, Magnum high-back swivel driver and passenger seats, overhead storage cabinets. Commercial/medical grade vinyl flooring three roof air conditioners, electric heat, 12V magnetic/hydraulic circuit breakers, electronic master disconnect switches for main and auxiliary battery system, 90 amp. converter, 36' shoreline. Custom cabinets cut using CNC router.

Space is designed for efficiency and ergonomic function for an optimized workflow. Floor plan includes two exam rooms, intake/reception area, waiting area and lab area. Custom options for restroom, ADA accessibility, testing equipment, additional entrances and awnings. See price sheet for details.



MODEL: FSV COACH STYLE 33 MOBILE COMMAND

33'6" overall length, 6.8L, 362HP, gasoline powered, 24,000 GVWR, 75 gallon fuel tank, 102" exterior width, aluminum frame body construction, fiberglass exterior, flat interior floor/ no wheel wells, drivers door, main entrance door equipped with electric steps, aluminum outer wheels,. Remote control, heated exterior cab mirrors. High back, swivel, driver and passenger seats. Two dashboard controlled electric windshield fans. Commercial / medical grade vinyl flooring. Three roof air conditioners with central ducting, electric heat, magnetic/hydraulic 12V circuit breakers, electronic master disconnect switches for main and auxiliary battery system, 90 amp. converter, 36' shoreline. Custom cabinets cut using CNC router.

Space is designed for efficiency and ergonomic function for an optimized workflow. Floor plan includes two exam rooms, intake/reception area, waiting area and lab area. Custom options for restroom, ADA accessibility, testing equipment, additional entrances and awnings. See price sheet for details.



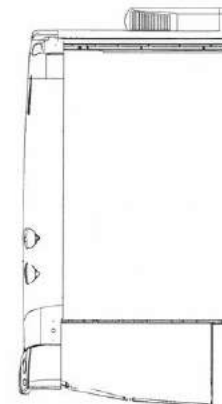
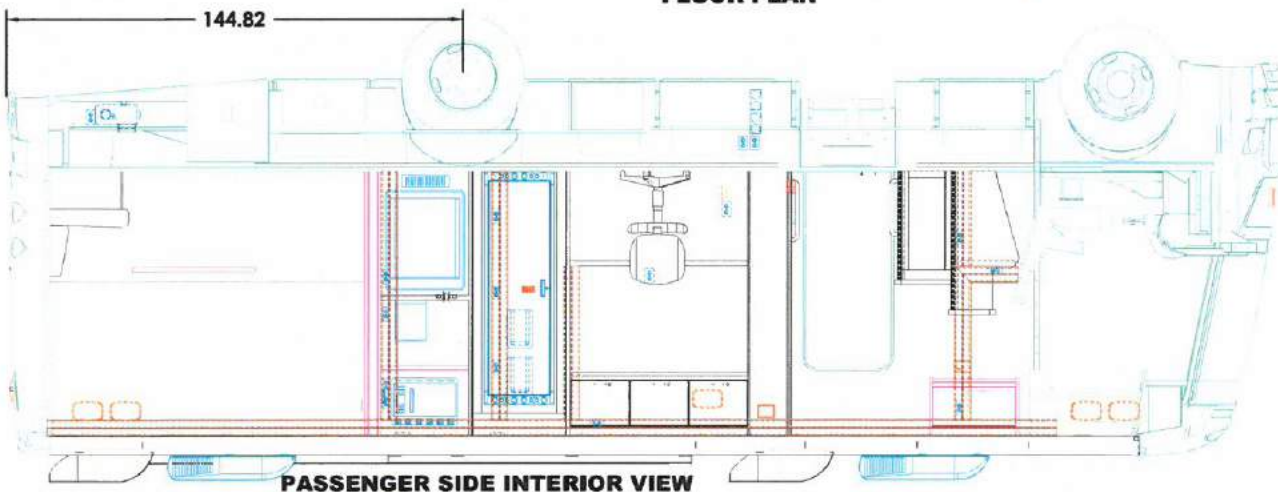
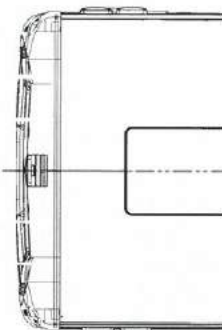
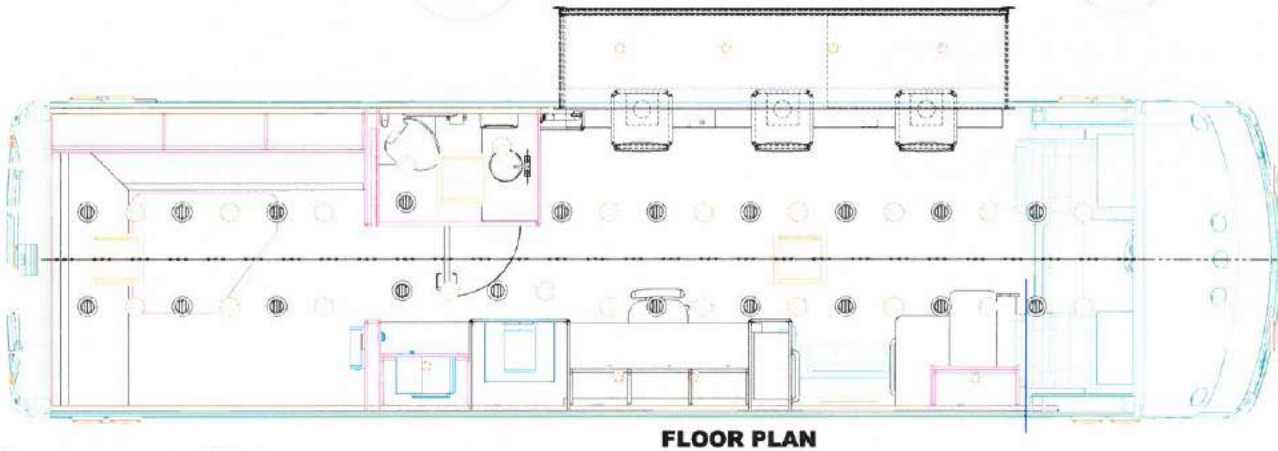
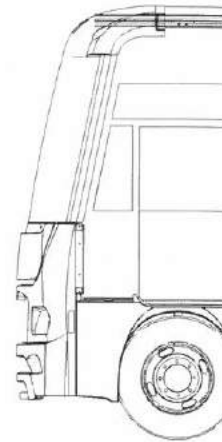
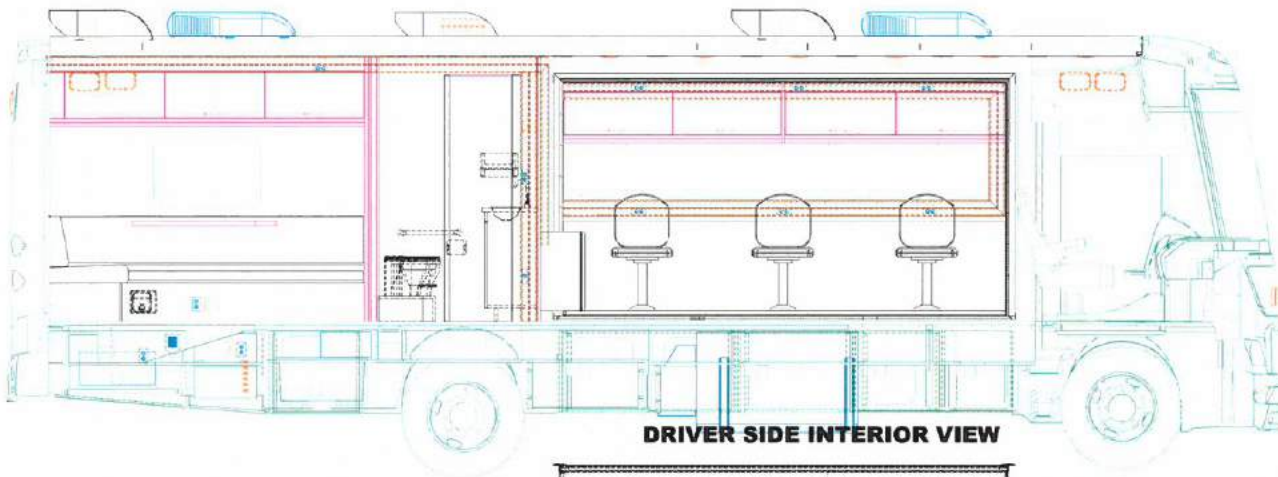

CUSTOMER APPROVAL

PRINT NAME

SIGNATURE

DATE

FARBER
SPECIALTY VEHICLES
7852 AMERICANA PARKWAY
COLUMBUS, OH 43068
USA

**MODEL: FSV COACH STYLE 38
BLOODMOBILE 38'**

38'6" overall length, 6.8L, 362HP, gasoline powered, 22,000 GVWR, 10Kw water cooled commercial generator, 75 gallon fuel tank, 102" exterior width, aluminum frame body construction, fiberglass exterior, flat interior floor/ no wheel wells, drivers door, main entrance door equipped with electric steps, aluminum outer wheels, 5000 lb. rated trailer hitch. Remote control, heated exterior cab mirrors. High back, swivel, driver and passenger seats. Two dashboard controlled electric windshield fans. Built in dash monitor for rearview backup camera system. Commercial / medical grade vinyl flooring. Three roof air conditioners with central ducting, electric heat, automatic computerized hydraulic leveling/stabilizing system, magnetic/hydraulic 12V circuit breakers, electronic master disconnect switches for main and auxiliary battery system, 90 amp. converter, 36' shoreline. Custom cabinets cut using CNC router.

Space is designed for efficiency and ergonomic function for an optimized workflow. Floor plan includes four blood draw tables, screening room, waiting area and lab area. Custom options for restroom, additional entrances and awnings. See price sheet for details.



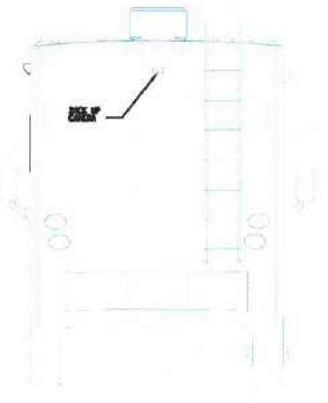
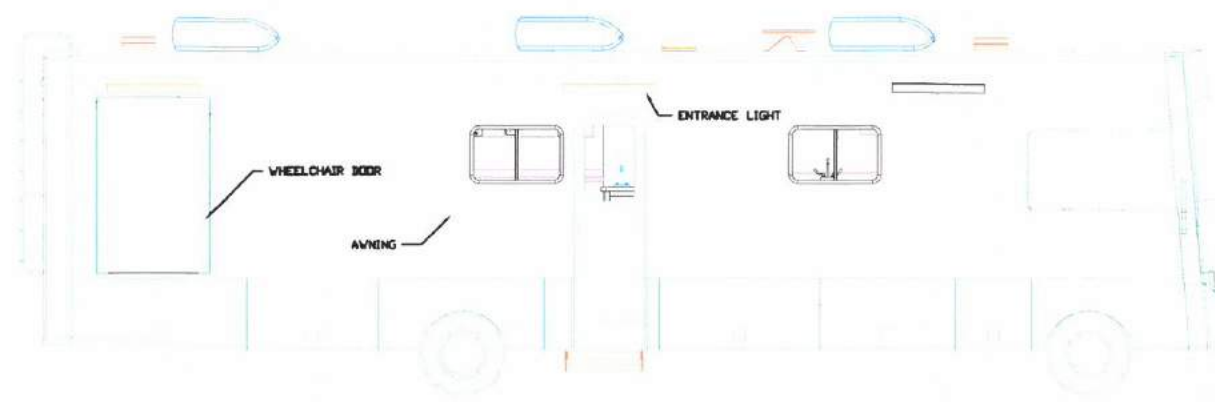

MODEL: FSV COACH STYLE 38 MOBILE DENTAL VEHICLE

38'6" overall length, 6.8L, 362HP, gasoline powered, 24,000 GVWR, 75 gallon fuel tank, 102" exterior width, aluminum frame body construction, fiberglass exterior, flat interior floor/ no wheel wells, drivers door, main entrance door equipped with electric steps, aluminum outer wheels, Remote control, heated exterior cab mirrors. High back, swivel, driver and passenger seats. Two dashboard controlled electric windshield fans. Commercial / medical grade vinyl flooring. Three roof air conditioners with central ducting, electric heat, magnetic/hydraulic 12V circuit breakers, electronic master disconnect switches for main and auxiliary battery system, 90 amp. converter, 36' shoreline. Custom cabinets cut using CNC router.

Space is designed for efficiency and ergonomic function for an optimized workflow. Floor plan includes two or three operatories, intake/reception area, waiting area and sterilization center. Custom options for restroom, ADA accessibility, additional entrances and awnings. See price sheet for details and packages of dental chairs, X-rays, sterilization and other dental equipment.



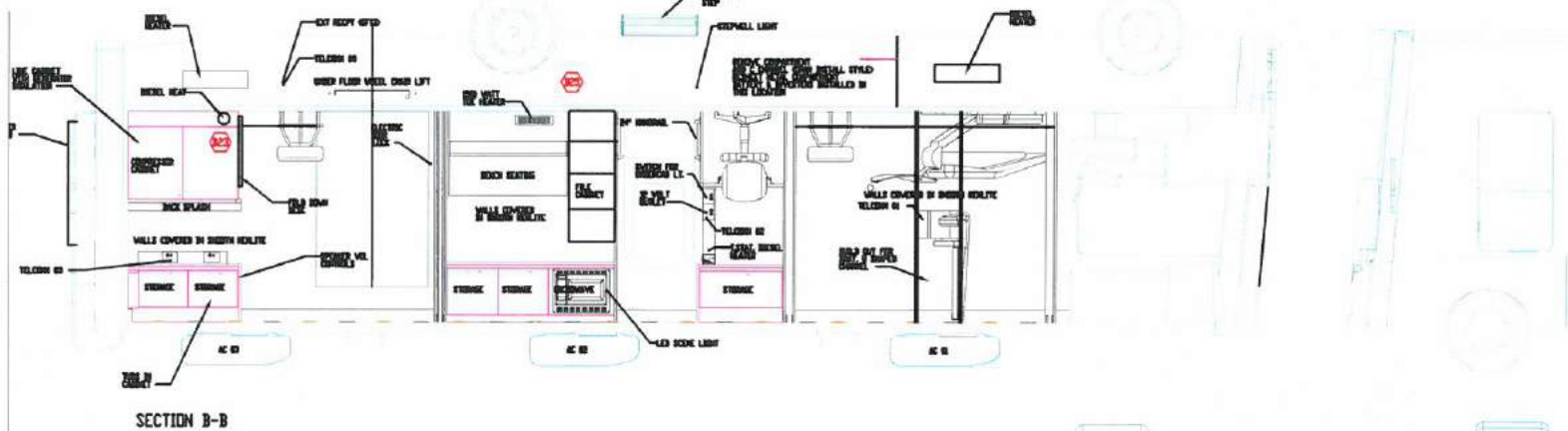
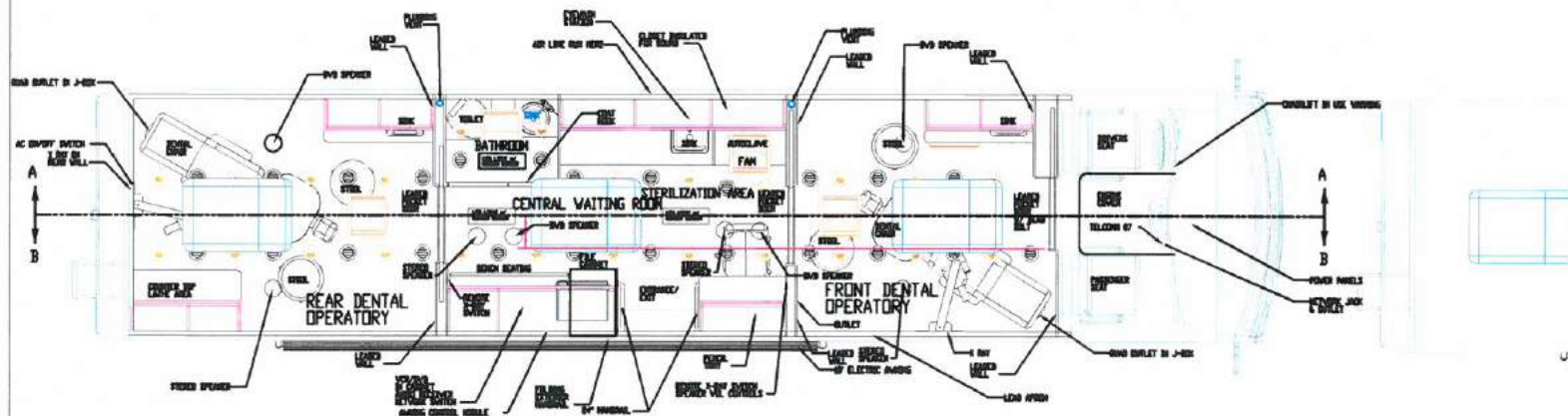
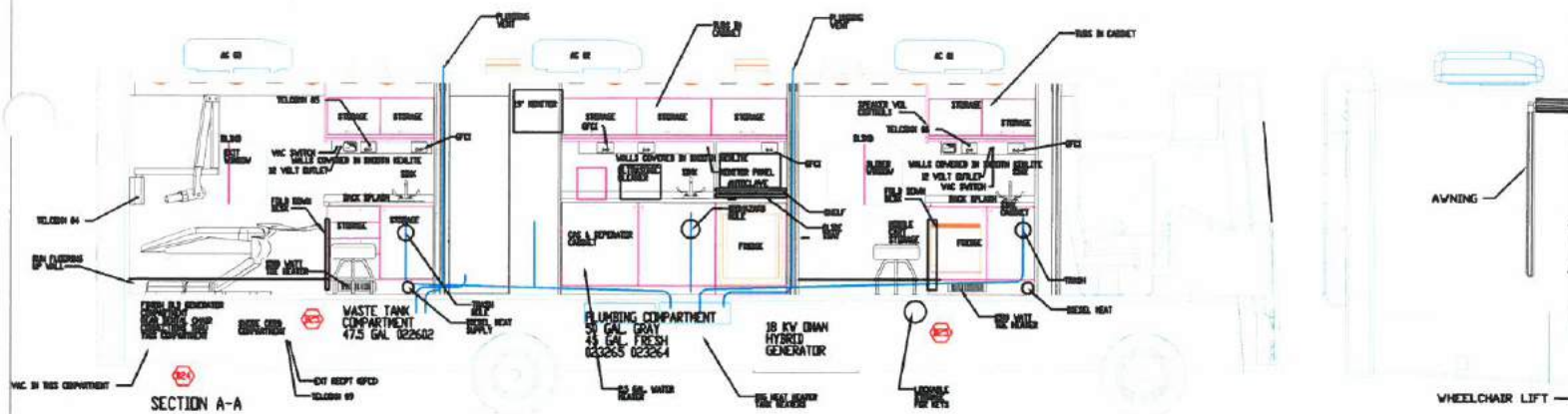

**MODEL: FSV COACH STYLE 38
MOBILE COMMAND CENTER, CSI, DUI**

38'6" overall length, 6.7L Cummins, 340HP diesel engine, 26,000 GVWR, 80 gallon fuel tank, 102" exterior width, aluminum frame body construction, fiberglass exterior, flat interior floor/ no wheel wells, drivers door, main entrance door equipped with electric steps, aluminum outer wheels, Remote control, heated exterior cab mirrors. High back, swivel, driver and passenger seats. Two dashboard controlled electric windshield fans. Commercial one-piece vinyl flooring. Three roof air conditioners with central ducting, electric heat, magnetic/hydraulic 12V and 120V circuit breakers, electronic master disconnect switches for main and auxiliary battery system, 90 amp. converter, 36' shoreline. Custom options, additional entrances and awnings. See price sheet for details and packages of Command, DUI and CSI equipment.



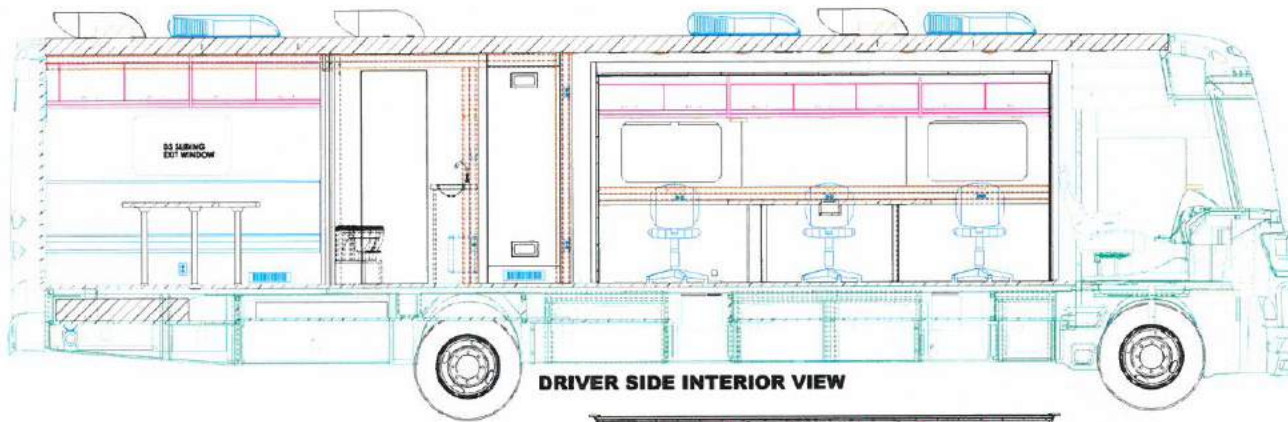

DRIVER SIDE INTERIOR VIEW

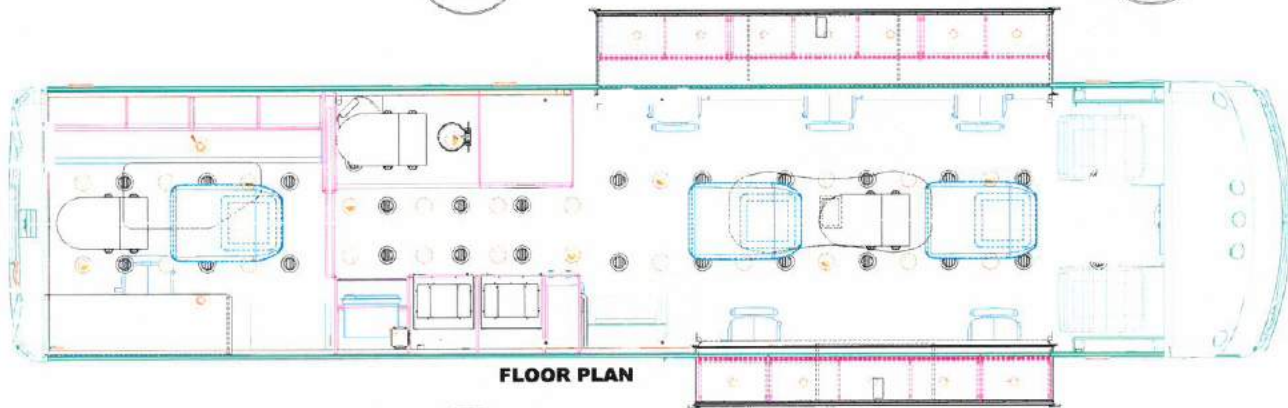
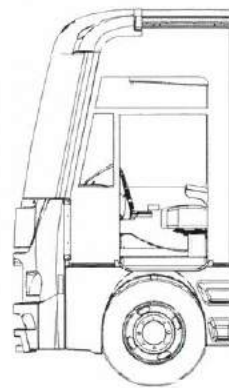

FLOOR PLAN

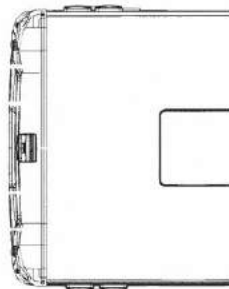

ROO

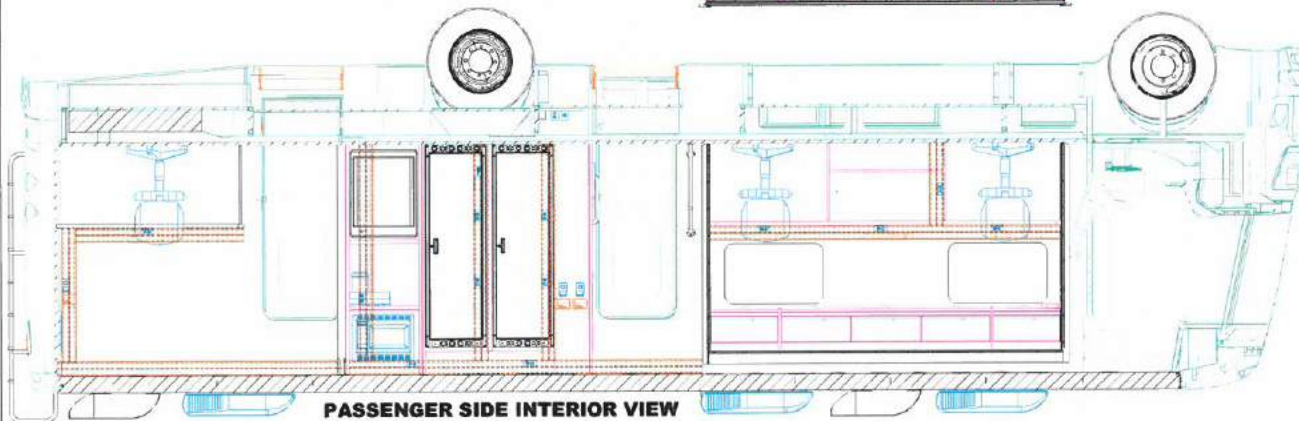

PASSENGER SIDE INTERIOR VIEW

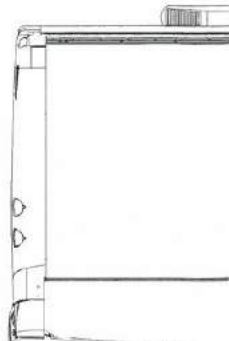

PASSENG

CUSTOMER APPROVAL	
SIGNATURE	DATE

FARBER
SPECIALTY VEHICLES

MODEL: FSV COACH STYLE 38 BOOKMOBILE

38'6" overall length, 6.8L, 362HP, gasoline powered, 24,000 GVWR, 75 gallon fuel tank, 102" exterior width, aluminum frame body construction, fiberglass exterior, flat interior floor/ no wheel wells, drivers door, main entrance door equipped with electric steps, aluminum outer wheels,. Remote control, heated exterior cab mirrors. High back, swivel, driver and passenger seats. Two dashboard controlled electric windshield fans. Commercial / medical grade vinyl flooring. Three roof air conditioners with central ducting, electric heat, magnetic/hydraulic 12V circuit breakers, electronic master disconnect switches for main and auxiliary battery system, 90 amp. converter, 36' shoreline. Custom cabinets cut using CNC router.

Space is designed for efficiency and ergonomic function for an optimized workflow. Floor plan includes two exam rooms, intake/reception area, waiting area and lab area. Custom options for restroom, ADA accessibility, testing equipment, additional entrances and awnings. See price sheet for details.



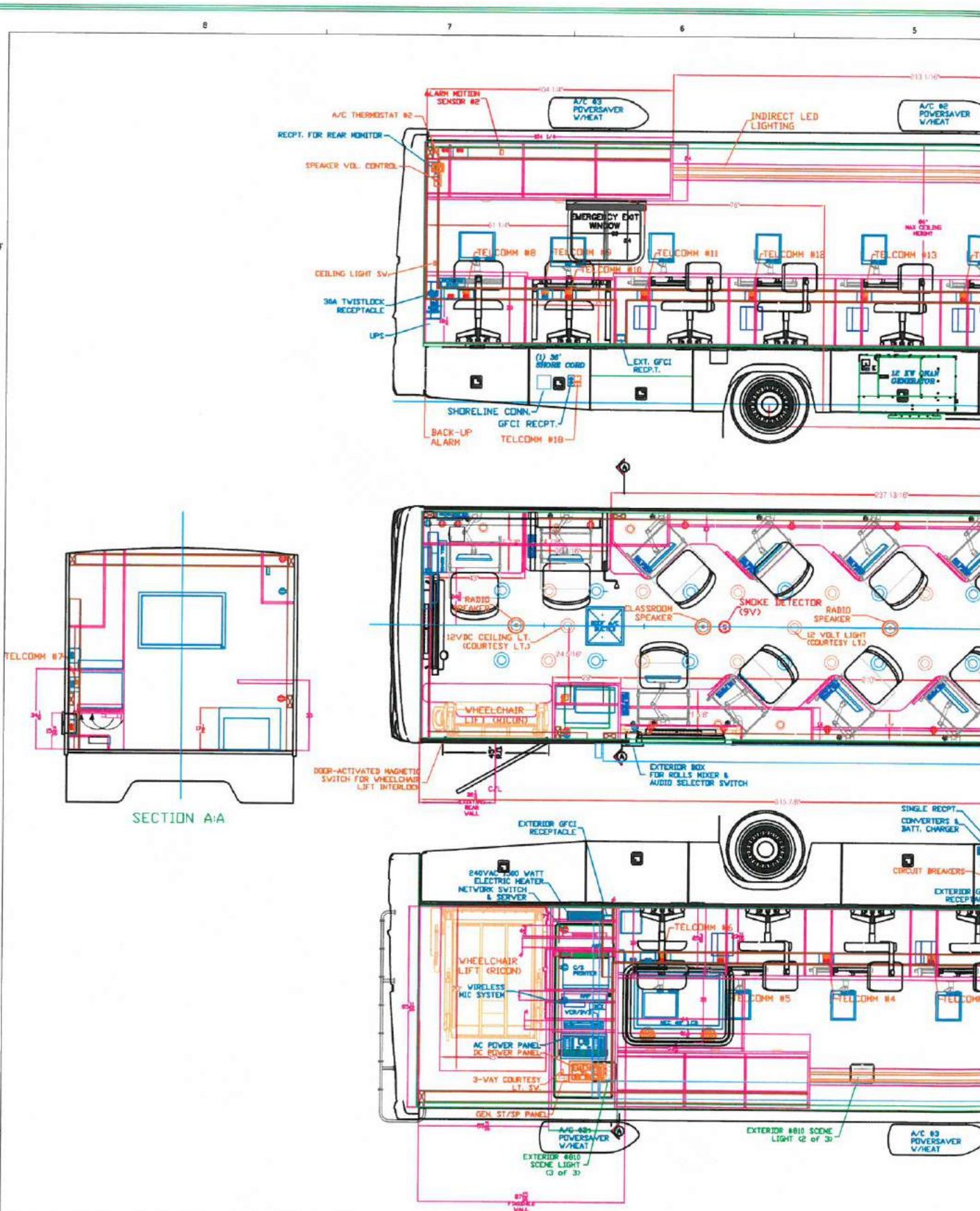

<p>CUSTOMER APPROVAL</p> <p>PRINT 1-1-10</p> <p>DATE 10/1/10</p>	<h1 style="margin: 0;">FARBER</h1> <h2 style="margin: 0;">SPECIALTY VEHICLES</h2> <p style="margin: 0;">7052 AMERICANA PARKWAY COLUMBUS, OH 43068 USA</p>	<table border="1" style="width: 100%; border-collapse: collapse;"> <thead> <tr> <th style="width: 10%;">REV.</th> <th style="width: 70%;">DESCRIPTION</th> <th style="width: 20%;">DESIGNED BY</th> </tr> </thead> <tbody> <tr> <td>P.1</td> <td>UPDATES AFTER PREBUILD MTG</td> <td>B. HO</td> </tr> <tr> <td>P.1</td> <td>UPDATES AFTER BUILD MTG</td> <td>B. HO</td> </tr> </tbody> </table>	REV.	DESCRIPTION	DESIGNED BY	P.1	UPDATES AFTER PREBUILD MTG	B. HO	P.1	UPDATES AFTER BUILD MTG	B. HO
REV.	DESCRIPTION	DESIGNED BY									
P.1	UPDATES AFTER PREBUILD MTG	B. HO									
P.1	UPDATES AFTER BUILD MTG	B. HO									

**MODEL: FSV CUSTOM COACH STYLE 40' (REAR ENGINE)
BLOODMOBILE COACH**

41'4" overall length, 8.3L, Cummins 400HP, diesel powered, rear engine, 33,000 GVWR, Allison 6-speed automatic, full air-suspension, air disc brakes, independent front suspension, 101" exterior width, aluminum frame body construction, fiberglass exterior, flat interior floor/ no wheel wells, main entrance door equipped with electric steps, aluminum outer wheels. Remote control, heated exterior cab mirrors. High back, swivel, driver and passenger seats. Two dashboard controlled electric windshield fans. Built in dash monitor for rearview backup camera system. Commercial/medical grade vinyl flooring. Three roof air conditioners, electric heat, automatic computerized hydraulic leveling/stabilizing system, magnetic/hydraulic 12V circuit breakers, electronic master disconnect switches for main and auxiliary battery system, 90 amp. Converter, 36' shoreline. Custom cabinets cut using CNC router.

Space is designed for efficiency and ergonomic function for an optimized workflow. Floorplan includes four blood draw tables, screening room(s), waiting area and lab area. Custom options for restroom, additional entrances and awnings. See price sheet for details.



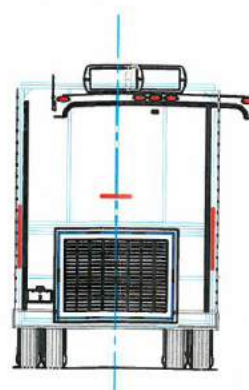
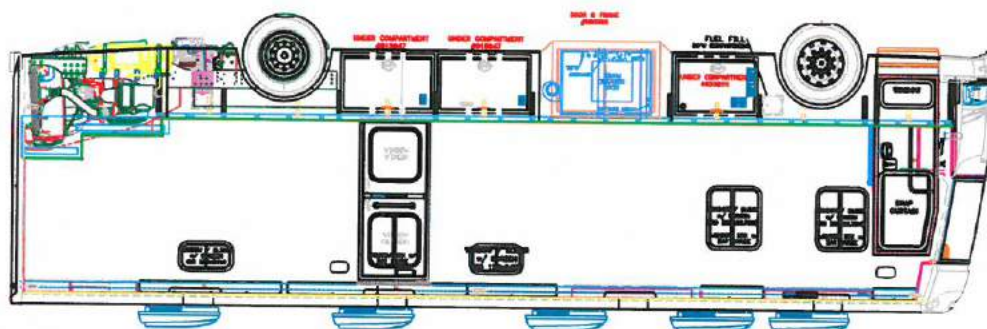
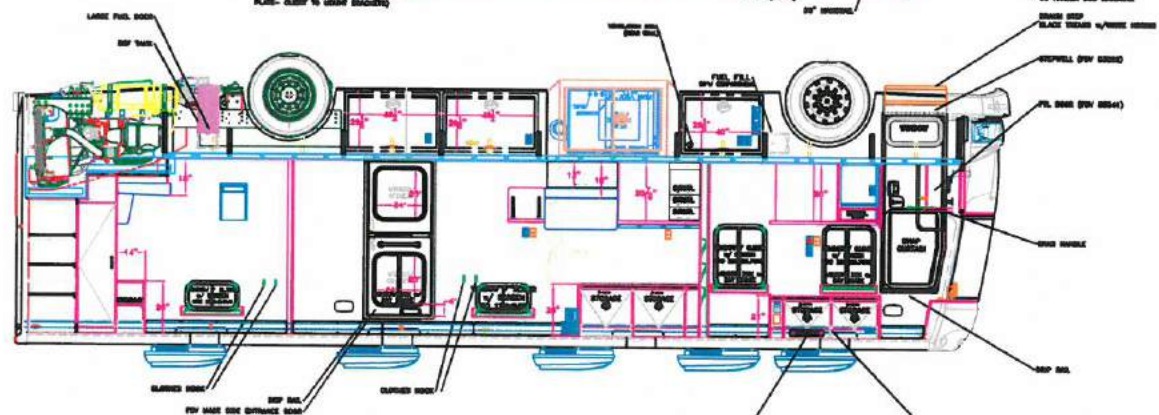
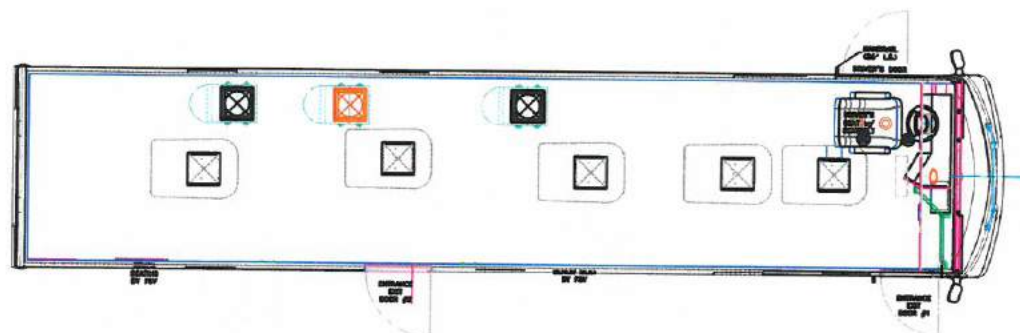
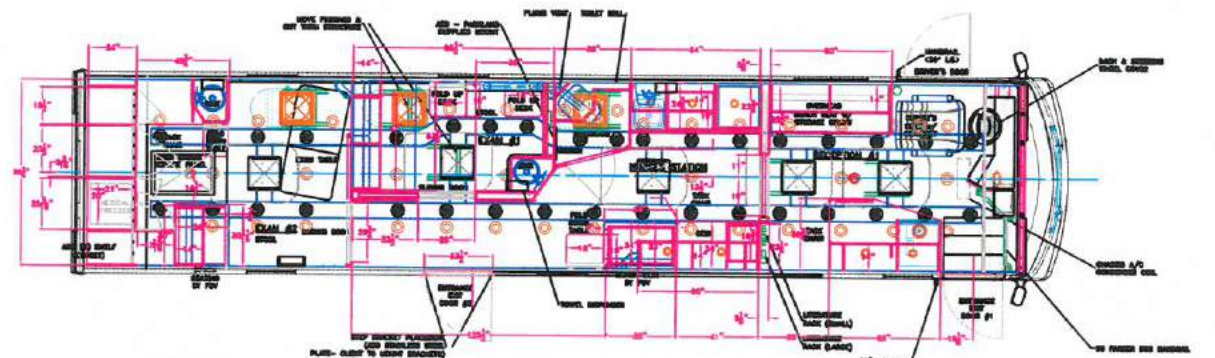
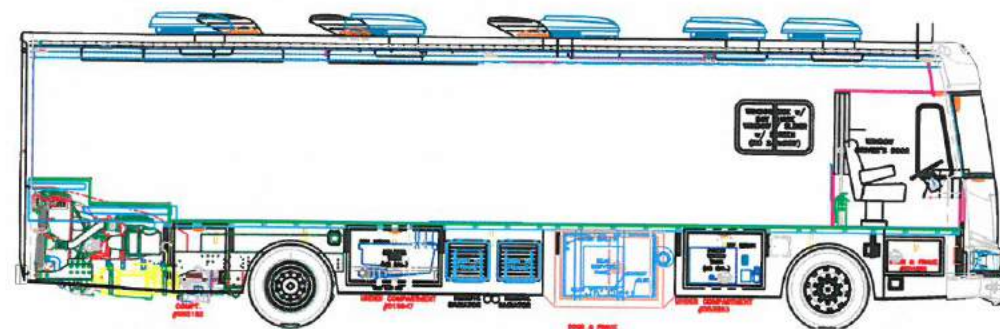

MODEL: FSV CUSTOM COACH STYLE 45' (REAR ENGINE)
Mobile Command, Medical, Classroom, STEM

45'4" overall length, 8.3L, Cummins 450HP, diesel powered, rear engine, 44,600 GVWR, Allison 6-speed automatic, full air-suspension, air disc brakes, independent front suspension, 101" exterior width, aluminum frame body construction, fiberglass exterior, flat interior floor/ no wheel wells, main entrance door equipped with electric steps, aluminum outer wheels. Remote control, heated exterior cab mirrors. High back, swivel, driver and passenger seats. Two dashboard controlled electric windshield fans. Commercial/medical grade vinyl flooring. Three roof air conditioners, electric heat, magnetic/hydraulic 12V circuit breakers, electronic master disconnect switches for main and auxiliary battery system, 90 amp. Converter, 36' shoreline. Custom cabinets cut using CNC router.

Space is designed for efficiency and ergonomic function for an optimized workflow. Custom options for restroom, additional entrances, slideouts and awnings. See price sheet for details.



FSV TRAILER 16 MOBILE COMMAND - DUI BAT - COMMUNICATIONS TRAILER

16' overall length including tongue, 7,500 GVWR, 102" exterior width, Smooth, seamless and impact resistant FRP fiberglass walls. Bright white gel coat interior and exterior wall finish. 7,000 lb. jack and welded safety chains. Rear ramp door to be spring assisted and 96" wide. Two tinted 30" x 15" windows; day/night shades installed on windows. One grab handle at door location. Deluxe scissor jacks with hand crank. Commercial one piece vinyl flooring. One roof air conditioner, electric heat. 12V and 120V circuit breakers, electronic master disconnect switches for main and auxiliary battery system, 36' shoreline. Custom cabinets cut using CNC router.



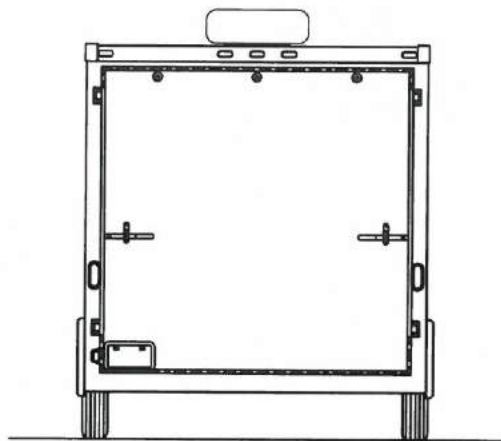

EXTERIOR REAR VIEW

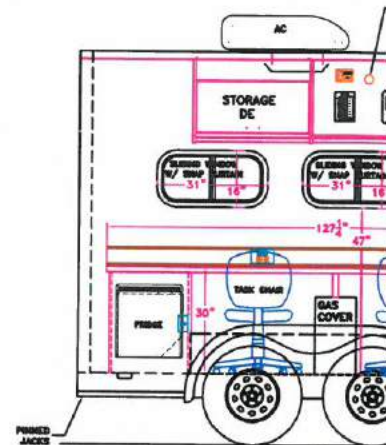

DRIVERS SIDE

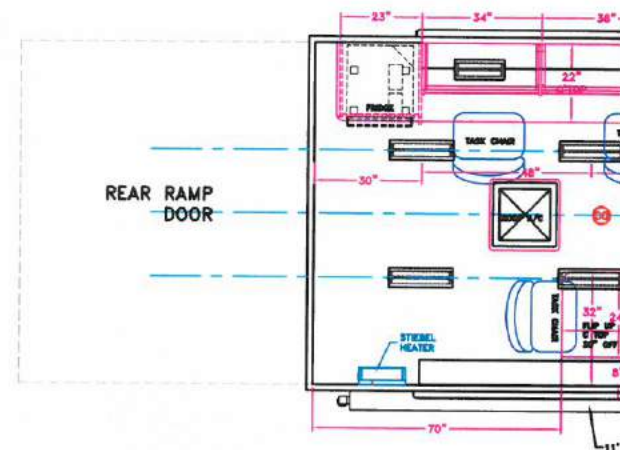

INTERIOR

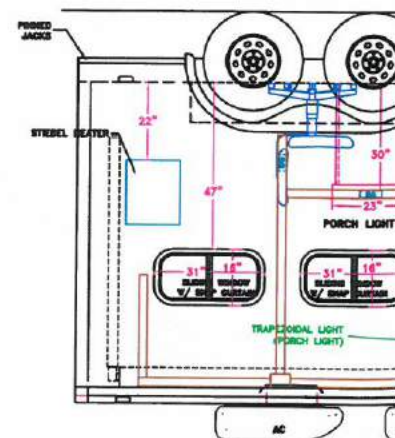

PASSENGER SIDE

CUSTOMER APPROVAL

PRINT NAME

PRINT NAME

DATE

FARBER
SPECIALTY VEHICLES
7052 AMERICANA PARKWAY
COLUMBIA, SC 29206
USA

REVISION HISTORY

REV

DESCRIPTION

DATE

MODEL: FSV PREVOST H3-45 45' (REAR ENGINE)
Mobile Command, Medical, Classroom

45'4" overall length, Volvo D13, diesel powered, rear engine, 500HP, 54,500 GVWR, Allison World B500, six speed, automatic, full air-suspension, air disc brakes, independent front suspension, 101" exterior width, aluminum frame body construction, fiberglass exterior, flat interior floor/ no wheel wells, main entrance door equipped with electric steps, aluminum outer wheels. Remote control, heated exterior cab mirrors. High back, swivel, driver and passenger seats. Two dashboard controlled electric windshield fans. Commercial/medical grade vinyl flooring. Three roof air conditioners, electric heat, magnetic/hydraulic 12V circuit breakers, electronic master disconnect switches for main and auxiliary battery system, 90 amp. Converter, 36' shoreline. Custom cabinets cut using CNC router.

Space is designed for efficiency and ergonomic function for an optimized workflow. Custom options for restroom, additional entrances, slide-outs and awnings. See price sheet for details.



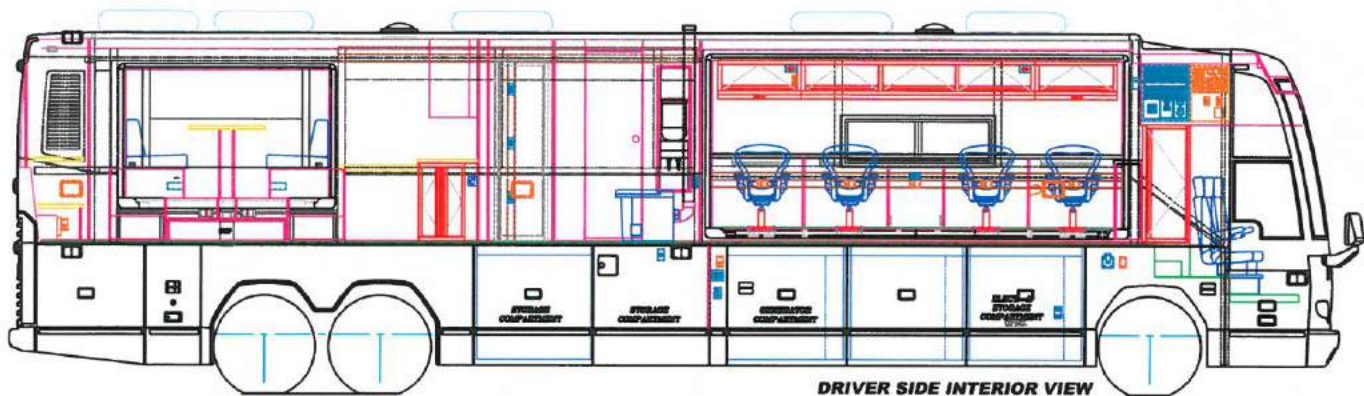

DRIVER SIDE INTERIOR VIEW

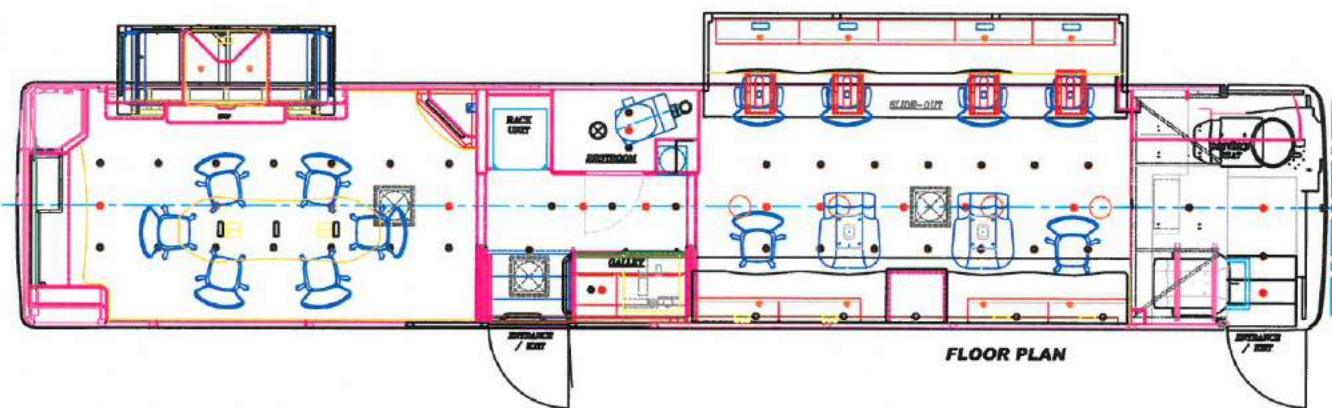

FLOOR PLAN

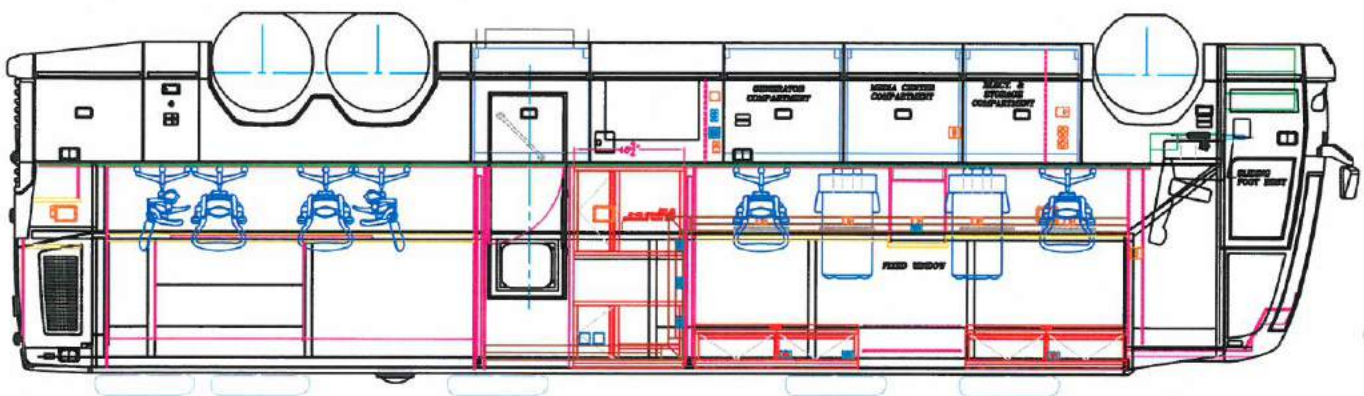

PASSENGER SIDE INTERIOR VIEW

CUSTOMER APPROVAL

PRINT NAME

SIGNATURE

DATE

FARBER
SPECIALTY VEHICLES

FSV TRAILER 30 MOBILE MEDICAL ,HEALTH, DENTAL,COMMAND,CLASSROOM -

Body 30', 34' overall length, 10,000 GVWR, 102" exterior width, Aluminum construction, welded safety chains. One grab handle at door location. Deluxe scissor jacks with hand crank. Fire rated fiberglass interior wall and ceiling finish, commercial/medical vinyl flooring. One roof mounted air conditioner, electric heat. 12V and 120V circuit breakers, electronic master disconnect switches for main and auxiliary battery system, 36' shoreline. Custom cabinets cut using CNC router.

Space is designed for efficiency and ergonomic function for an optimized workflow. Custom options for restroom, ADA accessibility, testing equipment, additional entrances and awnings. See price sheet for details. Alternative length options available.

