

CCO FORM: RW02
Approved: 6/93 (TLP)
Revised: 02/10 (AR)
Modified:

COUNTY: Jackson
ROUTE: F
PROJECT: NA
PARCELS: _____

FILED
JUL 10 2013
MARY JO SPINO
COUNTY CLERK

QUITCLAIM DEED

Res. 18199

THIS INDENTURE, made this 10th day of July, 2013, between **JACKSON COUNTY, MISSOURI**, party of the first part (Grantor), and the **State of Missouri**, acting by and through the **Missouri Highways and Transportation Commission**, parties of the second part (hereinafter, "Grantee").

Grantor's Address: 415 E. 12th Street, Kansas City, Missouri 64106

Grantee's Address: 600 NE Colbern Road, Lee's Summit, MO 64086

WITNESSETH:

The said parties of the first part, in consideration of the sum of **One Dollar (\$1.00) or other good and valuable concern**, to them paid by the said party of the second part, the receipt of which is hereby acknowledged, does by these presents remise, release, and forever QUITCLAIM unto said party of the second part, its successors and assigns, the following described real estate and interests in real estate in the County of Jackson, State of Missouri, to wit:

Tract 1 - Jackson County Recorder of Deeds, Book 555 Page 81 as recorded:

A strip of land 30 feet in width and 4607 feet in length the Westerly boundary of which is the centerline of the County Highway from Oak Grove to Sni Mills as located and laid out by the Jackson County Highway Engineering Department, and included between station 37+68 and 83+75 of the survey thereof.

The said station 37+68 is located at a point 655 feet more or less South of the N.W. Cor. of the S.W. ¼ of Sec. 4, T. 48 N. R. 29 W. and from said station the said centerline runs in a Southerly direction the said distance of 4607 feet to said station 83+75.

Said strip of land contains 3.1 acres of which 0.31 acres is new land, from grantors herein, and 2.79 acres is old land lying in the present public road. The said strip of land lying being and situated in the S.W. ¼ of Sec 4, and the N.W. ¼ of Sec. 9, T. 48 N. R.29 W.

Also a strip of land 5 feet wide and 200 feet long lying adjacent to the Easterly side of the above mentioned 30 foot strip and included between stations 39+00 and 41+00.

Said Strip also contains 0.02 acres.

Also a strip of land 5 feet wide and 100 feet long lying adjacent to the Easterly side of the above mentioned 30 foot strip and included between stations 70+00 and 71+00.

Said Strip also contains 0.01 acres.

Also a strip of land 5 feet wide and 100 feet long lying adjacent to the Easterly side of the above mentioned 30 foot strip and included between stations 76+00 and 77+00.

Said Strip contains 0.01 acres.

Tract 2 - Jackson County Recorder of Deeds, Book 670 Page 583 as recorded:

A strip of land 10 feet in width and 532 feet in length, the West boundary of which is a line 30 feet East of and parallel to the center line of the highway from Oak Grove to U.S. Highway No. 50 and known as the Outer Belt Road as located and laid out by the Jackson County Highway Engineering Department and included between station 37 + 68 and station 43 + 00 of the survey thereof.

The said station 37 + 68 is located 654.5 feet South of the Northwest corner of the Southwest quarter of Section 4, Township 48 North, Range 29 West. From said station 43 + 00 the said center line runs in a southerly direction the said distance of 532 feet to said station 43 + 00. The said station 43 + 00 is located 1186.5 feet South of the Northwest corner of the Southwest quarter of said Section 4.

Said strip of land contains 0.12 acres, more or less, of which 0.02 acres, more or less, is land lying in the present right of way and 0.10 acres, more or less, is new land from the grantor herein.

Said strip of land lying being and situated in Section 4. Township 48 North, Range 29 West.

Tract 3 - Jackson County Recorder of Deeds, Book 711 Page 183 as recorded:

A strip of land 10 feet in width and 532 feet in length, the west boundary of which is a line 30 feet East of and parallel to the center line of the highway from Oak Grove to U.S. Highway No. 50 and known as the Outer Belt Road as located and laid out by the Jackson County Highway Engineering Department and included between Station 37+68 and Station 43+00 of the survey thereof.

The said Station 37+68 is located 654.5 feet south of the Northwest corner Of the Southwest Quarter of Section 4, Township 48. North, Range 29 West. From said Station 43+00 the said center line runs in a southerly direction the said distance of 532 feet to said station 43+00. The said Station 43+00 is located 1186.5 feet South of the Northwest Corner of the Southwest Quarter of said Section 4.

Said strip of land contains 0.12 acres, more or less, of which 0.02 acres, more or less, is land lying in the present right-of-way and 0.10 acres, more or less, is new land from the grantor herein.

Said strip of land lying, being and situated in Section 4, Township 48 North. Range 29 West.

Tract 4 - Jackson County Recorder of Deeds, Book 657 Page 561 as recorded:

A strip of land 30 feet in width and 1320 feet in length, the East boundary of which is the center line of the Highway from Oak Grove to U.S. Highway No. 50 and known as the Outer Belt Road as located and laid out by the Jackson County Highway Engineering Department and included between station 44 + 38 and station 57 + 58 of the survey thereof.

The said station 44 + 38 is located 1320 feet North of the Southwest corner of Section 4, Township 48 North, Range 29 West. From said station 44 + 38 the said center line runs in a southerly direction the said distance of 1320 feet to said station 57 + 58. The said station 57 + 58 is 0.27 feet South of the Southwest corner of Section 4, Township 48 North. Range 29 West.

Said strip of land contains 0.91 acres, more or less, lying being and situated in Section 5, Township 48 North, Range 29 West.

Tract 5 - Jackson County Recorder of Deeds, Book 555 Page 155 as recorded:

A strip of land 30 feet in width and 1320 feet in length the Easterly boundary of which is the center line of the County Highway from Oak grove to Sni Mills as located and laid out by the Jackson County Highway Engineering Department, and included between sections 57 + 53 and 70 + 78 of the survey thereof.

The said station 57 + 58 is located at the S.W. Cor. Of Sec. 4, T. 48 N. R. 29 W. and from said station to said centerline runs in a southerly direction the said distance of 1320 feet to said station 70 +78.

Said strip of land contains 1.09 acres of which 0.12 acres is new land, from grantors herein, and 1.92 acres is old land lying in the present public road. The said strip of land lying, being and situated in the N.W. $\frac{1}{4}$ of Sec. 9, and the N.E. $\frac{1}{4}$ of Sec. 8 T.48 N. R. 29 W.

Also a strip of land 10 feet wide and 300 feet long lying adjacent to the Westerly side of the above mentioned 30 foot strip and included between stations 67 + 00 and 70 + 00.

Said strip contains 0.07 acres.

Also permanent easement for the purpose changing the course of the present stream upon a strip of land 20 feet wide and 150 feet long; said strip having its Easterly and adjacent to the Westerly side of said 30 foot strip first mentioned above and having its Westerly and center opposite station 70 + 58 and said strip running thence Westerly the said distance of 150 feet, together with right of ingress and egress on grantors land and right to remove fence or hedge if necessary in exercise of above right.

Said channel change strip contains 0.07 acres.

Tract 6 - Jackson County Recorder of Deeds, Book 670 Page 582 as recorded:

A strip of land 10 feet in width and 78 feet in length, the easterly boundary of which is a line 30 feet West of and parallel to the center line of the County Highway from Oak Grove to U.S. Highway No. 50 and known as the Outer Belt Road, as located and laid out by the Jackson County Highway Engineering Department and included between stations 70 + 00 and 70 + 78 of the survey thereof.

The said station 70 + 00 is located at a point 1242 feet more or less South of and 50 feet more or less East of the Northwest corner of the Northwest quarter of Section 9, Township 48 North, Range 29 West.

From said station 70 + 00 the said center line runs on a curve bearing to the left having a radius of 955.37 feet a distance of 78 feet to station 70 + 78.

Said strip of land contains 0.02 acres, more or less, lying being and situated in the Northwest quarter of Section 9, Township 48 North, Range 29 West.

Tract 7 - Jackson County Recorder of Deeds, Book 555 Page 1 as recorded:

A strip of land 30 feet in width and 1320 feet in length the Easterly boundary of which is the center line of the County Highway from Oak Grove to Sni Mills as located and laid out by the Jackson County Highway Engineering Department, and included between station 70 + 78 and 83 + 98 of the survey thereof.

The said station 70 + 78 is located at a point - - - feet more or less East and 625 feet more or less North of the N.W. Cor. Of the S.W. ¼ of Sec. 9, T. 48 N. R. 29 W. and said station the said center line runs in a Southerly direction the said distance of 1320 feet to said station 83 + 98.

Said strip of land contains 0.90 acres all of which lies in the present public road. The said strip of land lying, being and situated in Sec. 9, T. 48 N. R. 29 W.

Also a strip of land 5 feet wide and 98 feet long lying adjacent to the Westerly side of the above mentioned 30 foot strip and included between stations 83 + 00 and 83 + 95.

Said Strip Contains 0.01 acres.

Tract 8 - Jackson County Recorder of Deeds, Book 670 Page 581 as recorded:

A strip of land 10 feet in width and 1222 feet in length, the Easterly boundary of which is a line 30 feet West of and parallel to the center line of the highway from Oak Grove to U.S. Highway No. 50 and known as the Outer Belt Road as located and laid out by the Jackson County Highway Engineering Department and included between Station 70 + 78 and station 83 + 00 of the survey thereof.

Said station 70 + 78 is located 1237 feet more or less South of and 55 feet more or less East of the Southwest corner of Section 4, Township 48 North, Range 29 West. From said station 70 + 78 the said center line runs on a curve to the left having a radius of 955.37 ft. a distance of 51.32 feet to station 71 + 29.32; thence on tangent in a southeasterly direction a distance of 111.98 feet to station 72 + 41.3; thence on a curve to the right having a radius of 819.02 feet a distance of 207.14 feet to station 74 + 48.4; thence on tangent in a southeasterly direction a distance of 298.6 feet to station 77 + 47.0 thence on a curve bearing to the right and having a radius of 955.37 feet a distance of 292.22 feet to station 80 + 39.2; thence on tangent in a southwesterly direction a distance of 260.8 feet to said station 83 + 00..

The said station 83 + 00 is located 75 feet more or less North of and 295.16 feet more or less East of the Northwest corner of the Southwest quarter of Section 9, Township 48 North Range, 29 West.

Said strip of land contains 0.21 acres, more or less, lying, being and situated in Section 9, Township 48 North, Range 29 West.

Tract 9 - Jackson County Recorder of Deeds, Book 657 Page 558 as recorded:

A strip of land 30 feet in width and 615 feet in length, the Easterly boundary of Which is the center line of the highway from Oak Grove to U.S. No. 50 and known as the Outer Belt Road as located and laid out by the Jackson County Highway Engineering Department and included between station 83 + 75 and station 89 + 90 of the survey thereof.

Said station 83 + 75 is located 295.16 feet East of the Northwest corner Of the Southwest quarter of Section 9, Township 48 North, Range 29 West. From said station 83 + 75. the said center line runs in a southerly direction a distance of 56.25 feet to station 84 + 31.25; thence on a curve to the right having a radius of 573.70 feet a distance at 330 feet to Station 87 + 61.4 thence on tangent in a southwesterly direction a distance of 119.4 feet to station 88 + 80.8; thence on a curve bearing to the left and having a radius of 478.34 feet in distance of 109.2 feet to station 89 + 90. The said station 89 + 90 is 576 feet more or less South Of and 48 feet more or less East of the Northwest corner of the Southwest 1/4 Section 9, Township 48 North. Range 29 West.

Said Strip of land contains 0.42 acres, more or less, lying being and situated in Southwest quarter of Section 9, Township 48 North. Range 29 West.

Tract 10 - Jackson County Recorder of Deeds, Book 555 Page 72 as recorded:

A strip of land 30 feet in width and 3995 feet in length the Westerly boundary of which is the center line of the County Highway from Oak Grove to Sni Mills as located and laid out by the Jackson County Highway Engineering Department, and included between station 83 + 75 and 123 + 70 of the survey thereof.

The said station 83 + 75 is located at a point 295 feet more of less East of the N.W. Cor. of the S. W. ¼ Sec. 9, T. 48 N. R. 29 W. and from said station the said centerline runs in a Southerly direction the said distance of 3995 feet to said station 123 + 70.

Said strip of land contains 2.75 acres of which 0.15 acres is new land, from grantors herein, and 2.60 acres is old land lying in the present public road. The said strip of land lying, being and situated in the S. W. ¼ of Sec. 16, T. 48 N. R. 29 W. Also a strip of land 15 feet wide and 100 feet long lying adjacent to the Easterly side of the above mentioned 30 foot strip and included between stations 92 + 00 and 93 + 00.

Said strip contains 0.03 acres.

Tract 11 - Jackson County Recorder of Deeds, Book 555 Page 133 as recorded:

A strip of land 30 feet in width and 727 feet in length the Easterly boundary of which is the center line of the County Highway from Oak Grove to Sni Mills as located and laid out by the Jackson County Highway Engineering Department, and included between stations 89 + 90 and 97 + 17 of the survey thereof.

The said station 89 + 90 is located at a point 580 feet more or less South and 45 feet more or less East of the N. W. Cor. of the S. W. ¼ of Sec. 9, T.48 N. R. 29 W. and from said station the said center line runs in a Southerly direction the said distance of 727 feet to said station 97 + 17.

Said strip of land contains 0.50 acres of which 0.10 acres is new land, from grantors herein, and 0.40 acres is old land lying in the present public road. The said strip of land lying, being and situated in the S.E. ¼ of Sec. 8, T. 48 N. R. 29 W.

Also a strip of land 10 feet wide and 400 feet long lying adjacent to the Westerly side of the above mentioned 30 foot strip and included between stations 93 + 00 and 97 + 00.

Said strip contains 0.09 acres.

Tract 12 - Jackson County Recorder of Deeds, Book 442 Page 532 as recorded:

A strip of land 30 feet in width and 1346 feet in length the Easterly boundary of which is the center line of the County Highway from Oak Grove to Sni Mills as located and laid out by the Jackson County Highway Engineering Department, and included between station 97 + 17 and 110 + 63 of the survey thereof.

The said station 97 + 17 is located at a point 1346 feet more or less North of the N. W. Cor. of Sec. 16, T. 48 N. R. 29 W. and from said station the said center line runs in a Southerly direction the said distance of 1346 feet to said station 110 + 63.

Said strip of land contains 0.93 acres of which 0.02 acres is new land, from grantors herein, and 0.91 acres is old land lying in the present public road. The said strip of land lying, being and situated in the S. E. ¼ of Sec. 8, T. 48 N. R. 29 W.

Tract 13 - Jackson County Recorder of Deeds, Book 670 Page 590 as recorded:

A strip of land 10 feet in width and 600 feet in length, the Easterly boundary of which is a line 30 feet West of and parallel to the center line of the County Highway from Oak Grove to U.S. Highway #50 and known as the Outer Belt Road as located and laid out by the Jackson County Highway Engineering Department and included between Station 100 + 00 and station 106 + 00 of the survey thereof.

The said station 100 + 00 is located at a point which is 1063.2 feet North of the Southeast corner Section 8, Township 48 North, Range 29 West.

From said station 100 + 00 the said center line runs in a southerly direction the said distance of 600 feet to said station 106 + 00.

Said station 106 + 00 is located at a point which is 463.2 feet North of the Southeast corner of said Section 8.

Said strip of land contains 0.14 acres, more or less, lying, being and situated in Section 8, Township 48 North. Range 29 West.

Tract 14 - Jackson County Recorder of Deeds, Book 556 Page 109 as recorded:

A strip of land 30 feet in width and 2627 feet in length the Easterly boundary of which is the center line of the County Highway from Oak Grove to Sni Mills as located and laid out by the Jackson County Engineering Department, and included between station 110 + 63 and 136 + 90 of the survey thereof.

The said station 110 + 63 is located at the N. W. Cor. of Sec. 16, T. 48 N. R. 29 W. and from said station the said center line runs in a Southerly direction the said distance of 2627 feet to said station 136 + 90.

Said strip of land contains 1.81 acres of which 0.07 acres is new land, from grantors herein, and 1.74 acres is old land lying in the present public road. The said strip of land lying, being and situated in the N.E. $\frac{1}{4}$ of the Sec. 17, T. 48 N. R. 29 W.

Also a strip of land 5 feet wide and 200 feet long lying adjacent to the Westerly side of the above mentioned 30 foot strip and included between stations 117 + 00 and 119 + 00.

Said strip contains 0.02 acres.

Also a strip of land 5 feet wide and 1190 feet long lying adjacent to the Westerly side of the above mentioned 30 foot strip and included between stations 127 + 00 and 136 + 90.

Said strip contains 0.27 acres.

Tract 15 - Jackson County Recorder of Deeds, Book 670 Page 598 as recorded:

A strip of land 10 feet in width and 200 feet in length, the Easterly boundary of which is a line 30 feet West of and parallel to the center line of the highway from Oak Grove to U.S. Highway #50 and known as the Outer Belt road as located and laid out by the Jackson County Highway Engineering Department and included between station 115 + 00 and station 117 + 00 of the survey thereof.

The said station 115 + 00 is located at a point which is 436.8 feet South of the Northeast corner Section 17, Township 48 North, Range 29 West.

From said station 115 + 00 the said center line runs in a southerly direction the said distance of 200 feet to said station 117 + 00.

Said station 117 + 00 is located at a point which is 636.8 feet South of the Northeast corner said Section 17.

Said strip of land contains 0.05 acres, more or less. lying, being and situated in Northeast quarter Section 17, Township 48 North, Range 29 West.

Tract 16 - Jackson County Recorder of Deeds, Book 555 Page 100 as recorded:

A strip of land 30 feet in width and 660 feet in length the Easterly boundary of which is the center line of the County Highway from Oak Grove to Sni Mills as located and laid out by the Jackson County Highway Engineering Department, an included between station 37 + 78 and 44 + 38 of the survey thereof.

This said station 37 + 38 is located at a point 665 feet more or less South of the N.W. Cor. of the S.W. 1/4 of Sec. 4. T. 48 N. R. 29 W. and from said station the said center line runs in a Southerly direction the said distance of 660 feet to said station 44 + 38.

Said strip of land contains 0.46 acres of which 0.05 acres is new land from grantors herein, and 0.41 acres is old land lying in the present public road. The said strip of land lying, being and situated in the S.E. 1/4 of Se. 5. T. 48 N. R.29 W.

TO HAVE AND TO HOLD THE SAME, with all and singular rights, immunities, privileges, and appurtenances thereunto belonging, unto the said party of the second part, their heirs and assigns forever.

IN WITNESS WHEREOF, the said party of the first part has hereunto set its hand and seal the day and year first written above.

JACKSON COUNTY, MISSOURI

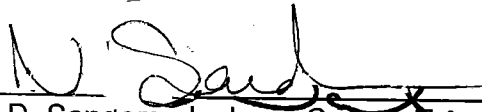
BY: 
Michael D. Sanders, Jackson County Executive

APPROVED AS TO FORM:

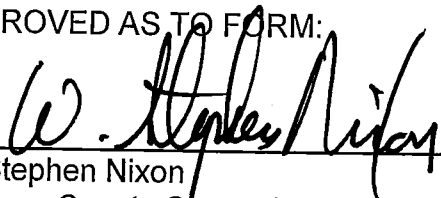
BY: 
W. Stephen Nixon
Jackson County Counselor

ATTEST:

BY: 
Mary Jo Spiro
Clerk of the Jackson County Legislature



AGREEMENT FOR THE SELECTION
SUPPLEMENTARY STATE HIGHWAYS

IN accordance with the terms of Proposition No. 3 amending Article IV, Section 44a of the Constitution of Missouri, providing that supplementary state highways shall be selected by mutual agreement of the State Highway Commission and the proper local authorities, and found at page 453 of the Laws of Missouri, 1929.

IT IS HEREBY AGREED, by and between the State Highway Commission of Missouri and the County ~~Highway~~ Court of Jackson County, Missouri, that the following described roads are hereby selected as a part of the supplementary state highway system:

ROUTE M:- From Route 40 at intersection with Route V, thence north to Route 24 in Independence. (Holland Road, SE - Approximately 4.0 Miles).

ROUTE P:- From Route 40 north of Oak Grove south to Route 30. (County Route 24-E, approximately 10 miles).

ROUTE H:- From Route 40 north of Oak Grove, north to Route 24. (County Route 24-E, approximately 5.5 miles).

* ROUTE J:- Beginning at intersection of Routes 15-S and 1-N, thence in a westerly direction to Kansas State Line. (Approx. 1 Mile).

IT IS FURTHER AGREED that the Assistant Chief Engineer of the State Highway Department is hereby made the agent of both parties hereto with full power to lay out in detail the above roadways or roads and to make detailed surveys, plans and specifications therefor, and no further approval of same by the undersigned county Court ~~other than that herein given~~, shall be deemed necessary.

IT IS FURTHER AGREED, that the said county ~~highway~~ Court shall secure, or cause to be secured, the necessary rights-of-way, according to the plans and surveys hereinabove mentioned, free of cost to the said State Highway Commission, and the said State Highway Commission shall survey, improve, and construct all or parts of these roads as money becomes available for supplementary state highway construction in - - Jackson - - - County, and shall maintain that portion of the said roads so improved or constructed.

(over)

* It is hereby agreed that this route is not to be built until Kansas constructs Optional Route 30 to Miss and Kansas line to connect with the route.

IT IS FURTHER AGREED, that if the said county Court ~~Commissioner~~ shall, within six months after being furnished blank deeds by the State Highway Commission, fail to secure any portion of the said rights-of-way on the roads above described, this agreement may, as to all or any part of the said roads, at the discretion of and upon written notice by the said State Highway Commission to the county Court ~~Commissioner~~ be inoperative.

WHEREFORE, on this 15 day of Nov, 1937, the parties hereto have executed this agreement in triplicate.

STATE HIGHWAY COMMISSION OF MISSOURI

~~COMMISSIONER~~
JACKSON COUNTY COURT.

[Signature]
Vice-Chairman 11-30-37

[Signature]
~~Commissioner~~
Secretary

ATTEST: [Signature]
Secretary

[Signature]
Member

APPROVED: [Signature]
Assistant Chief Engineer 11-30-37

[Signature]
Member

[Signature]
Division Engineer.

Member

I, the undersigned Clerk of the County Court hereby certify that the above and foregoing is a full, true and complete copy of a certain resolution and order, made and entered of record by the County Court of Jackson County, Missouri, on the 15 day of Nov, 1937, as the same appears of record in my office.

IN WITNESS WHEREOF, I have hereunto set my hand this 15 day of Nov, 1937.

Approved
Nov. 15. 1937
[Signature]
Clerk of County Court

(Signed) [Signature]
By Howard S. Neenan, D.C.
Clerk of County Court of Jackson
County, Missouri.

NOV 15 1937
DIVISION NO. 3

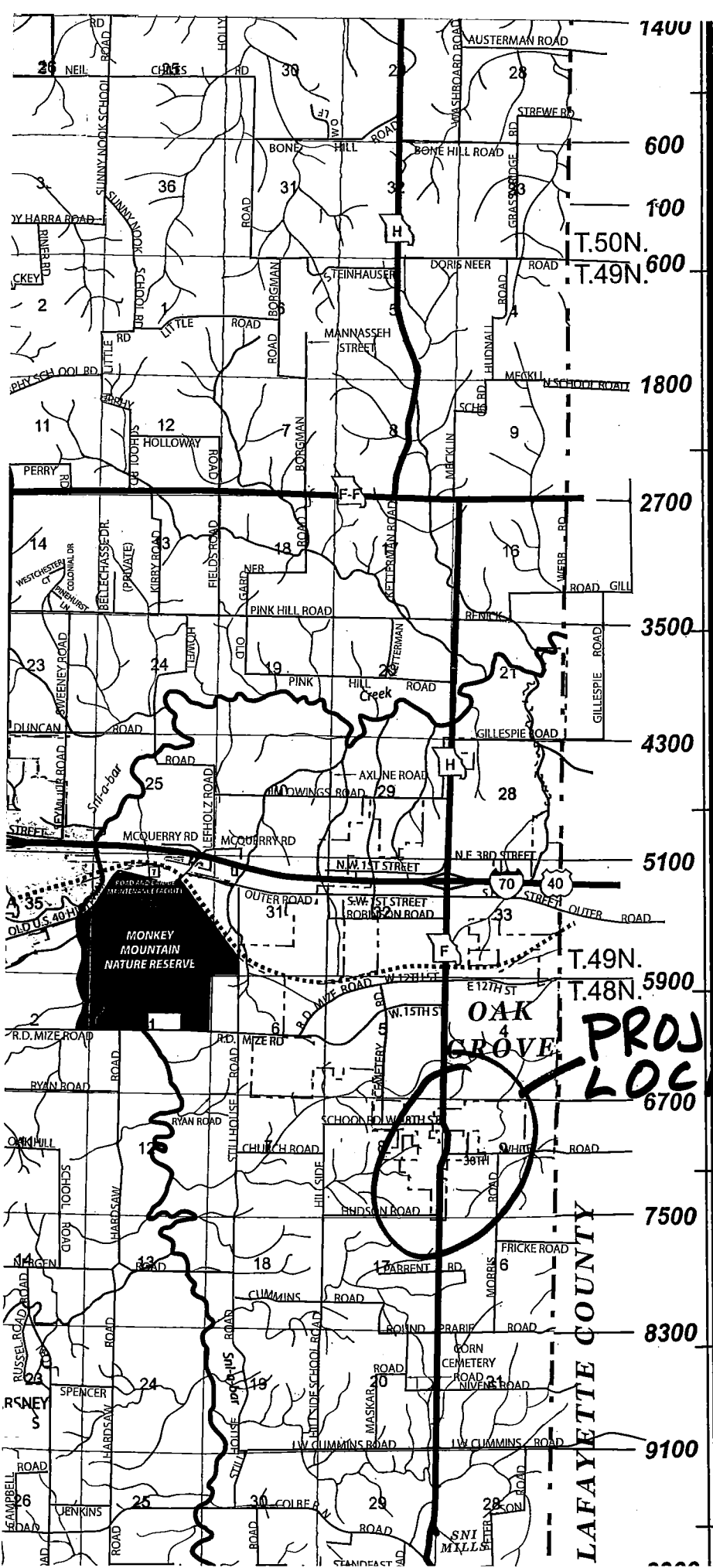

BOYD ROAD.....	7.P-7.R
BONE HILL ROAD.....	7.P-7.R
BORGMAN ROAD.....	7.P-7.R
BOSWELL ROAD.....	19.Q-19.R
BOTEN ROAD.....	14.K
BOWLIN ROAD.....	12.I-11.K
BRIZENDINE ROAD.....	11.M
BROWN ROAD.....	15.O-17.C
BROWNING ROAD.....	18.J-18.K
BUCKNER - TARSNEY ROAD.....	4.O-17.N
BURGESS ROAD.....	7.N-7.O
BURNLEY ROAD.....	4.N-7.N
BURRIS ROAD.....	11.K-12.K
BYNUM ROAD.....	16.P-20.F
BYNUM "SPUR" ROAD.....	17.P
CAMPBELL ROAD.....	14.O-15.O
CARTMILL ROAD.....	8.O
CASEY ROAD.....	18.P-18.C
CASS COUNTY LINE ROAD.....	19.L-19.C
CAVE ROAD.....	16.P
CHILES ROAD.....	5.N
CHILES ROAD.....	12.M
CHURCH ROAD.....	13.P
CLARK ROAD.....	12.L
CLINE ROAD.....	16.Q
COGSWELL ROAD.....	5.Q
COLBERN ROAD.....	14.H-15.
COLBERN ROAD EXT.....	15.R
COLONIAL DRIVE.....	10.O
COOK ROAD.....	12.M-13.
CORN ROAD.....	13.O-15.
CORN ROAD "SPUR".....	15.O
CORN CEMETERY ROAD.....	14.Q
COUNTRYSIDE ROAD.....	11.K
COURTNEY ROAD.....	6.G-5.H
COURTNEY - ATHERTON ROAD.....	5.H-3.K
COWHERD ROAD.....	14.K-14.
CRYSTAL AIRE COURT.....	9.N
CRYSTAL AIRE DRIVE.....	9.N
CUMMINS ROAD.....	13.P-13
CURTIS ROAD.....	4.K
CYCLONE LANE.....	14.K
CYCLONE SCHOOL ROAD.....	14.K
DANELL LANE.....	13.N
DIECKMAN ROAD.....	5.Q-6.C
DILLINGHAM ROAD.....	9.N-10.
DORIS NEER ROAD.....	8.Q-8.F
DOUGLAS ROAD.....	5.M
DRINKWATER ROAD.....	16.O
DUNCAN ROAD.....	10.L-10.C
EAGLE CREST DRIVE.....	17.M
EASY STREET.....	10.N
EASLEY DRIVE.....	16.M
EASLEY ROAD.....	16.M-1
EAST PARK ROAD (FLEMING PARK).....	13.K
EATON ROAD.....	4.J
ECKLES ROAD.....	4.M
ELSEA SMITH ROAD.....	4.M-6.I
ENOCHS MILLS ROAD.....	13.N
FAULKENBERRY ROAD.....	16.P-1
FIELDS ROAD.....	9.P
FLYNN ROAD.....	8.L-8.A
FRICKE ROAD.....	13.R
FRISTOE ROAD.....	13.O
GALVIN ROAD.....	3.N-4.
GARDNER ROAD.....	9.P-9.
GIBSON ROAD.....	15.O-:
GILLESPIE ROAD.....	10.R-:
GRAHAM RIDGE.....	12.M
GRASSY RIDGE ROAD.....	7.R
GRAYUM ROAD.....	16.Q
GREEN RIDGE DRIVE.....	18.K
HAINES ROAD.....	18.K
HAMILTON ROAD.....	19.N
HAMMOND ROAD.....	15.N-
HANNA ROAD.....	6.N-6
HAPPY HOLLOW ROAD.....	4.K-4
HARDSAW ROAD.....	12.O-
HARRIS ROAD.....	17.L-
HARRIS - POTTS ROAD.....	14.M-
HEDGECOCK ROAD.....	19.M
HEIDELBERGER ROAD.....	7.M-i
HELMIG ROAD.....	16.P-
HENDRICKS ROAD.....	18.P-
HERRING ROAD.....	17.L-
HERTZOG LANE.....	15.K
HILLSIDE SCHOOL ROAD.....	12.Q
HINES ROAD.....	6.I
HOLLOWAY ROAD.....	9.P
HOLLY ROAD.....	6.P
HOLLY ROAD.....	5.M

PROJECT LOCATION

LAFAYETTE COUNTY