

# REQUEST FOR LEGISLATIVE ACTION

Completed by County Counselor's Office:

Res/Ord No.: 18522

Sponsor(s): James D. Tindall

Date: May 19, 2014

SUBJECT	<p>Action Requested  <input checked="" type="checkbox"/> Resolution  <input type="checkbox"/> Ordinance</p> <p>Project/Title: <u>Authorizing the purchase of Dispatch Furniture for use by the Sheriff's Office from Watson Furniture of Poulsbo, WA under the terms and conditions of MARC (Mid-America Regional Council)/HGAC (Houston Galveston Area Council) Contract No. EC07-11, an existing government contract.</u></p>										
<p>BUDGET INFORMATION  <i>To be completed By Requesting Department and Finance</i></p>	<table border="1" data-bbox="324 556 1453 751"> <tr> <td>Amount authorized by this legislation this fiscal year:</td> <td>\$83,983.38</td> </tr> <tr> <td>Amount previously authorized this fiscal year:</td> <td></td> </tr> <tr> <td>Total amount authorized after this legislative action:</td> <td>\$83,983.38</td> </tr> <tr> <td>Amount budgeted for this item * (including transfers):</td> <td></td> </tr> <tr> <td>Source of funding (name of fund) and account code number: 010-4245-58150 – Grant Fund, Sheriff's EOC, Capital Furniture</td> <td>\$83,983.38</td> </tr> </table> <p>* If account includes additional funds for other expenses, total budgeted in the account is: \$</p> <p>OTHER FINANCIAL INFORMATION:  <input type="checkbox"/> No budget impact (no fiscal note required)  <input type="checkbox"/> Term and Supply Contract (funds approved in the annual budget); estimated value and use of contract:          Department: _____ Estimated Use: \$ _____</p> <p>Prior Year Budget (if applicable): N/A          Prior Year Actual Amount Spent (if applicable): N/A</p>	Amount authorized by this legislation this fiscal year:	\$83,983.38	Amount previously authorized this fiscal year:		Total amount authorized after this legislative action:	\$83,983.38	Amount budgeted for this item * (including transfers):		Source of funding (name of fund) and account code number: 010-4245-58150 – Grant Fund, Sheriff's EOC, Capital Furniture	\$83,983.38
Amount authorized by this legislation this fiscal year:	\$83,983.38										
Amount previously authorized this fiscal year:											
Total amount authorized after this legislative action:	\$83,983.38										
Amount budgeted for this item * (including transfers):											
Source of funding (name of fund) and account code number: 010-4245-58150 – Grant Fund, Sheriff's EOC, Capital Furniture	\$83,983.38										
PRIOR LEGISLATION	<p>Prior ordinances and (date):          Prior resolutions and (date):</p>										
CONTACT INFORMATION	<p>RLA drafted by (name, title, &amp; phone): Barbara Casamento, Purchasing Supervisor, 881-3253</p>										
REQUEST SUMMARY	<p>The Sheriff's Office would like to purchase Dispatch Furniture for the new EOC Dispatch area at the new office building @ 4001 NE Lakewood Way, Lee's Summit, Missouri 64064. This equipment is being purchased with the EOC grant funds received by the Sheriff's Office.</p> <p>Pursuant to Section 1030.4 of the Jackson County Code, the Director of Finance and Purchasing recommends the purchase of Dispatch Furniture for use by the Sheriff's Office from Watson Furniture of Poulsbo, WA under the terms and conditions of the MARC/HGAC Contract No. EC07-11, an existing government contract, in the amount of \$83,983.38.</p> <p>The Director of Finance and Purchasing recommends the purchase be made under this contract due to the higher volume discounts offered to larger government entities and/or buying groups.</p>										
CLEARANCE	<p><input type="checkbox"/> Tax Clearance Completed (Purchasing &amp; Department) N/A  <input type="checkbox"/> Business License Verified (Purchasing &amp; Department) N/A  <input checked="" type="checkbox"/> Chapter 6 Compliance - Affirmative Action/Prevailing Wage (County Auditor's Office)</p>										
ATTACHMENTS	<p>A copy of a Memorandum from Captain Dave Epperson of the Sheriff's Office, Watson Furniture's quote and the HGAC Agreement.</p>										
REVIEW	<table border="1" data-bbox="316 1680 1542 1911"> <tr> <td>Department Director:</td> <td>Date: 5/19/2014</td> </tr> <tr> <td>Finance (Budget Approval): <i>If applicable</i> <i>Barbara S Ball</i></td> <td>Date: 5-17-14</td> </tr> <tr> <td>Division Manager:</td> <td>Date:</td> </tr> <tr> <td>County Counselor's Office:</td> <td>Date:</td> </tr> </table>	Department Director:	Date: 5/19/2014	Finance (Budget Approval): <i>If applicable</i> <i>Barbara S Ball</i>	Date: 5-17-14	Division Manager:	Date:	County Counselor's Office:	Date:		
Department Director:	Date: 5/19/2014										
Finance (Budget Approval): <i>If applicable</i> <i>Barbara S Ball</i>	Date: 5-17-14										
Division Manager:	Date:										
County Counselor's Office:	Date:										

Fiscal Information (to be verified by Budget Office in Finance Department)

- This expenditure was included in the annual budget.
- Funds for this were encumbered from the \_\_\_\_\_ Fund in \_\_\_\_\_.
- There is a balance otherwise unencumbered to the credit of the appropriation to which the expenditure is chargeable and there is a cash balance otherwise unencumbered in the treasury to the credit of the fund from which payment is to be made each sufficient to provide for the obligation herein authorized.
- Funds sufficient for this expenditure will be/were appropriated by Ordinance # \_\_\_\_\_
- Funds sufficient for this appropriation are available from the source indicated below.

Account Number:	Account Title:	Amount Not to Exceed:

- This award is made on a need basis and does not obligate Jackson County to pay any specific amount. The availability of funds for specific purchases will, of necessity, be determined as each using agency places its order.
- This legislative action does not impact the County financially and does not require Finance/Budget approval.

**Fiscal Note:**

This expenditure was included in the Annual Budget.

PC# \_\_\_\_\_

Date: May 12, 2014

~~ORD~~/RES # 18522

<u>Department / Division</u>	<u>Character/Description</u>	<u>Not to Exceed</u>
<b>010 - Grant Fund</b>		
4245 - Sheriff's EOC	58150 - Office Furniture & Fixtures	83,984
Total		83,984

*Alexander S Ball 5-12-14*  
Budgeting

**OFFICE OF JACKSON COUNTY, MISSOURI**  
***SHERIFF***  
**INTER-OFFICE MEMORANDUM**

**TO:** Barbara Casamento (Jackson County Purchasing)

**FROM:** Captain Dave Epperson

**DATE:** 04/07/2014

**SUBJECT:** Request for furniture from Watson Company for new Sheriff's Building

Barbara,

I am sending you this memorandum to request Watson Furniture as the vendor for office equipment at the new Jackson County Sheriff's building, 4001 NE Lakewood Way Lees Summit, Missouri 64064.

Captain Royce Richberg and Sergeant Doug Caster selected the above company as a source of new furniture for the Emergency Operations Center/ Communications unit. The equipment will include consoles, lighting and doors as listed in the attached quotation through Project# jacksoncommo.13.

The funding should be removed from Jackson County Sheriff's account#58150 office furniture and fixtures in Fund 010 grant fund.

*Cpt D. Epperson #17*



## QUOTATION

**Quote #:** Q.F01-JacksonCOMO.13  
**Date:** 3/26/2014  
**Valid Until:** 5/26/2014  
**Contract:** HGAC #EC07-11

### Prepared By:

Kelly Dowling  
 Project Coordinator  
 Watson  
 26246 Twelve Trees Lane NW  
 Poulsbo, WA 98370  
 360-394-1316  
 kdowling@watsonfurniture.com

### Rep:

Dick Buss  
 Territory Rep  
 Dick Buss & Associates LLC  
 WI

**NET 30 DAYS**

### Prepared For:

Doug Caster  
 Jackson County Sheriff  
 3310 NE Rennau Road  
 Lee's Summit, MO 64063  
 816-5245-4302  
 dcaster@jacksongov.org

### Ship To:

Doug Caster  
 Jackson County Sheriff  
 3310 NE Rennau Road  
 Lee's Summit, MO 64063  
 816-5245-4302  
 dcaster@jacksongov.org

### Project: JacksonCOMO.13

INSTALLATION BASED ON EMPTY ROOM, ONE TRIP, BASEMENT FLOOR WITH NO PREVAILING WAGE OR UNION REQUIREMENTS.  
 HGAC Contract Pricing - Freight Included.

Part Number	Qty	Purchase	Ext Purchase
<b>F01 - Jackson County Sheriff</b>			
<b>Item 1. (4) Synergy 3 2436 90° Full Lift Consoles</b>			
<b>QOD18</b> SYNERGY OUTSIDE DOOR, 18" WIDE	4	\$84.53	\$338.12
POWDER ...			Skipped Option
<b>QOD24</b> SYNERGY OUTSIDE DOOR, 24" WIDE	4	\$94.50	\$378.00
POWDER ...			Skipped Option
<b>QOD36</b> SYNERGY OUTSIDE DOOR, 36" WIDE	4	\$114.45	\$457.80
POWDER ...			Skipped Option
<b>QEFCC54L</b> SYNERGY 3 FULL LIFT END CAP (POWER PRIMARY), COMBO PANEL, 54" HIGH, LEFT HAND	2	\$531.30	\$1,062.60

Part Number			Qty	Purchase	Ext Purchase
PARTITION	...	Skipped Option			
EDGE FINISH	...	Skipped Option			
POWDER	...	Skipped Option			
FABRIC	...	Skipped Option			
<b>QEFCC54R</b>			2	\$531.30	\$1,062.60
SYNERGY 3 FULL LIFT END CAP (POWER PRIMARY), COMBO PANEL, 54" HIGH, RIGHT HAND					
PARTITION	...	Skipped Option			
EDGE FINISH	...	Skipped Option			
POWDER	...	Skipped Option			
FABRIC	...	Skipped Option			
<b>QEFBRS4266C54</b>			2	\$1,836.98	\$3,673.96
SYNERGY 3 FULL LIFT BRIDGE (POWER PRIMARY), SINGLE, 42" DEEP x 66" WIDE, COMBO PANEL, 54" HIGH					
WORKSURFACE	...	Skipped Option			
PARTITION	...	Skipped Option			
EDGE FINISH	...	Skipped Option			
POWDER	...	Skipped Option			
FABRIC	...	Skipped Option			
<b>QEFPPS2436C54</b>			4	\$7,217.18	\$28,868.72
SYNERGY 3 FULL LIFT POWER PRIMARY, SINGLE, 24" DEEP x 36" WIDE, COMBO PANEL, 54" HIGH					
MULTIPOINT	X	No Multiport			
TCS	X	No TCS			
WORKSURFACE	...	Skipped Option			
PARTITION	...	Skipped Option			
EDGE FINISH	...	Skipped Option			
POWDER	...	Skipped Option			
FABRIC	...	Skipped Option			
					<b>\$35,841.80</b>

## Item 2. Storage & Accessories

<b>TXXCL</b>			4	\$39.38	\$157.52
INSIDE CAVITY LIGHT					
<b>QCS24PS</b>			8	\$56.18	\$449.44
SYNERGY CAVITY SHELF, 24" WIDE, ADD-ON, PULL-OUT, COMMON - SURFACE & EDGE: Black					

Part Number	Qty	Purchase	Ext Purchase
<b>QCS30PS</b> SYNERGY CAVITY SHELF, 30" WIDE, ADD-ON, PULL-OUT, COMMON - SURFACE & EDGE: Black	2	\$61.95	\$123.90
<b>QCS36PS</b> SYNERGY CAVITY SHELF, 36" WIDE, ADD-ON, PULL-OUT, COMMON - SURFACE & EDGE: Black	2	\$67.73	\$135.46
<b>TXXDAYTON</b> 4" DAYTON FAN (INCLUDES HARDWARE)	4	\$109.73	\$438.92
<b>TXXTECHLNK</b> SYNERGY TECH LINK - POWDER: Black	4	\$309.75	\$1,239.00
<b>TXXICMAS</b> SENSOR, ACTIVITY - TOTAL COMFORT SYSTEM ACTIVITY SENSOR FOR TOTAL COMFORT SYSTEM	4	\$133.35	\$533.40
<b>TXXICMHMAT</b> HEATER, MAT - TOTAL COMFORT SYSTEM HEATER MAT FOR TOTAL COMFORT SYSTEM	2	\$180.60	\$361.20
<b>TXXDLB</b> LED LIGHT, BLACK (TRILLIUM) [FOR FUSION/SYNERGY] WITH ONE-PIECE CLAMP	4	\$345.98	\$1,383.92
<b>QDAA4</b> SYNERGY DEPTH ADJUSTMENT ARRAY 4 ea. UP TO 21" MONITORS	4	\$1,123.50	\$4,494.00
<b>TXXTCSKTH</b> SYNERGY TOTAL COMFORT SYSTEM, HEIGHT ADJUSTABLE PACKAGE, WITH TWO MOBILE (FILTERED) AIR CIRCULATION FANS	4	\$2,097.38	\$8,389.52
<b>TRN30X</b> ROTATING RESOURCE, 30" DIAMETER, NO GROMMET	2	\$758.63	\$1,517.26
CASE FINISH ... Skipped Option			
<b>ZSPEPBF201526M</b> ZO STORAGE PEDESTAL, PENCIL, BOX, FILE, 20"D x 15"W x 26"H, MOBILE	4	\$558.08	\$2,232.32
LOCK L Locking (Factory)			

Part Number			Qty	Purchase	Ext Purchase
PULL	K	Jota Pull (Black)			
CONTRASTING	C	Contrasting			
CONTRASTING	...	Skipped Option			
GROUP	...				
CASE FINISH	...	Skipped Option			
					<b>\$21,455.86</b>

**Item 3. Installation**

<b>DNI</b>			1	\$21,909.00	\$21,909.00
INSTALLATION CHARGE					

**\$21,909.00**

**Sub Total: \$79,206.66**

**Grand Total: \$79,206.66**

Approved By: \_\_\_\_\_  
Name

Date: \_\_\_\_\_

\_\_\_\_\_

Title

PO: \_\_\_\_\_

1. State and Local Taxes will apply unless proof of exemption is provided with the Purchase Order.
2. Deposit may be required with order; Net 30 days of Shipment of Product.
3. Chairs are for representational purposes only.
4. Lead time 45-60 days after receipt of Purchase Order issued to Watson Furniture Group.
5. Completed Order consist of signed Contract or Purchase Order, Signed Drawings, Signed Color Selection Sheet, and Deposit.
6. Change Order Fee (minimum \$500) may be applicable after 5 business days of Complete Order submission.
7. Re-Scheduled Delivery & Installation requires 4 week notification.
8. There will be a \$500 (Net per order) Finish Configuration Fee added IF a color scheme is chosen outside of the eight (8) standard color schemes.
9. Pricing will be valid for four (4) months after receipt of Purchase Order any orders that have not been manufactured within this time frame will be subject to a price change.





## QUOTATION

**Quote #:** Q.F02-JacksonCOMO.13  
**Date:** 3/26/2014  
**Valid Until:** 5/26/2014  
**Contract:** HGAC DESKING CONTRACT

### Prepared By:

Kelly Dowling  
 Project Coordinator  
 Watson  
 26246 Twelve Trees Lane NW  
 Poulsbo, WA 98370  
 360-394-1316  
 kdowling@watsonfurniture.com

### Rep:

Dick Buss  
 Territory Rep  
 Dick Buss & Associates LLC  
 WI

**NET 30 DAYS**

### Prepared For:

Doug Caster  
 Jackson County Sheriff  
 3310 NE Rennau Road  
 Lee's Summit, MO 64063  
 816-5245-4302  
 dcaster@jacksongov.org

### Ship To:

Doug Caster  
 Jackson County Sheriff  
 3310 NE Rennau Road  
 Lee's Summit, MO 64063  
 816-5245-4302  
 dcaster@jacksongov.org

### Project: F02 - JacksonCOMO.13

INSTALLATION BASED ON EMPTY ROOM, ONE TRIP, BASEMENT FLOOR WITH NO PREVAILING WAGE OR UNION REQUIREMENTS.  
 HGAC Contract Pricing - Freight and installation included

Part Number	Qty	Purchase	Ext Purchase
<b>F02 - Jackson County Sheriff</b>			
<b>Item 1. Miro Conference Table</b>			
<b>MACTR061529</b>	1	\$441.53	\$441.53
MIRO CONFERENCE, CABLE TOWER, 6"D x 15"W x 29"H			
POWDER	...	Skipped Option	
<b>MCCREC60132-29</b>	1	\$4,335.19	\$4,335.19
 MIRO CONFERENCE RECTANGLE, 60"D x 132"W (2-PIECE TOP) x 29-1/2"H			
END 1 POWER	E53PSB	5 Power, 3 Data, (Plug), Silver / Black	
END 2 POWER	E53PSW	5 Power, 3 Data, (Plug), Silver / White	
LAMINATE 1	...	Skipped Option	
EDGE	M	Miro Edge	
EDGE FINISH	...	Skipped Option	
POWDER	...	Skipped Option	
			<b>\$4,776.72</b>
<b>Sub Total:</b>			<b>\$4,776.72</b>
<b>Grand Total:</b>			<b>\$4,776.72</b>

**Part Number**

**Qty**

**Purchase**

**Ext Purchase**

**Approved By:** \_\_\_\_\_  
**Name**  
\_\_\_\_\_  
**Title**

**Date:** \_\_\_\_\_

**PO:** \_\_\_\_\_

- 
1. State and Local Taxes will apply unless proof of exemption is provided with the Purchase Order.
  2. Deposit may be required with order; Net 30 days of Shipment of Product.
  3. Chairs are for representational purposes only.
  4. Lead time 45-60 days after receipt of Purchase Order issued to Watson Furniture Group.
  5. Completed Order consist of signed Contract or Purchase Order, Signed Drawings, Signed Color Selection Sheet, and Deposit.
  6. Change Order Fee (minimum \$500) may be applicable after 5 business days of Complete Order submission.
  7. Re-Scheduled Delivery & Installation requires 4 week notification.
  8. There will be a \$500 (Net per order) Finish Configuration Fee added IF a color scheme is chosen outside of the eight (8) standard color schemes.
  9. Pricing will be valid for four (4) months after receipt of Purchase Order any orders that have not been manufactured within this time frame will be subject to a price change.

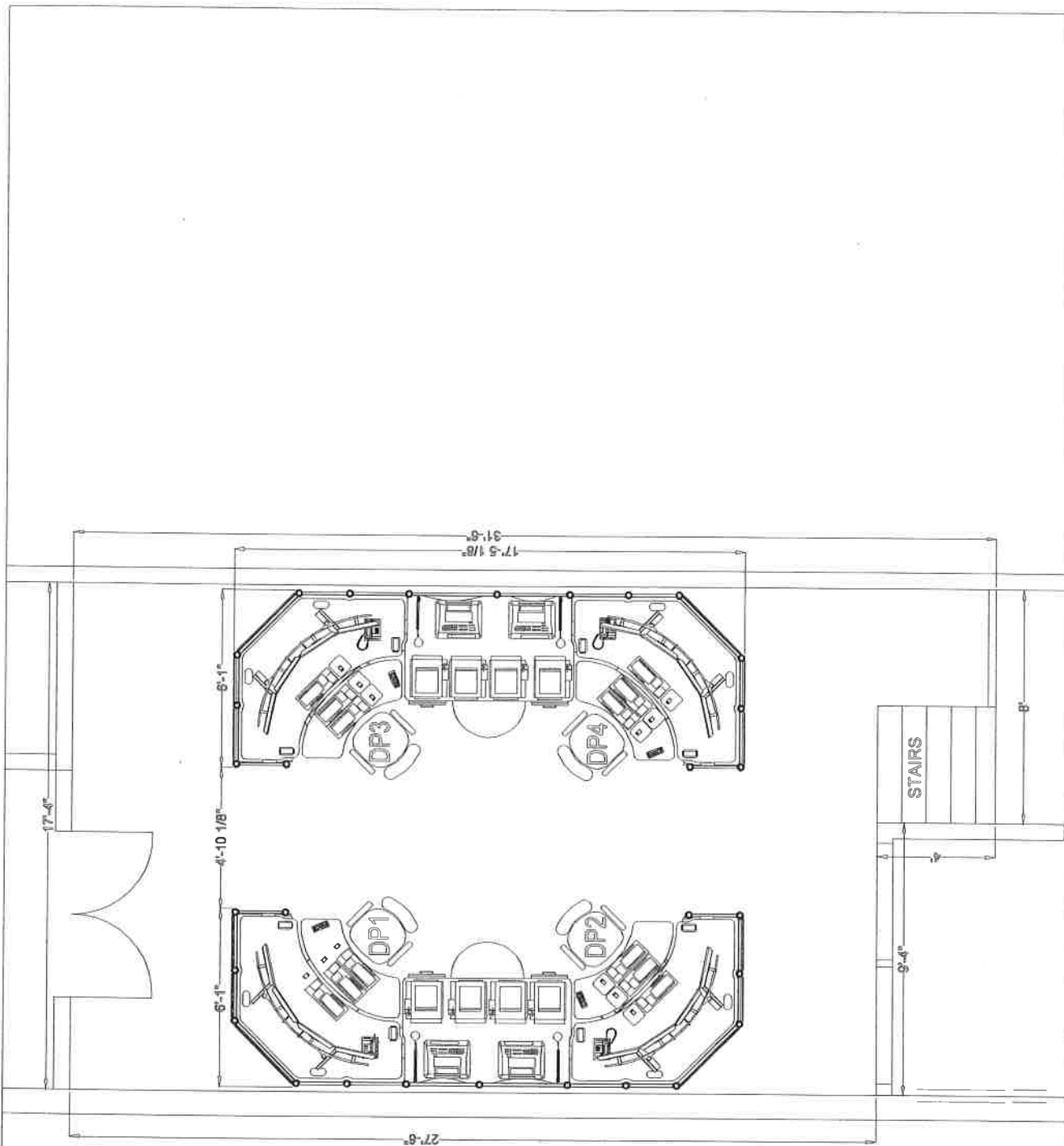

Proprietary material may not be reproduced without written permission by Watson Furniture Group. Field verify all dimensions prior to order. Optional items may be shown that can be purchased at time of order. Watson Furniture Group guarantees our AutoCAD symbols to be correct. Accuracy of building plan dimensions, features, etc. provided to Watson remains the end user's responsibility. PDF may not be to scale.

**F01.0**  
 Scale:  
 3/16" = 1'

Project: Jackson County Sheriff IV  
 Furniture Option: Dwg Name: JacksonCOMO.10  
 Synergy 3 Full Lift Consoles  
 54" Combo Panels - 2436 90° Full Lift Primaries

Location: Lee's Summit, MO  
 PC: KLD Rep Firm/Rep: DBA  
 Drawn By: JTB Date: 03/25/14  
 Approved: \_\_\_\_\_ Date: \_\_\_\_\_

**watson™**  
**CONFIDENTIAL**  
 26246 Twelve Trees Lane  
 Poulisbo, Washington 98370  
 (800) 426-1202

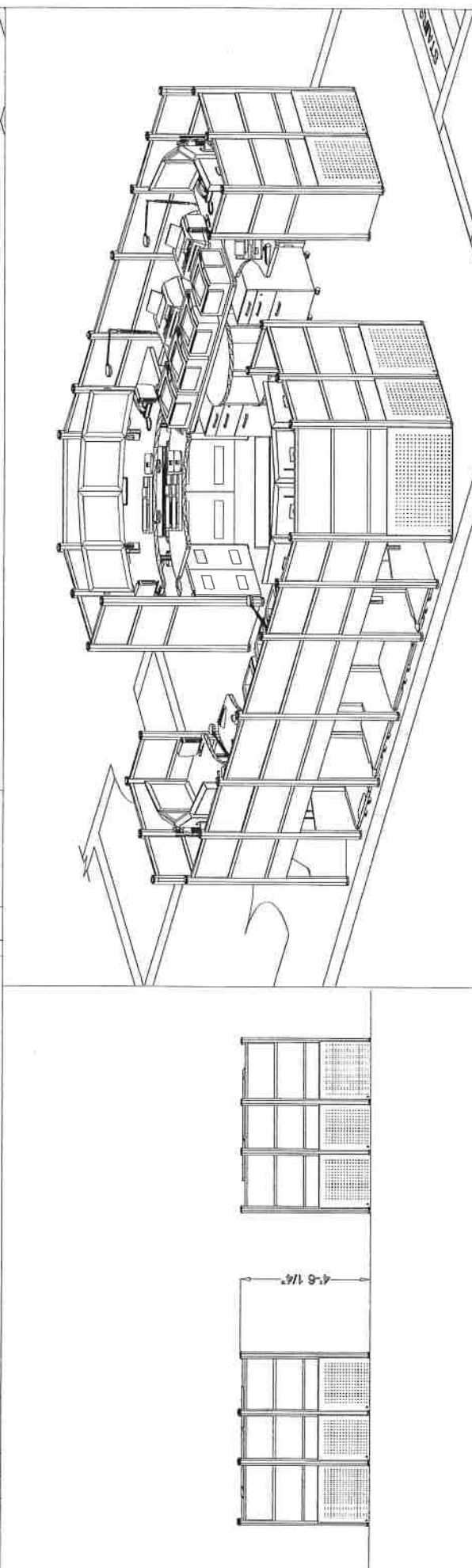
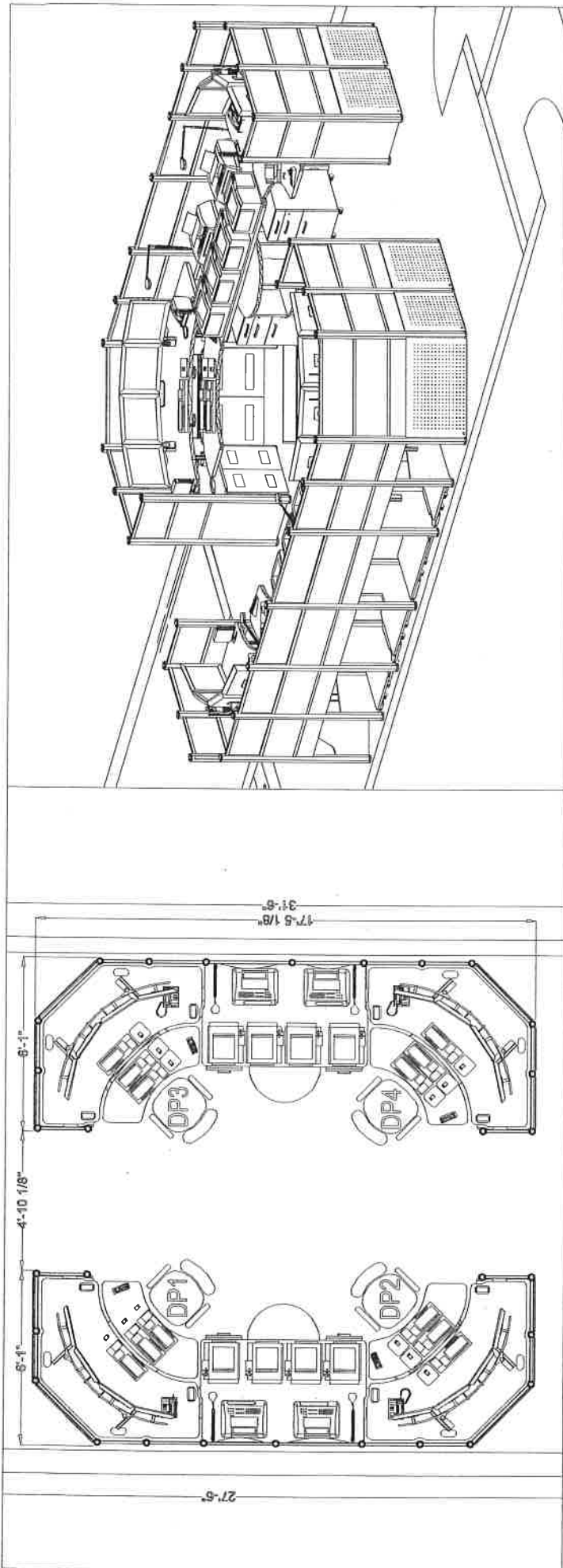

Proprietary material may not be reproduced without written permission by Watson Furniture Group. Field verify all dimensions prior to order. Optional items may be shown that can be purchased at time of order. Watson Furniture Group guarantees our AutoCAD symbols to be correct. Accuracy of building plan dimensions, features, etc. provided to Watson remains the end user's responsibility. PDF may not be to scale.

<p><b>F01.1</b></p> <p>Scale: 3/16" = 1'</p>	<p>Project: Jackson County Sheriff IV          Furniture Option:          Synergy 3 Full Lift Consoles          54" Combo Panels - 2436 90° Primaries</p>	<p>Location: Lee's Summit, MO          PC: KLD Rep Firm/Rep: DBA          Drawn By: JTB Date: 03/25/14          Approved _____ Date _____</p>	<p><b>watson™</b>  <b>CONFIDENTIAL</b>          26246 Twelve Trees Lane          Poulsbo, Washington 98370          (800) 426-1202</p>
--	---	---	--

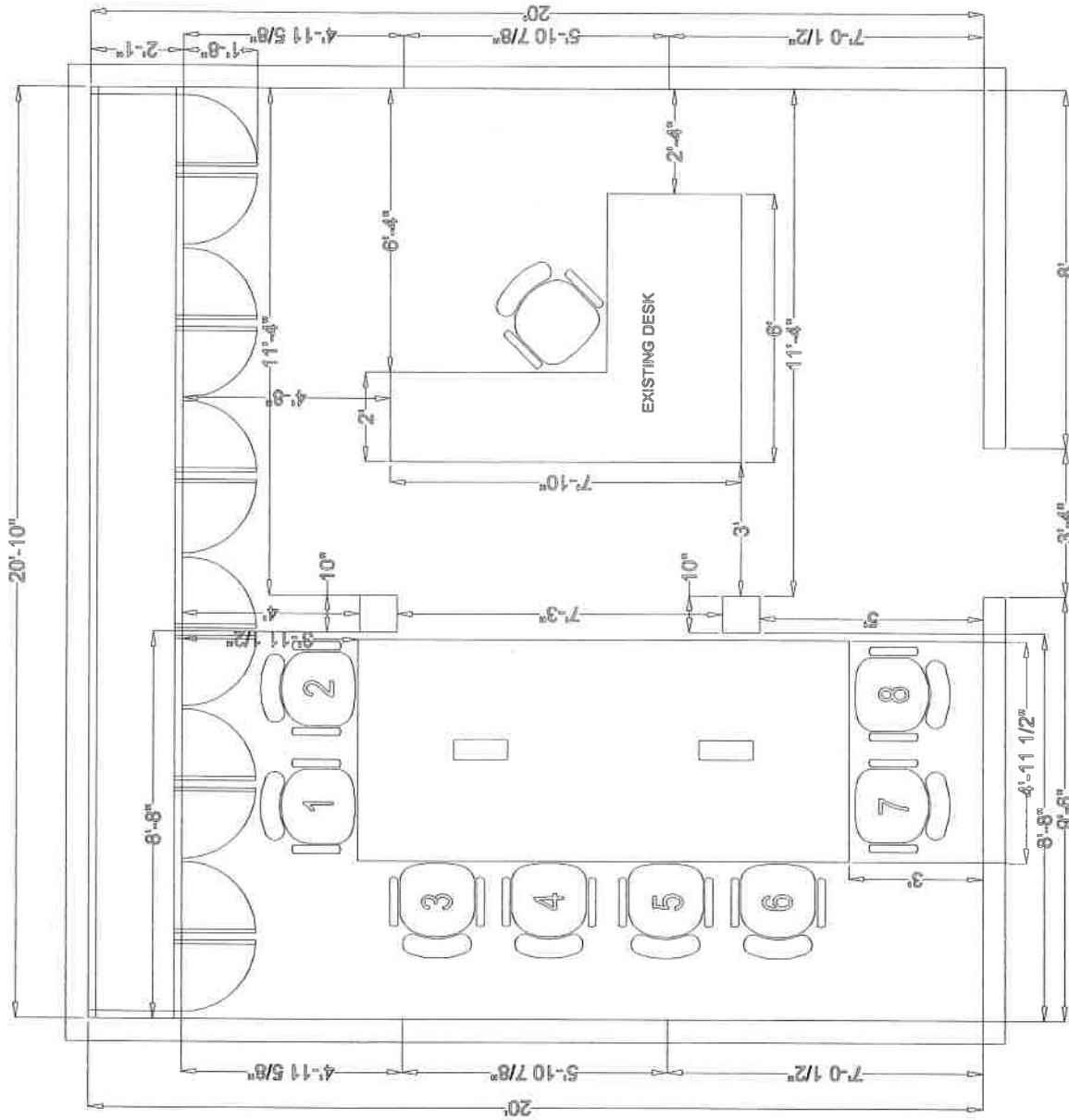

Proprietary material may not be reproduced without written permission by Watson Furniture Group. Field verify all dimensions prior to order. Optional items may be shown that can be purchased at time of order. Watson Furniture Group guarantees our AutoCAD symbols to be correct. Accuracy of building plan dimensions, features, etc. provided to Watson remains the end user's responsibility. PDF may not be to scale.

**F02.0**  
 Scale:  
 1/4" = 1'

Project: Jackson County Sheriff IV  
 Furniture Option: Dwg Name: JacksonCOMOIV.13  
 Micro Conference Table 60144 - Hardwire Power  
 Location: Lee's Summit, MO  
 PC: KLD Rep Firm/Rep: DBA  
 Drawn By: JTB Date: 03/25/14  
 Approved \_\_\_\_\_ Date \_\_\_\_\_

**watson™**  
**CONFIDENTIAL**  
 26246 Twelve Trees Lane  
 Poulisbo, Washington 98370  
 (800) 426-1202

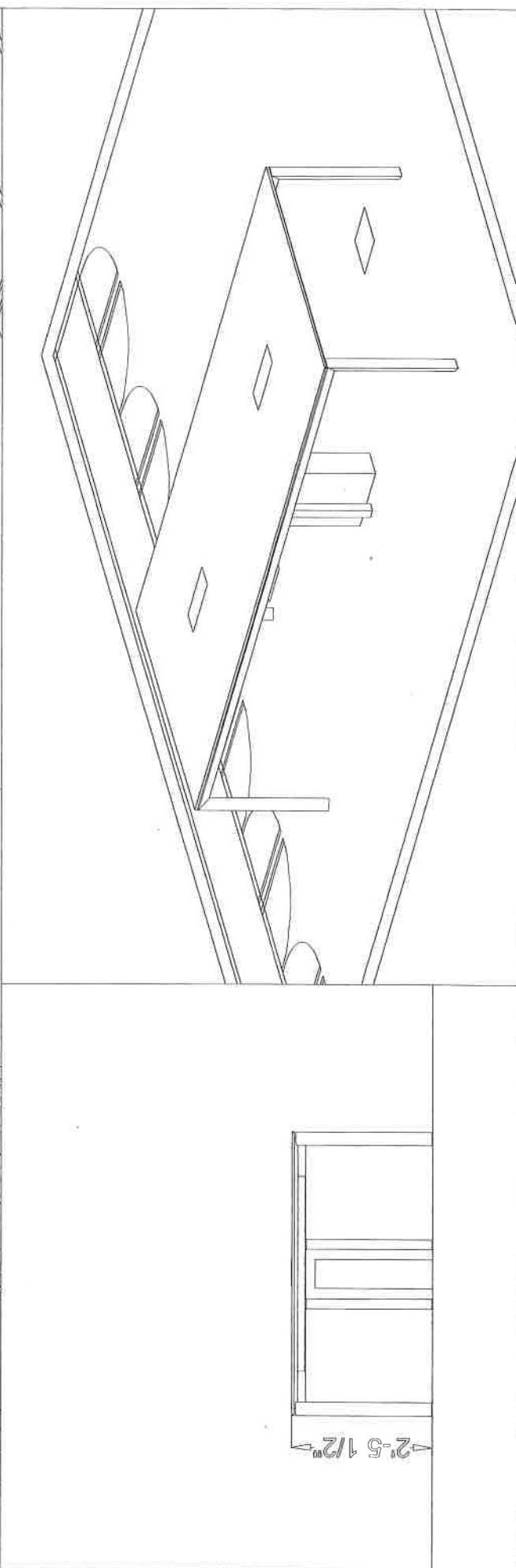
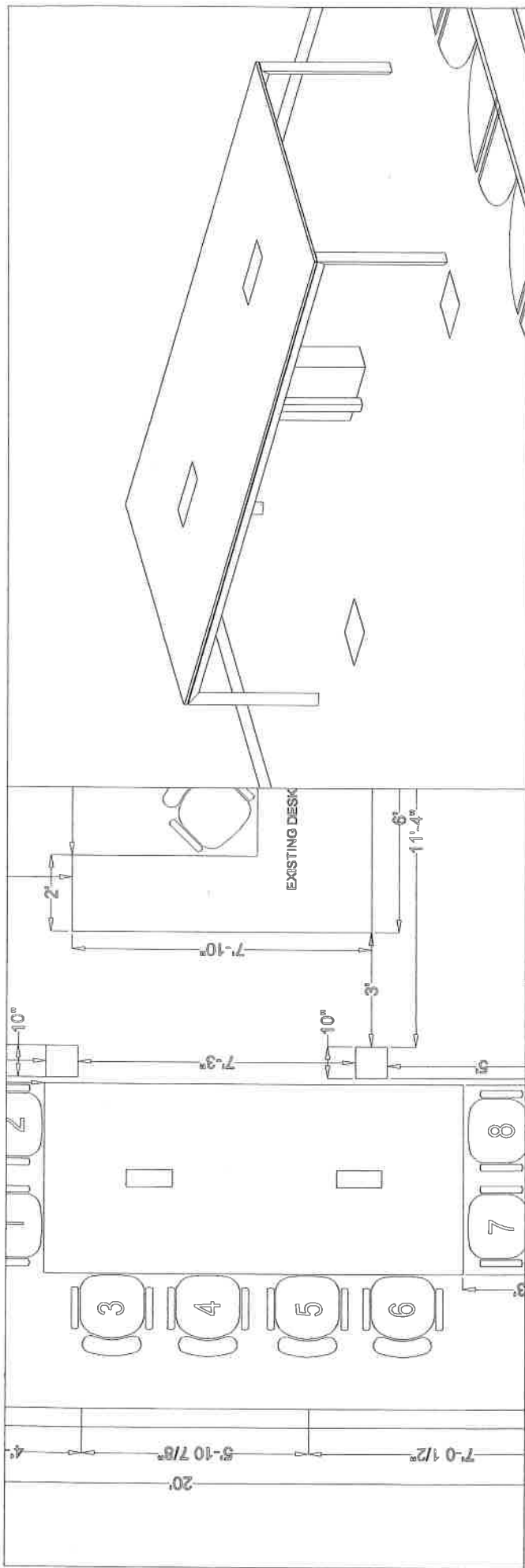

Proprietary material may not be reproduced without written permission by Watson Furniture Group. Field verify all dimensions prior to order. Optional items may be shown that can be purchased at time of order. Watson Furniture Group guarantees our AutoCAD symbols to be correct. Accuracy of building plan dimensions, features, etc. provided to Watson remains the end user's responsibility. PDF may not be to scale.

**F02.1**  
Scale: NTS

Project: Jackson County Sheriff IV  
Furniture Option: Dwg Name: JacksonCOMOIV.13  
Micro Conference Table 60144 - Hardwife Power

Location: Lee's Summit, MO  
PC: KLD Rep Firm/Rep: DBA  
Drawn By: JTB Date: 03/25/14  
Approved \_\_\_\_\_ Date \_\_\_\_\_

**watson™**  
**CONFIDENTIAL**  
26246 Twelve Trees Lane  
Poulsbo, Washington 98370  
(800) 426-1202



**CONTRACT PRICING WORKSHEET**  
For Catalog & Price Sheet Type Purchases

**Contract No.:**

**EC07-11**

**Date Prepared:**

**3/26/2014**

*This Worksheet is prepared by Contractor and given to End User. If a PO is issued, both documents **MUST** be faxed to H-GAC @ 713-993-4548. Therefore please type or print legibly.*

<b>Buying Agency:</b>	Jackson County Sheriff (MARC / KCRPC)	<b>Contractor:</b>	Watson Furniture Group, Inc. dba Watson Dispatch
<b>Contact Person:</b>	Rita Parker	<b>Prepared By:</b>	Kelly Dowling
<b>Phone:</b>	816-246-5083	<b>Phone:</b>	(800) 426-1202
<b>Fax:</b>	816-421-7758	<b>Fax:</b>	(360) 394-1322
<b>Email:</b>	rita.parker@kcrpc.com	<b>Email:</b>	kdowling@watsonfurniture.com

<b>Catalog / Price Sheet Name:</b>	Watson Dispatch Consoles
<b>General Description of Product:</b>	911 Console Furniture

**A. Catalog / Price Sheet Items being purchased - Itemize Below - Attach Additional Sheet If Necessary**

Quan	Description	Unit Pr	Total
SEE ATTACHED - 2 QUOTES			
			<b>Subtotal A:</b>
			\$ 83,983.38

**B. Unpublished Options, Accessory or Service items - Itemize Below - Attach Additional Sheet If Necessary**

(Note: Unpublished Items are any which were not submitted and priced in contractor's bid.)

Quan	Description	Unit Pr	Total
SEE ATTACHED			
			<b>Total From Other Sheets, If Any:</b>
			<b>Subtotal B:</b>
			\$ -
<b>Check:</b> The total cost of Unpublished Options (Subtotal B) cannot exceed 25% of the total from Section A.		<b>For this transaction the percentage is:</b>	0%

**C. Other Allowances, Discounts, Trade-Ins, Freight, Make Ready or Miscellaneous Charges**

SEE ATTACHED			
			<b>Subtotal C:</b>
			\$ -

<b>Delivery Date:</b>	TBD	<b>D. Total Purchase Price (A+B+C):</b>	\$ 83,983.38
-----------------------	-----	---	--------------